

PART NUMBER	CENTER PIN / JACK SIZE	MATING POWER PLUG
L712AS	0.10 (2.5 mm)	761KS12, 761KS15, 761KS17
L722AS	0.08 (2.0 mm)	S761KS12, S761KS15, S761KS17 767KS12, 767KS15, 767KS17

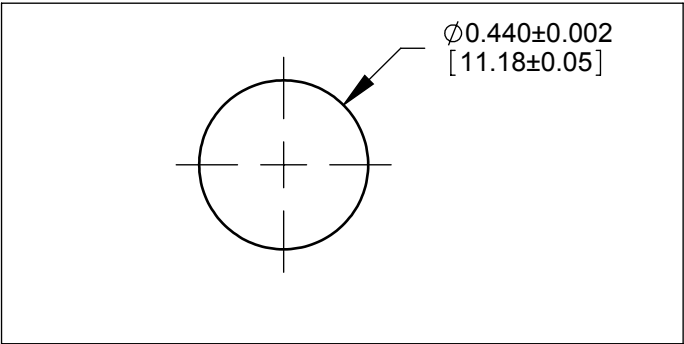
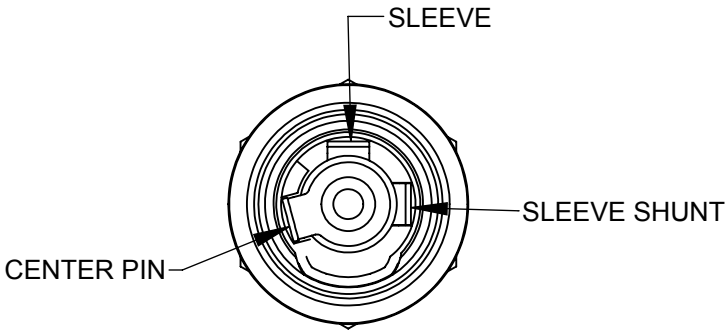
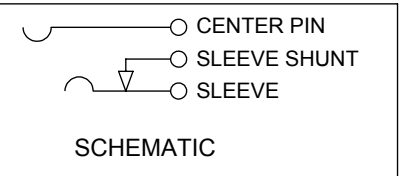

RECOMMENDED PANEL MTG HOLE

- NOTES:
- DIMENSIONS SHOWN FOR REFERENCE ONLY.
  - HEX NUT, FLAT WASHER, AND PANEL O-RING SUPPLIED UNASSEMBLED
  - MATERIAL:  
HOUSINGS, HEX NUT - COPPER ALLOY, NICKEL PLATED  
INSULATOR HOUSING - THERMOPLASTIC  
O-RINGS - NEOPRENE RUBBER, LUBRICATED WITH SYNTHETIC GREASE  
TERMINAL INSULATORS - PHENOLIC  
FLAT WASHER - STEEL, NICKEL PLATED  
PIN, SPRING, TERMINALS - COPPER ALLOY, SILVER PLATED
  - THIS PRODUCT IS RoHS COMPLIANT

CUSTOMER DRAWING

					<div>UNLESS OTHERWISE SPECIFIED</div> <div>1. ALL DIMENSIONS IN INCHES</div> <div>- TWO PLACE DECIMALS    ±0.02</div> <div>- THREE PLACE DECIMALS   ±0.005</div>	THIS DRAWING DESCRIBES A DESIGN CONSIDERED PROPRIETARY IN NATURE, DEVELOPED AND MANUFACTURED BY SWITCHCRAFT INC. AND IS RELEASED ON A CONFIDENTIAL BASIS FOR IDENTIFICATION PURPOSES ONLY.											
						SIZE	WIDTH		MULT		LBS/M		TEMPER				
						FINISH						MATERIAL					
						SPEC No.						SPEC No.					
						FIRST USED ON				SCALE 2:1		<div>Switchcraft®</div>					
						DATE DRAWN	BY	CHKD		APVD							
B	27029	10/01/12	AB	TJK													
A	26591	8/6/10	RS	TJK													
REV	ECO NUMBER	DATE	BY	APVD													
REVISIONS					DO NOT SCALE DRAWING	NAME				SEALED POWER JACKS SOLDER LUG, RoHS				PART No.		REV	
														L712AS, L722AS		B	