

## Solid State Relay Accessory Protection Cover

- Apply for KSI, KSJ single phase
- Dimension: 57.5 \* 44.6 \* 24 mm
- Weight: 9.3 g

### Product Selection

**KPC**

KPC  
Series

**-0**

0:Single Phase Type

**A**

Series  
Number

### KPC-0A (mm)

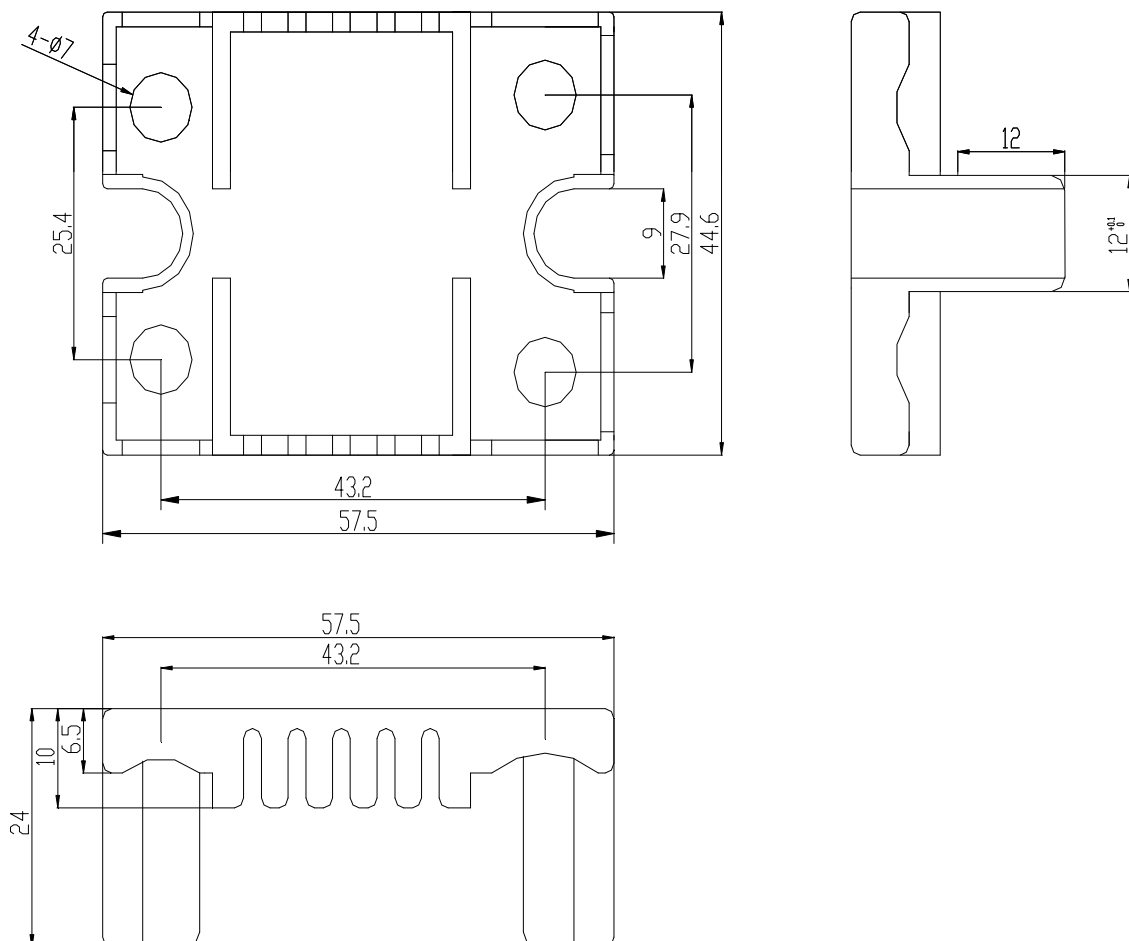

**SONG CHUAN EUROPE GmbH**

Im Petersfeld 5

D-65624 Altendiez

Phone: +49 6432 8006 90

Fax: + 49 6432 8006 50

[info@songchuan.eu](mailto:info@songchuan.eu)

[www.songchuan.eu](http://www.songchuan.eu)

This product is a supplementary product for the European market and only available through Song Chuan Europe. It is manufactured by Kudom Electronics Technology, China.