

CONTACT POINT  
DEFLECTED STATE

	0.23	A	B	C
---	------	---	---	---

SEE TABLE, SHEET 2, FOR  
CONTACT LOADING PATTERN

DETAIL A  
SCALE 40:1

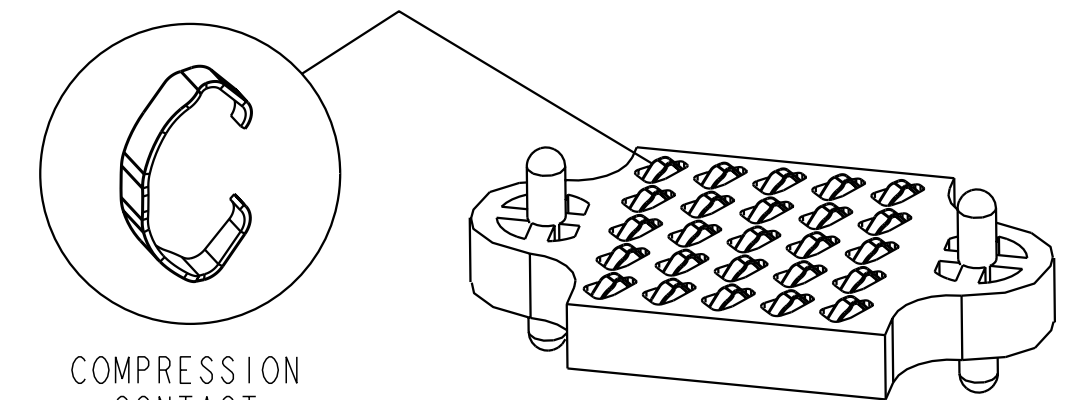

SCALE 8:1  
10032207-0025AA SHOWN

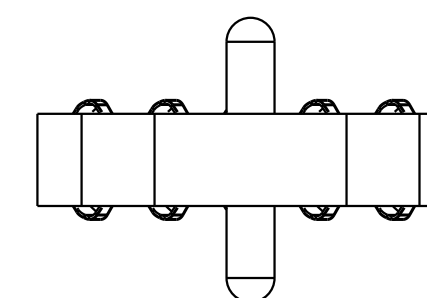
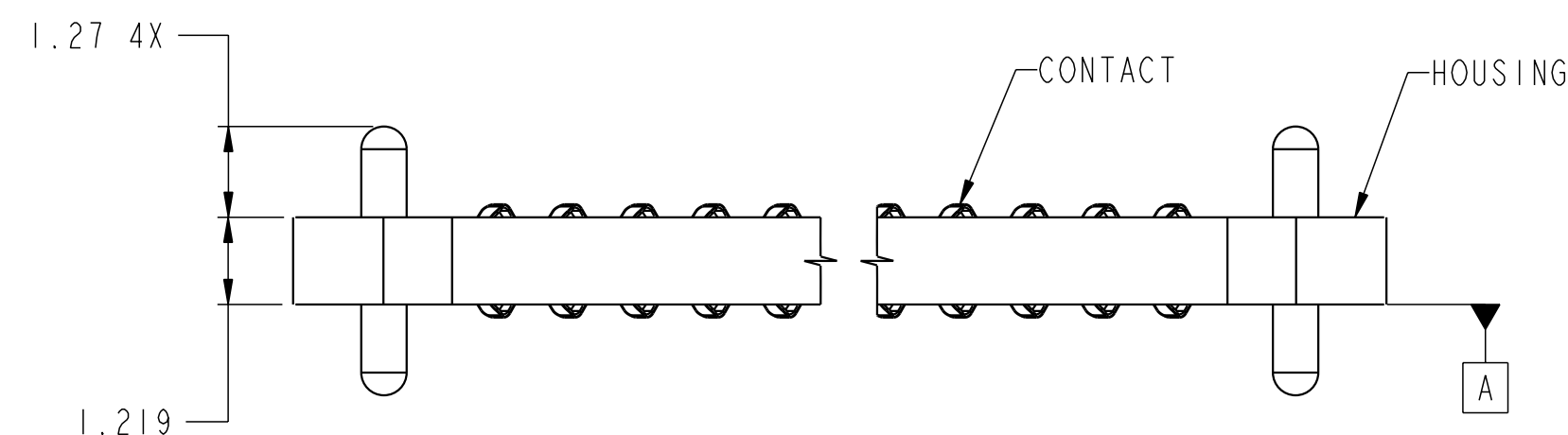
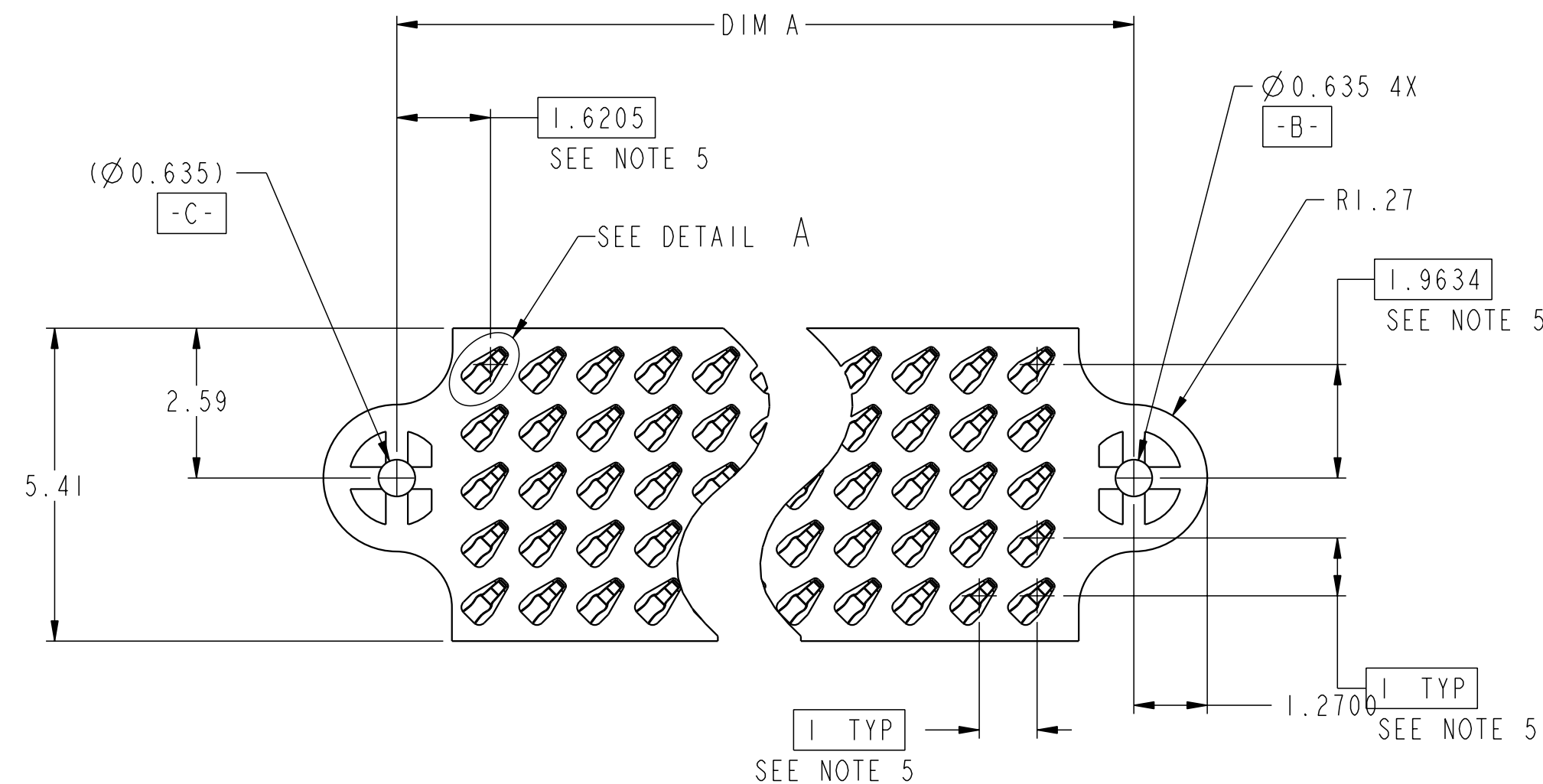

Tous droits strictement réservés. Reproduction ou communication à des tiers  
interdite sans que l'auteur ait été préalablement autorisé par écrit du propriétaire.  
Property of FCI. Droits de reproduction réservés.

FCI

E

All rights strictly reserved. Reproduction or issue to third parties in any  
form whatsoever is not permitted without written authority from the proprietor.  
Property of FCI. Copyright FCI.

1		2		3	4	5	6	7	8
PART NUMBER		NUMBER OF CONTACTS LOADED	DIM A	DIM B	DIM C	CONTACT LOADING CONFIGURATION			
A	10032207-0025AA	25	7.29	4.00	9.83				
	10032207-0050AA	50	12.29	9.00	14.83				
B	10032207-0075AA	75	17.30	14.00	19.84				
	10032207-0100AA	100	22.30	19.00	24.84				

NOTES:

- MATERIAL:  
CONTACT: BERYLLIUM COPPER  
HOUSING: LIQUID CRYSTAL POLYMER,  
UL 94V-0, COLOR - BLACK
- CONTACT FINISH: 0.76µm GOLD OVER 0.76µm MIN NICKEL
- PRODUCT SPECIFICATION: GS-12-258
- APPLICATION SPECIFICATION: GS-20-038
- DIMENSION IS TO CONTACT POINT, DEFLECTED STATE.

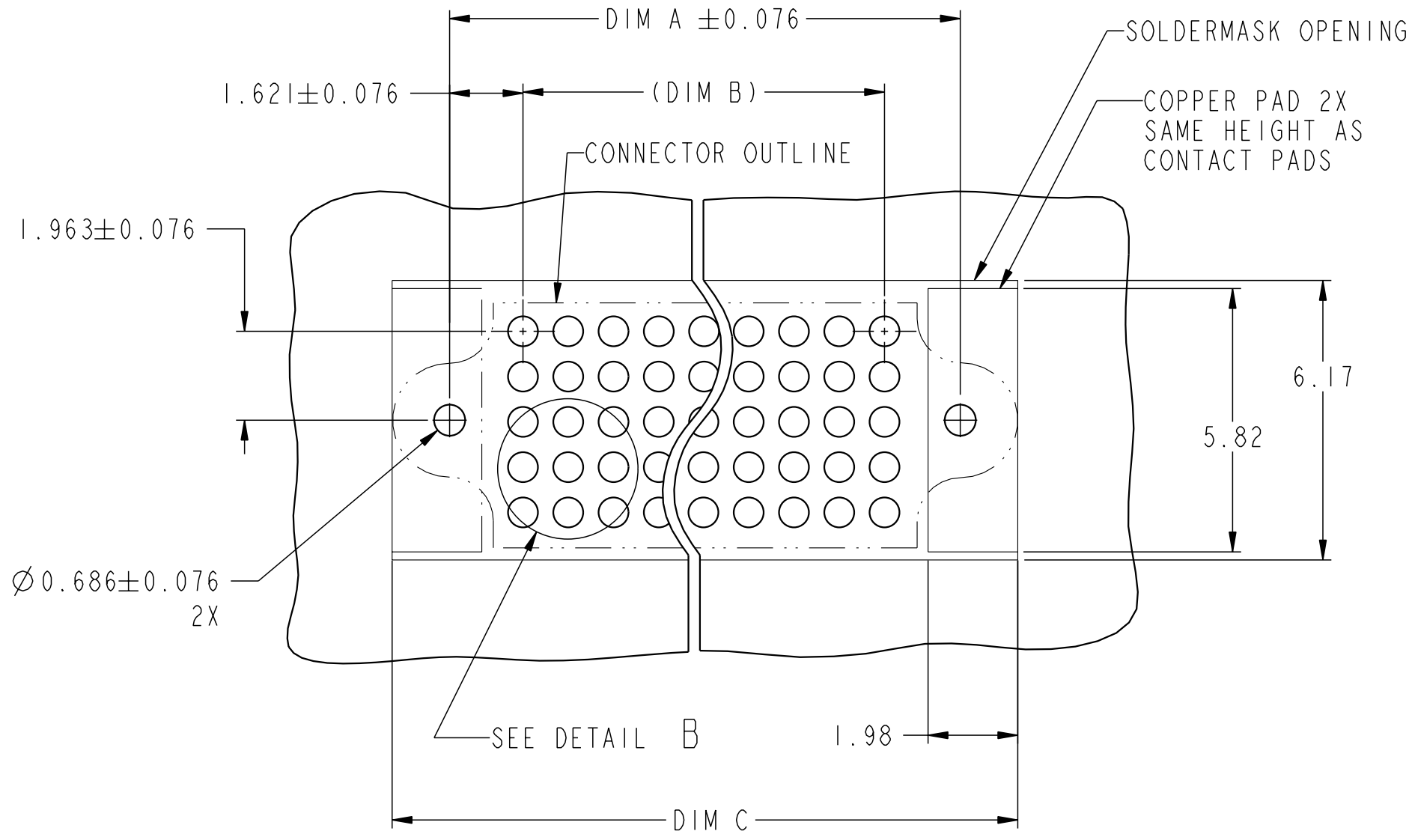

SCALE 8:1  
RECOMMENDED PC BOARD LAYOUT

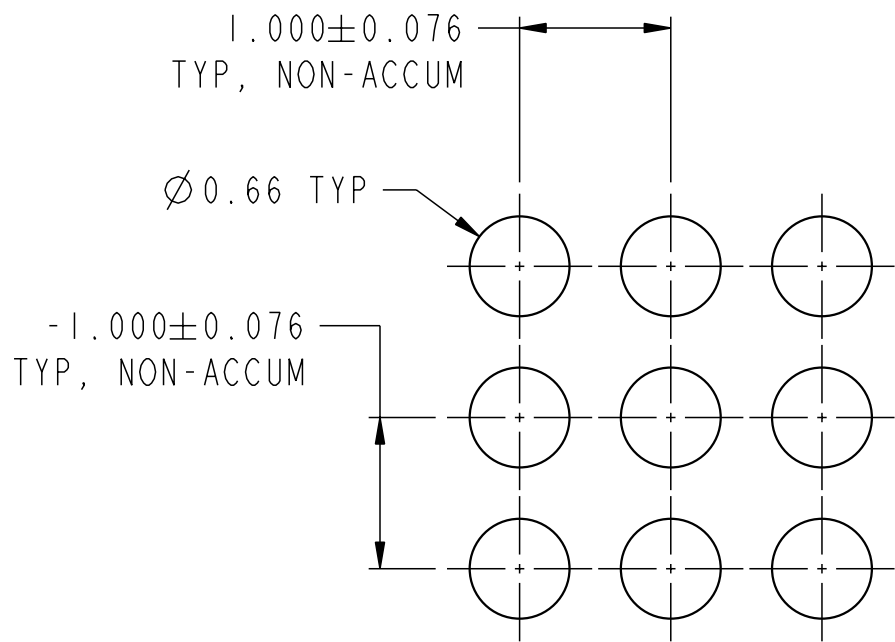

DETAIL B  
SCALE 20:1  
PRIMARY CONTACT PADS

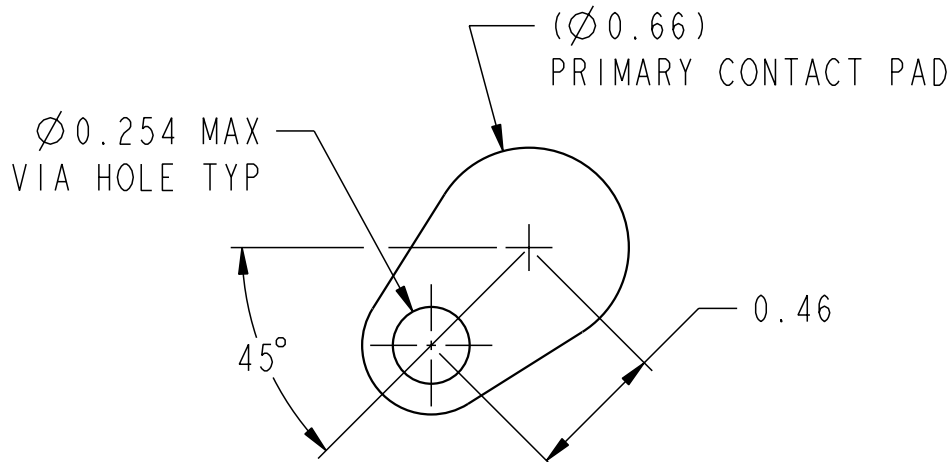

SCALE 40:1  
RECOMMENDED GEOMETRY:  
VIA LOCATED OFF PRIMARY CONTACT PAD

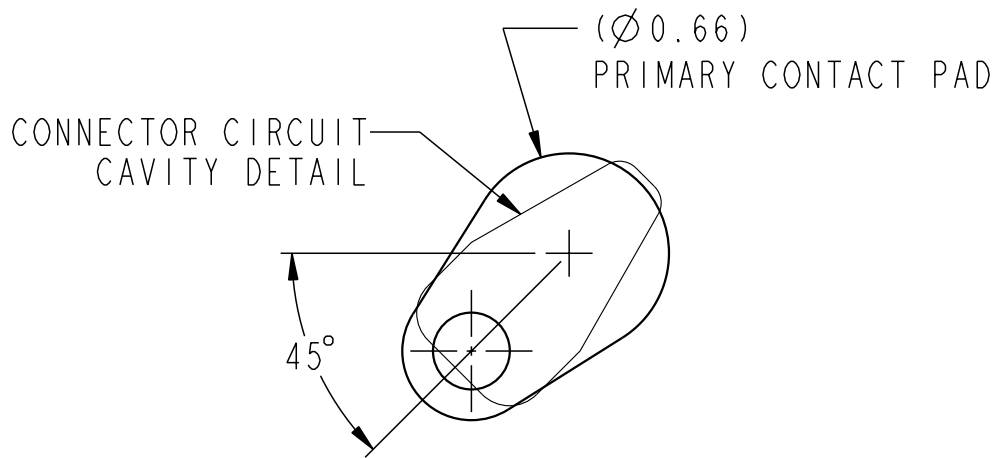

SCALE 40:1  
PAD ORIENTATION IS DETERMINED  
BY CONNECTOR ORIENTATION

title STACKING INTERPOSER, 1mm SPACING		cat no 10032207	Rev. A
customer		sheet 2 of 2	