

Dimensions: mm (in)

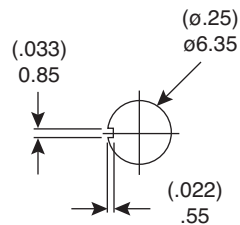

Without locking ring

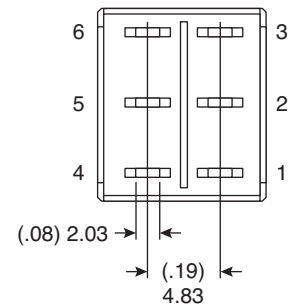
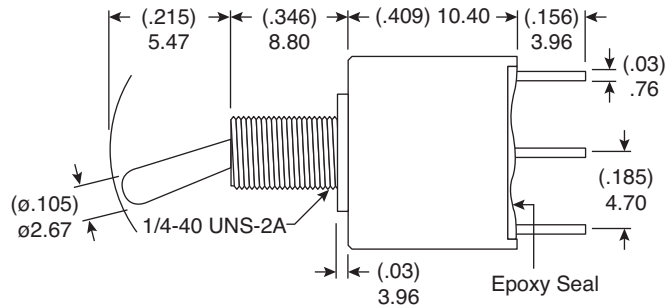
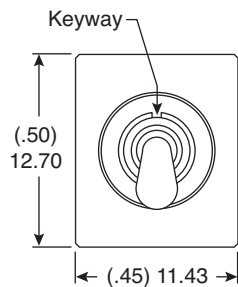
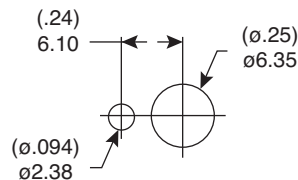

With standard locking ring

PANEL MOUNTING

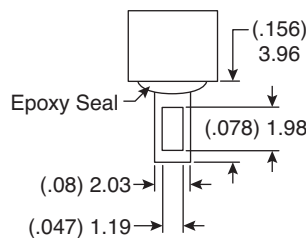

SOLDER LUG

Pos. 1	Pos. 2	Pos. 3
ON	OFF	(ON)
2-3, 5-6		2-1, 5-4

SWITCH FUNCTION

Electrical Specifications:

- Contact Resistance: 10m Ω max. initial @ 2-4 VDC 100mA
- Insulation Resistance: 1,000M Ω min.
- Dielectric Strength: 1,000 V RMS @ sea level
- Rating: 2A/250VAC
5A/120VAC or 28VDC

Mechanical Specifications:

- Mechanical Life: 30,000 make-and-break cycles
- Operating Temperature: -30°C to 85°C

Note:

- RoHS Compliant
By Exemption

Soldering Process:

- Manual Soldering: Use a soldering iron of 30 watts, controlled at 350°C approximately 5 sec. while applying Solder.
- Wave Soldering: Recommended soldering temperature: 260 \pm 5°C
Duration of solder immersion: 5 \pm 1 sec.
(PCB is 1.6mm in thickness)

Sealed Miniature Toggle Switch

108-1AD5T2192-EVX

Mountain Switch

Mouser Electronics

Authorized Distributor

Click to View Pricing, Inventory, Delivery & Lifecycle Information:

Mountain Switch:

[108-1AD5T2192-EVX](#)