

SPECIFICATIONS

Material: E-SEELS -- Silicone rubber polymer type ASTM D 1418

Mounting Nut: E-SEELS: Brass, black-oxide

Temperature Range: E-SEELS: -80°F to +400°F

Pressure Range: Exceeds 15 psi internal and 1500 psi external.

Operational Life: 50,000 actuations (minimum).

Shelf Life: Excess of 25 years.

Resistant to: Salt spray, sunlight, ozone, weather, fungus, and most acids and lubricating oils

Agency Recognition: UL & ULC Recognized to UL Std. 50

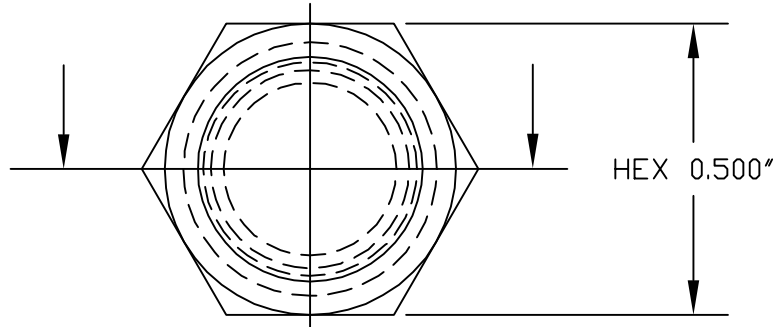

PERMISSIBLE RUBBER
OVERLAY .005 MAX

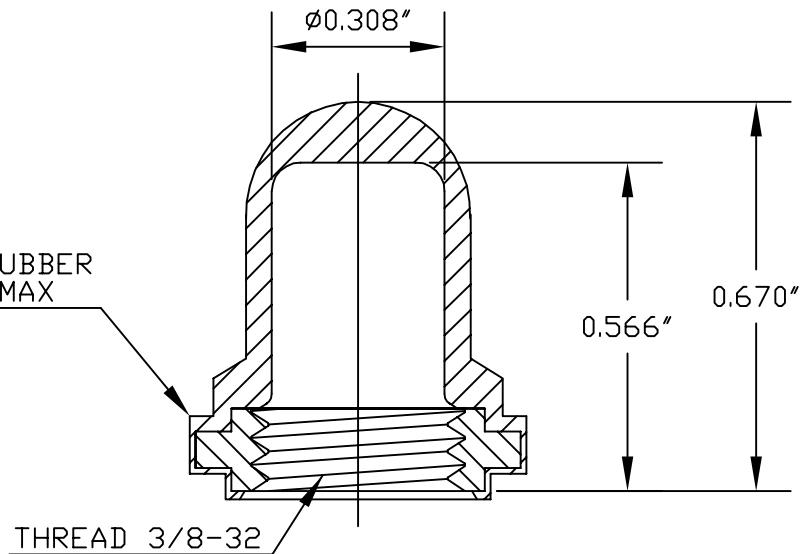

B	UPDATED DIMENSIONS				07.14.08	
A	CAD COMPUTER GENERATED				09.23.02	
REV.	DESCRIPTION				DATE	
MAXIMUM AND MINIMUM MEASUREMENTS ARE STATED DIRECTLY ON EACH DIMENSION.	TITLE:	BOOT, PUSHBUTTON		ENG.	S. GOK	07.14.08
				DWN.	S. GOK	07.14.08
				CHKD.	J. CELLA	07.14.08
MAT'L: SILICONE RUBBER ASTM D 1418		APM-HEXSEAL CORPORATION		SCALE	DWG. NO.	1231/35
FINISH: CLEAR				3 : 1		

THIS DRAWING COVERS PROPRIETARY ITEM AND IS THE PROPERTY OF THE APM-HEXSEAL CORPORATION.
THIS DRAWING IS NOT TO BE COPIED OR USED WITHOUT THE WRITTEN APPROVAL OF AN OFFICER OF THE APM-HEXSEAL CORPORATION.

Mouser Electronics

Authorized Distributor

Click to View Pricing, Inventory, Delivery & Lifecycle Information:

[APM HEXSEAL:](#)

[1231/35](#)