

NH CONNECTOR

Disconnectable Crimp style connectors

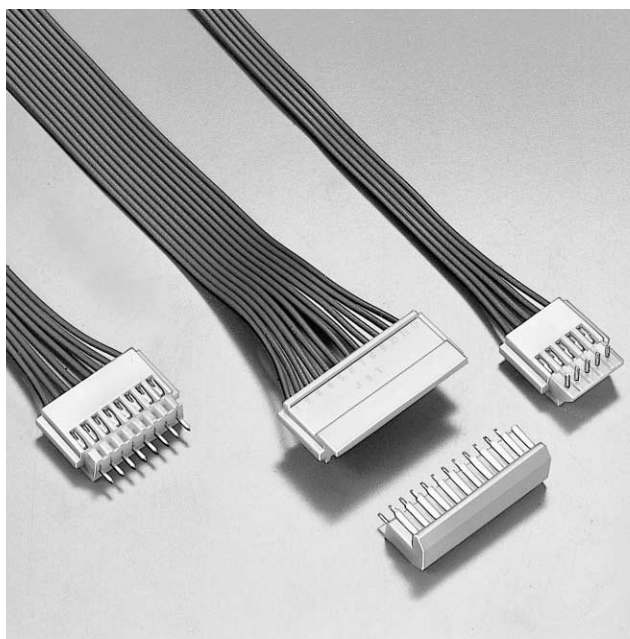

This 2.5mm (.098") pitch connector is used to connect wires to printed circuit boards. The header is available in three configurations : top, side, and bottom entry. This allows the wires to be perpendicular or parallel to the printed circuit board in any direction.

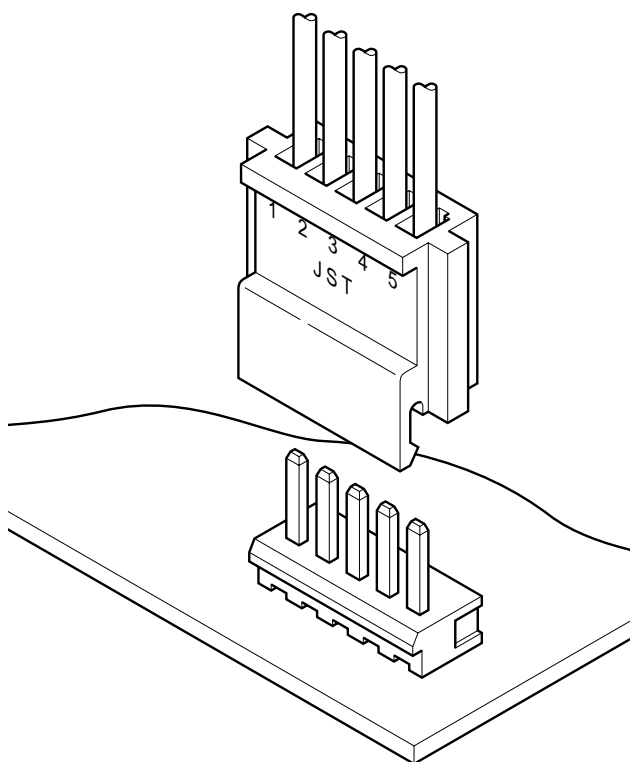

Features

• Superior folded beam construction

- (1) This sturdy construction withstands repeated stress, resists permanent deformation, and offers a very long service life.
- (2) High reliability is ensured whether the contact pressure is high or low.
- (3) This contact design has a large tolerance for variations in mating post thickness and resists deformation when pried.

• Double-sided contact

- (1) The receptacle contact has a protected entry which eliminates contact damage caused by mismating.
- (2) It provides high contact pressure, is free from abnormal stress, and maintains continuity at all times.
- (3) It has an extremely long service life due to its folded beam design.

• Wide, sturdy post

The post has a large cross-sectional area to resist prying during insertion into printed circuit boards and mating with connector housings.

• Molded-in header

The posts are molded into the insulator to provide stability when mounted on printed circuit boards. This also prevents flux from entering the connector during soldering.

Specifications

- Current rating: 3A AC, DC (AWG#22)
- Voltage rating: 250V AC, DC
- Temperature range: -25°C to +85°C
(including temperature rise in applying electrical current)
- Contact resistance: Initial value/15m Ω max.
After environmental testing/20m Ω max.
- Insulation resistance: 500M Ω min.
- Withstanding voltage: 1,500V AC/minute
- Applicable wire: AWG #30 to #22
- Applicable PC board thickness: 1.6mm(.063")
- * Contact JST if Lead-Free product is required.
- * Refer to "General Instruction and Notice when using Terminals and Connectors" at the end of this catalog.
- * Contact JST for details.

Standards

Recognized E60389

Certified LR20812

R75086

NH CONNECTOR

Contact

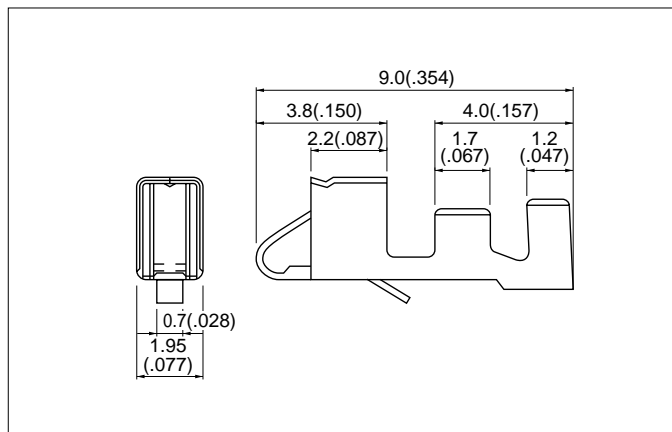

Model No.	Applicable wire			Q'ty / reel
	mm ²	AWG #	Insulation O.D. mm(in.)	
SHF-001T-0.8BS	0.08 to 0.33	28 to 22	1.2 to 1.7 (.047 to .067)	5,000
SHF-002T-0.8BS	0.05 to 0.08	30 to 28	0.9 to 1.2 (.035 to .047)	

Material and Finish

Phosphor bronze, tin-plated

Note:

1. Contact JST if you require gold-plated contacts.
2. Also contact JST if you require shielded wires, thin wires or other special wires.
3. Contact JST if you require contacts made of brass.

Housing

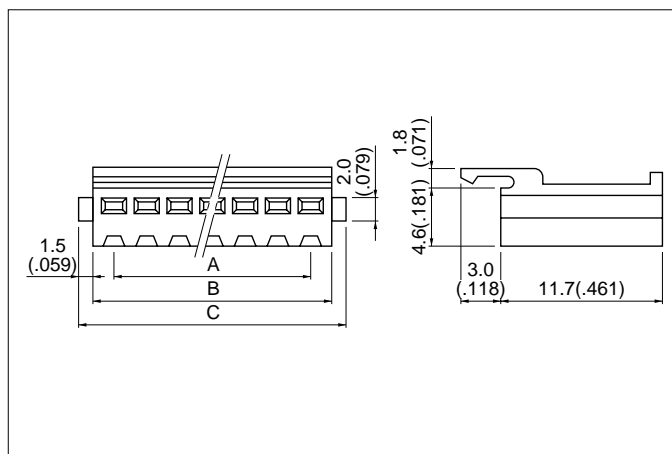

Cir- cuits	Model No.	Dimensions mm(in.)			Q'ty / bag
		A	B	C	
2	H 2P-SHF-AA	2.5(.098)	5.7(.224)	8.7(.343)	1,000
3	H 3P-SHF-AA	5.0(.197)	8.2(.323)	11.2(.441)	1,000
4	H 4P-SHF-AA	7.5(.295)	10.7(.421)	13.7(.539)	1,000
5	H 5P-SHF-AA	10.0(.394)	13.2(.520)	16.2(.638)	1,000
6	H 6P-SHF-AA	12.5(.492)	15.7(.618)	18.7(.736)	1,000
7	H 7P-SHF-AA	15.0(.591)	18.2(.717)	21.2(.835)	500
8	H 8P-SHF-AA	17.5(.689)	20.7(.815)	23.7(.933)	500
9	H 9P-SHF-AA	20.0(.787)	23.2(.913)	26.2(1.031)	500
10	H10P-SHF-AA	22.5(.886)	25.7(1.012)	28.7(1.130)	500
11	H11P-SHF-AA	25.0(.984)	28.2(1.110)	31.2(1.228)	500
12	H12P-SHF-AA	27.5(1.083)	30.7(1.209)	33.7(1.327)	500
13	H13P-SHF-AA	30.0(1.181)	33.2(1.307)	36.2(1.425)	500
14	H14P-SHF-AA	32.5(1.280)	35.7(1.406)	38.7(1.524)	500
15	H15P-SHF-AA	35.0(1.378)	38.2(1.504)	41.2(1.622)	200
16	H16P-SHF-AA	37.5(1.476)	40.7(1.602)	43.7(1.720)	200
18	H18P-SHF-AA	42.5(1.673)	45.7(1.799)	48.7(1.917)	200
20	H20P-SHF-AA	47.5(1.870)	50.7(1.996)	53.7(2.114)	200
21	H21P-SHF-AA	50.0(1.969)	53.2(2.094)	56.2(2.213)	200
22	H22P-SHF-AA	52.5(2.067)	55.7(2.193)	58.7(2.311)	200
24	H24P-SHF-AA	57.5(2.264)	60.7(2.390)	63.7(2.508)	200
25	H25P-SHF-AA	60.0(2.362)	63.2(2.488)	66.2(2.606)	200

Material

Nylon 6, UL94V-0, natural (white)

<For reference> As the color identification, the following alphabet shall be put in the underlined part.
For availability, delivery and minimum order quantity, contact JST.

ex. **H2P-SHF-AA-oo**

(blank)...natural (white)

K...black R...red TR...tomato red E...blue M...green

O...orange N...brown

Header

Top entry type

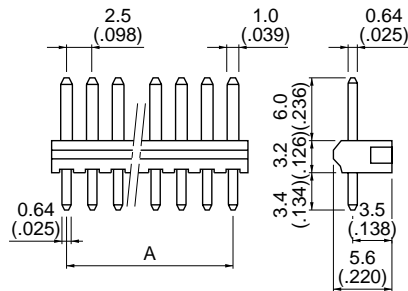

Side entry type

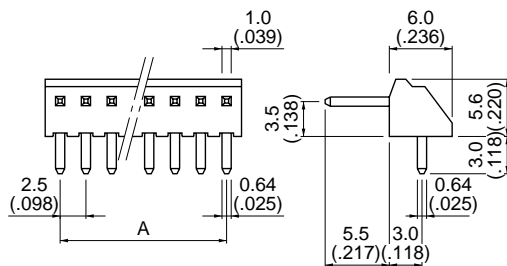

Bottom entry type

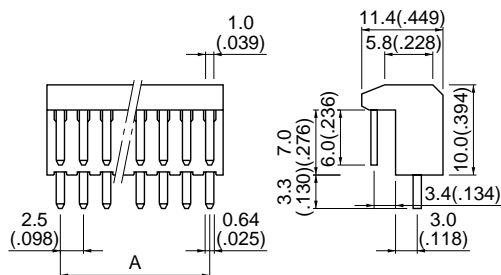

Circuits	Model No.			Dimensions A mm(in.)	Qty / box		
	Top entry type	Side entry type	Bottom entry type		Top entry type	Side entry type	Bottom entry type
2	B 2P-SHF-1AA	BS 2P-SHF-1AA	BE 2P-SHF-1AA	2.5 (.098)	1,000	1,000	250
3	B 3P-SHF-1AA	BS 3P-SHF-1AA	BE 3P-SHF-1AA	5.0 (.197)	1,000	1,000	250
4	B 4P-SHF-1AA	BS 4P-SHF-1AA	BE 4P-SHF-1AA	7.5 (.295)	1,000	500	250
5	B 5P-SHF-1AA	BS 5P-SHF-1AA	BE 5P-SHF-1AA	10.0 (.394)	1,000	500	250
6	B 6P-SHF-1AA	BS 6P-SHF-1AA	BE 6P-SHF-1AA	12.5 (.492)	500	500	150
7	B 7P-SHF-1AA	BS 7P-SHF-1AA	BE 7P-SHF-1AA	15.0 (.591)	500	500	150
8	B 8P-SHF-1AA	BS 8P-SHF-1AA	BE 8P-SHF-1AA	17.5 (.689)	500	500	150
9	B 9P-SHF-1AA	BS 9P-SHF-1AA	BE 9P-SHF-1AA	20.0 (.787)	500	500	150
10	B 10P-SHF-1AA	BS 10P-SHF-1AA	BE 10P-SHF-1AA	22.5 (.886)	250	250	100
11	B 11P-SHF-1AA	BS 11P-SHF-1AA	BE 11P-SHF-1AA	25.0 (.984)	250	250	100
12	B 12P-SHF-1AA	BS 12P-SHF-1AA	BE 12P-SHF-1AA	27.5 (1.083)	250	200	100
13	B 13P-SHF-1AA	BS 13P-SHF-1AA	BE 13P-SHF-1AA	30.0 (1.181)	250	200	100
14	B 14P-SHF-1AA	BS 14P-SHF-1AA	BE 14P-SHF-1AA	32.5 (1.280)	250	200	50
15	B 15P-SHF-1AA	BS 15P-SHF-1AA	BE 15P-SHF-1AA	35.0 (1.378)	250	200	50
16	B 16P-SHF-1AA	BS 16P-SHF-1AA	—	37.5 (1.476)	250	200	—
17	B 17P-SHF-1AA	—	—	40.0 (1.575)	200	—	—
18	B 18P-SHF-1AA	BS 18P-SHF-1AA	—	42.5 (1.673)	200	200	—
19	B 19P-SHF-1AA	—	—	45.0 (1.772)	250	—	—
20	B 20P-SHF-1AA	BS 20P-SHF-1AA	—	47.5 (1.870)	250	200	—
21	B 21P-SHF-1AA	BS 21P-SHF-1AA	—	50.0 (1.969)	250	200	—
22	B 22P-SHF-1AA	BS 22P-SHF-1AA	—	52.5 (2.067)	250	200	—
23	B 23P-SHF-1AA	—	—	55.0 (2.165)	250	—	—
24	B 24P-SHF-1AA	BS 24P-SHF-1AA	—	57.5 (2.264)	250	200	—
25	B 25P-SHF-1AA	BS 25P-SHF-1AA	—	60.0 (2.362)	250	200	—

Material and Finish

Post: Brass, copper-undercoated, tin/lead-plated

Wafer: Nylon 66, UL94V-0, natural (white) for the top and side entry types

Nylon 6, UL94V-0, natural (white) for the bottom entry type

<For reference> As the color identification, the following alphabet shall be put in the underlined part.
For availability, delivery and minimum order quantity, contact JST.

ex. **B2P-SHF-1AA-oo**

(blank)...natural (white)

BK...black R...red TR...tomato red E...blue M...green

O...orange N...brown

NH CONNECTOR

PC board layout (viewed from soldering side) and Assembly layout

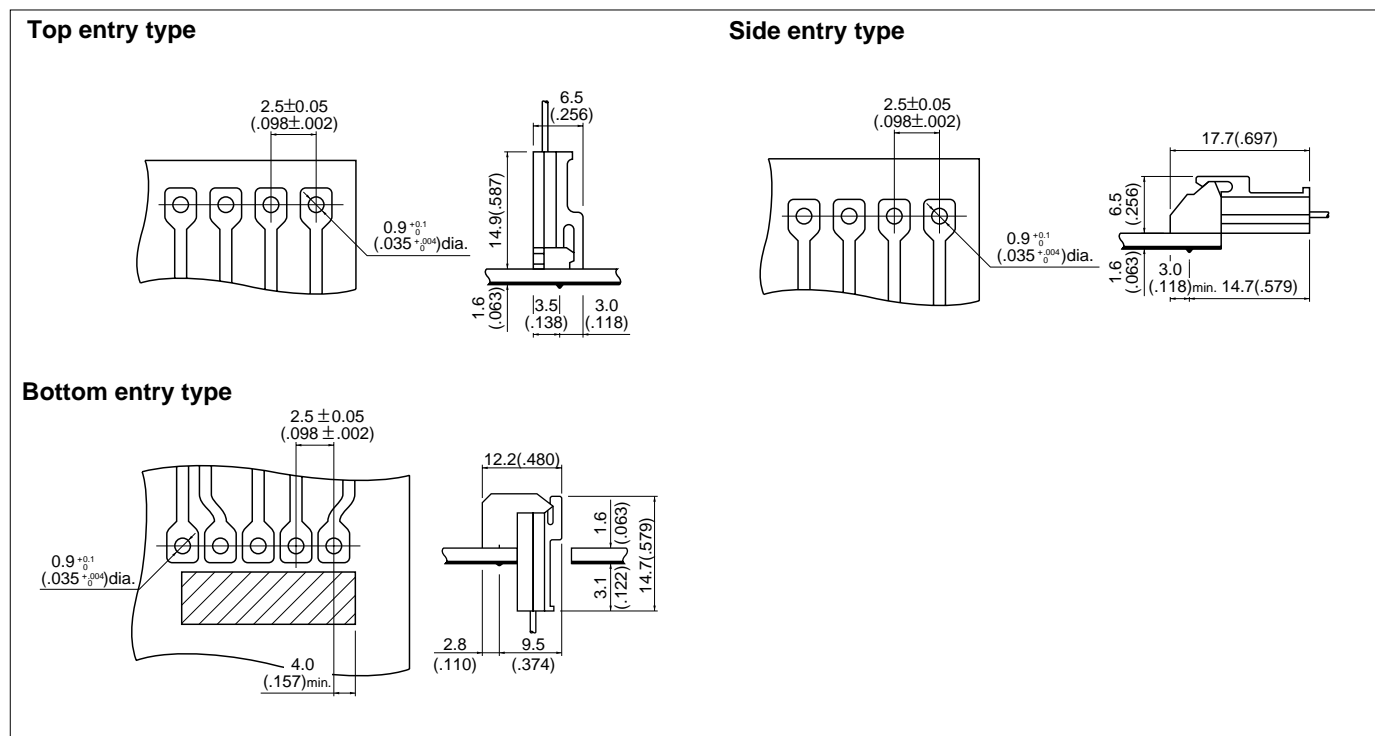

Note:

1. Tolerances are non-cumulative: $\pm 0.05\text{mm}(\pm .002")$ for all centers.
2. Hole dimensions differ according to the kind of PC board and piercing method. The dimensions above should serve as a guideline. Contact JST for details.

Applicator for the semi-automatic press AP-K2N

Contact	Crimp applicator MKS-L		Compact crimp applicator MKS-LS		Strip-crimp applicator MKS-SC
	with safety cover	without safety cover	with safety cover	without safety cover	with safety cover
SHF-001T-0.8BS	APLMK SHF001-08S	APLNC SHF001-08S	APLMKLS SHF001-08S	APLLSNC SHF001-08S	APLSC SHF001-08S
SHF-002T-0.8BS	APLMK SHF002-08S	APLNC SHF002-08S	APLMKLS SHF002-08S	APLLSNC SHF002-08S	APLSC SHF002-08S