

A General Specifications

Electrical Capacity (Resistive Load)

Power Level (silver):	6A @ 125V AC & 3A @ 250V AC 4A @ 30V DC for On-None-On; 3A @ 30V DC for all other circuits
Logic Level (gold):	0.4VA maximum @ 28V AC/DC maximum (Applicable Range 0.1mA ~ 0.1A @ 20mV ~ 28V)

Other Ratings

Contact Resistance:	10 milliohms maximum for silver; 20 milliohms maximum for gold
Insulation Resistance:	1,000 megohms minimum @ 500V DC
Dielectric Strength:	1,000V AC minimum between contacts for 1 minute minimum; 1,500V AC minimum between contacts and case for 1 minute minimum
Mechanical Life:	50,000 operations minimum
Electrical Life:	50,000 operations minimum for silver at 3A @ 250V AC; 25,000 operations minimum for silver at 6A @ 125V AC; 50,000 operations minimum for gold
Angle of Throw:	25°

Environmental Data

Operating Temp Range:	-30°C through +85°C (-22°F through +185°F)
Sealing:	Waterproofing, achieved with boot at base of lever plus o-rings inside and outside of bushing, meets IP67 of IEC60529 Standards (dust tight and protection against effects of temporary immersion). See further explanation on page A51.

Processing

Soldering:	Manual Soldering for Silver: ON-NONE-ON: See Profile B in Supplement section. ON-OFF-ON and (ON)-OFF-(ON): See Profile A in Supplement section. Manual Soldering for Gold, all circuits: See Profile A in Supplement section. Note: Lever must be in OFF (center) position while soldering.
-------------------	--

Distinctive Characteristics

Inner o-ring and external rubber washer seal the switch to achieve IP67 of IEC60529 Standards (dust tight and water protected for temporary immersion).

Waterproof boot at base of toggle further ensures protection against wet environments.

Actuation provides smooth, sturdy tactile feel.

Polished, chrome-plated actuator paired with the waterproof boot not only delivers in terms of sleek design, but also functionality and reliability.

Superb quality and construction design prohibit entry of harmful particles that may otherwise compromise lever operation.

Actual Size

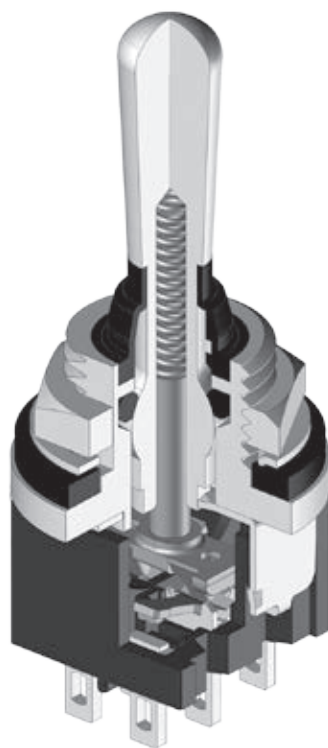
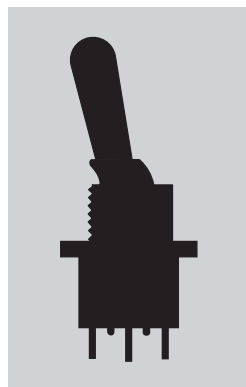

TYPICAL SWITCH ORDERING EXAMPLE

M20

1

2

WB

G

01

Poles	
1	SPDT
2	DPDT

Circuits			
2	ON	NONE	ON
3	ON	OFF	ON
8	(ON)	OFF	(ON)
() = Momentary			

Toggle with Large Bushing	
WB	.787" (20.0mm) Bat with Large .472" (12.0mm) Threaded Bushing with D Flat

Contact Material & Ratings	
W	Silver; Rated 6A @ 125V AC & 3A @ 250V AC
G	Gold; Rated 0.4VA max @ 28V AC/DC max

Terminals	
01	Solder Lug

DESCRIPTION FOR TYPICAL ORDERING EXAMPLE

M2012WBG01

.787" (20.0mm) Bat Lever with Waterproof Boot

.472" (12.0mm) Threaded Bushing with D Flat







Gold Contacts with 0.4VA Rating



SPDT ON-NONE-ON Circuit

Solder Lug Terminals

POLES & CIRCUITS

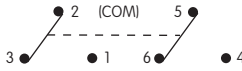
		Toggle Position () = Momentary			Connected Terminals			Throw & Schematics
Pole	Model	Up 	Center 	Down 	Up 	Center 	Down 	Note: Terminal numbers are not actually on the switch.
SP	M2012 M2013 M2018	ON ON (ON)	NONE OFF OFF	ON ON (ON)	2-3 	OPEN	2-1	
DP	M2022 M2023 M2028	ON ON (ON)	NONE OFF OFF	ON ON (ON)	2-3 5-6 	OPEN	2-1 5-4	DPDT 

A	Toggles
	Rockers
	Pushbuttons
	Illuminated PB
	Programmable
	Keylocks
	Rotaries
	Slides
	Tactiles
	Tilt
	Touch
	Indicators
	Accessories
	Supplement

STANDARD HARDWARE

AT503M Hex Face Nut
Brass/Chrome

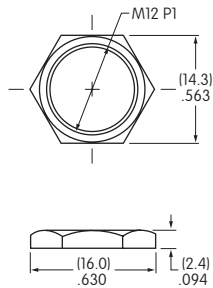

AT508 Lockwasher
Steel with Zinc/Chromate

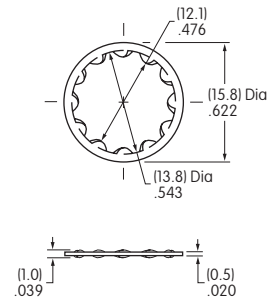

AT401P O-ring
Nitrile Butadiene Rubber

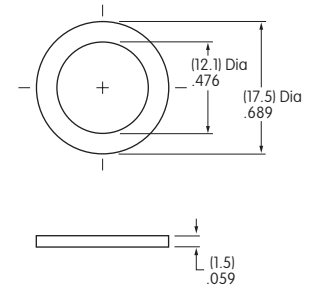

PANEL CUTOUTS & THICKNESS

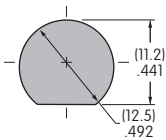

Anti-rotation

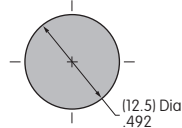

No
Anti-rotation

Maximum Effective Panel Thickness
.118" (3.0mm)

TYPICAL SWITCH DIMENSIONS

Solder Lug

Single Pole

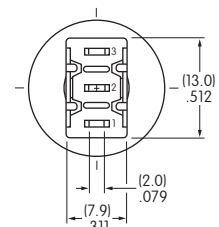
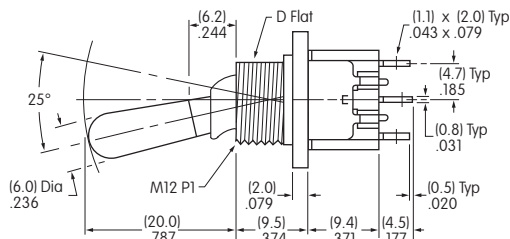
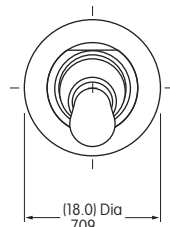

M2012WBG01

Solder Lug

Double Pole

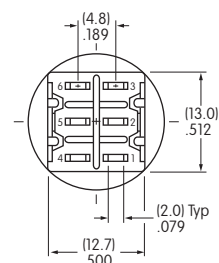
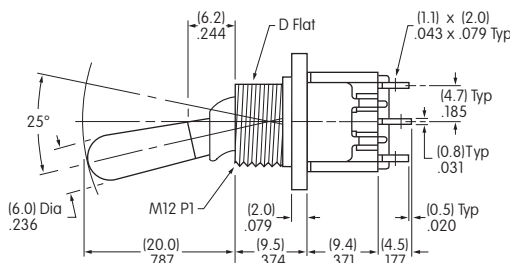
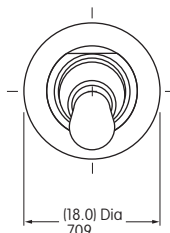

M2022WBG01

APPLICATION CONSIDERATIONS

The Dual Seal Waterproof M Toggle is designed as a panel seal switch, and not to be used under water.

Material Properties

The material for the waterproof boot is silicone rubber. While silicone rubber has excellent heat, cold and weather resistant properties, it has less durability and oil resistance.

The o-rings are made of nitrile butadiene rubber, which excels in durability and oil and chemical resistance. Its performance is less durable with lower weather and ozone resistant characteristics.

Evaluate the products in regard to your application and intended environment with these properties in mind.

Repeat opening and closing same as previous test. The resulting insulation resistance and voltage capacity are both within the rated values, and water has not entered inside the switch or installation panel.

Panel Installation

For panel installation, the internal tooth lockwasher is installed above the panel. The external o-ring mounts below the panel.

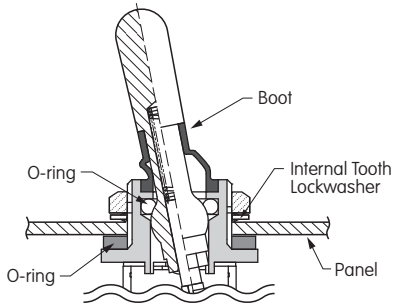

Waterproof Test Conditions

Waterproofing is measured by submerging the switch 5 centimeters from the water surface (see illustration), and opening and closing 50 times at a frequency of 50 – 60 times per minute. The switch is then submersed 1 meter from the surface and left in this position for 30 minutes.

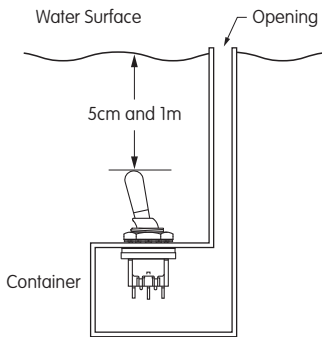

Applications

- Construction Equipment
- Medical Equipment
- Hospitality and Restaurant
- Machine Tooling
- Transportation
- Marine Equipment *

* Salt spray tested as per Mil-STD-810G section 509.5.