



IEC Cord-Sets

Bulgin's mains appliance cord sets are renowned for quality. Manufactured in our own factories, each connector is ultra sonically welded around the cable and after assembly each individual set under goes through 100% testing, ensuring a permanent, safe and long life connection.

The range consists of five non rewirable connectors; straight IEC male and female, side entry IEC male and female and UK BS1363/A plug. The standard colour is black and conductor size is 0.75mm² up to 2m and 1.00mm² for longer lengths, alternative colours and cable lengths are available on request. Each style can be produced as either connector to plug, or connector or plug to bared ends.

Type		Page
PZ0100 Series IEC Power Cords	Female Straight	139
PZ0200 Series IEC Power Cords	Female Angled	139
PZ0500 Series IEC Power Cords	Male Straight	140
PZ0600 Series IEC Power Cords	Male Angled	140
PZ0800 Series UK Power Cord	BS1363 Plug	141

Connectors



PZ0100 IEC Female Straight

Opposite End Plugs



PZ0500 IEC Male Straight

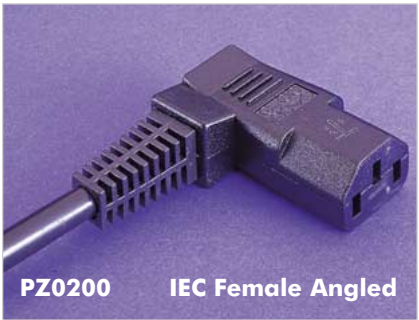

PZ0200 IEC Female Angled



PZ0600 IEC Male Angled

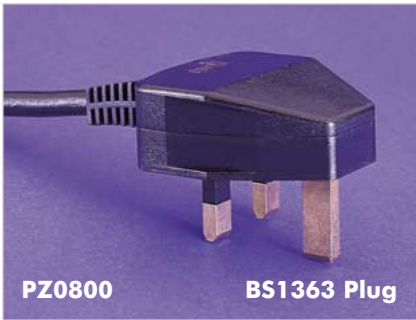

PZ0800 BS1363 Plug

IEC CONNECTORS

How to Order

PZxx xx / xxxx / xx xx				
Connector	Opposite End Plug	Cable Length (standard)	Colour	Fuse Rating
01 = PZ0100	05 = PZ0500	2M00 = 2 Metres	BK = Black*	03 = 3AMP
02 = PZ0200	06 = PZ0600	2M50 = 2.5 Metres	GY = Grey	05 = 5AMP
	08 = PZ0800	3M00 = 3 Metres	WH = White	10 = 10AMP
			* For PZ0800 variants only, for others leave blank for black.	Required for PZ0800 only, for other connectors leave blank.

Examples:

PZ0105/2M00 = PZ0100 black with PZ0500 on opposite end with 2 metres of cable.

PZ0108/2M00BK05 = PZ0100 black with PZ0800 on opposite end with 2 metres of cable and 5AMP fuse.

Notes:

Cord Sets with cable length of 2 metres and under use 0.75mm² cable.
Cord Sets longer than 2 metres use 1.00mm² cable in accordance with BS EN60 320, IEC799.

Cord Set length measured from connector face to connector face.
This table shows only standard configurations, for variations of cable length, colour or connector/plug combinations please contact the sales office.

BS EN60 320-1 (Standard Sheet C13 Class I) Non Rewirable Cold Condition
IEC FEMALE STRAIGHT

PZ0100/Length

- Non Rewirable
- Various Cable Lengths
- Choice of Colours
- 10A, 250V a.c.

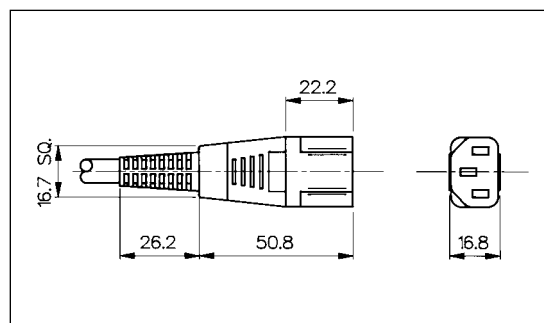
IEC FEMALE ANGLED

PZ0200/Length

- Non Rewirable
- Various Cable Lengths
- Choice of Colours
- 10A, 250V a.c.

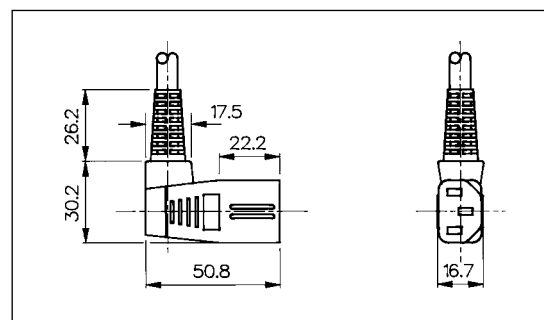
Ordering Data

Length	PZ0100	PZ0200
2 Metres	PZ0100/2M00	PZ0200/2M00
2.5 Metres	PZ0100/2M50	PZ0200/2M50
3 Metres	PZ0100/3M00	PZ0200/3M00

For grey or white versions add colour suffix /GY or /WH
e.g. PZ0100/2M00/WH = 2 metre length, colour white

Specification	PZ0100/Length/Colour	PZ0200/Length/Colour
Cable Lengths (standard):	2m (/2M00), 2.5m (/2M50), 3m (/3M00)	2m (/2M00), 2.5m (/2M50), 3m (/3M00)
Cable type: 2m and under over 2m	0.75mm ² 1.00mm ²	0.75mm ² 1.00mm ²
Terminations:	Bared ends	Bared ends
Max. Rating:	10A, 250V a.c.	10A, 250V a.c.
Contact Resistance:	<10mΩ	<10mΩ
Insulation Resistance:	>10 ⁵ MΩ @ 500V d.c.	>10 ⁵ MΩ @ 500V d.c.
A.C. Breakdown:	Pole-Pole 6.5kV Poles-Accessible parts 5kV	Pole-Pole 6.5kV Poles-Accessible parts 5kV
Operating Temp. Range:	0°C to +70°C	0°C to +70°C
Withdrawal Force:	10N (Min.) 50N (Max.)	10N (Min.) 50N (Max.)
Mouldings:	Polycarbonate Flammability Rating UL 94V-0	Polycarbonate Flammability Rating UL 94V-0
Contacts:	Phosphor Bronze	Phosphor Bronze
Approvals:	*Pending	*Pending
Mates with:	PX0575, PX0579, PX0580, PF0001, PF0011, PF0030, PF0033	
Colours:	Black (blank), Grey (/GY), White (/WH)	Black (blank), Grey (/GY), White (/WH)
Variants:	For other lengths please contact the sales office	
RoHS	Compliant	Compliant

BS EN60 320 - 2 - 2 (Standard Sheet E Class I) Non Rewirable

IEC MALE STRAIGHT



- Non Rewirable
- Various Cable Lengths
- Choice of Colours
- 10A, 250V a.c.

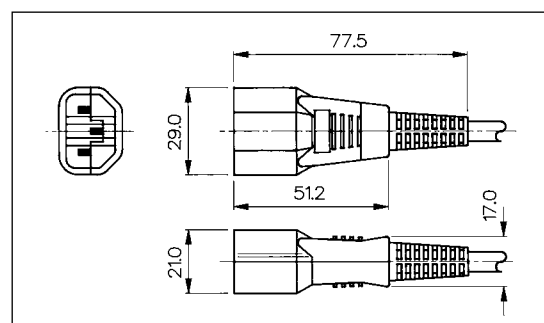

IEC MALE ANGLED



- Non Rewirable
- Various Cable Lengths
- Choice of Colours
- 10A, 250V a.c.

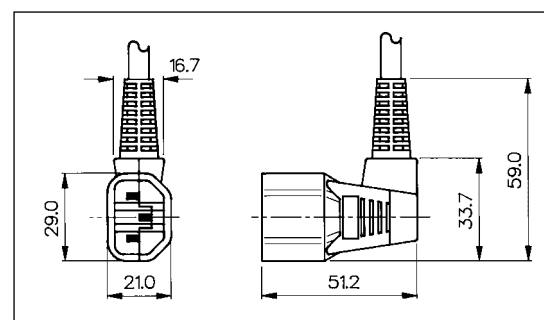

Ordering Data

Length	PZ0500	PZ0600
2 Metres	PZ0500/2M00	PZ0600/2M00
2.5 Metres	PZ0500/2M50	PZ0600/2M50
3 Metres	PZ0500/3M00	PZ0600/3M00

For grey or white versions add colour suffix /GY or /WH
e.g. PZ0500/2M50/GY = 2.5 metre length, colour grey

Specification	PZ0500/Length/Colour	PZ0600/Length/Colour
Cable Lengths (standard):	2m (/2M00), 2.5m (/2M50), 3m (/3M00)	2m (/2M00), 2.5m (/2M50), 3m (/3M00)
Cable type: 2m and under over 2m	0.75mm ² 1.00mm ²	0.75mm ² 1.00mm ²
Terminations:	Bared ends	Bared ends
Max. Rating:	10A, 250V a.c.	10A, 250v a.c.
Contact Resistance:	<10mΩ	<10mΩ
Insulation Resistance:	>10 ⁴ MΩ @ 500V d.c.	>10 ⁴ MΩ @ 500V d.c.
A.C. Breakdown:	Pole-Pole 6.5kV Poles-Accessible parts 6kV	Pole-Pole 6.5kV Poles-Accessible parts 6kV
Operating Temp. Range:	0°C to +70°C	0°C to +70°C
Withdrawal Force:	10N (Min.) 50N (Max.)	10N (Min.) 50N (Max.)
Mouldings:	Polycarbonate Flammability Rating UL 94V-0	Polycarbonate Flammability Rating UL 94V-0
Contacts:	Brass, Tin Plated	Brass, Tin Plated
Approvals:	⚡ (pending)	⚡ (pending)
Mates with:	PX0675, PX0695, PX0783, PX0793, PX0714	PX0675, PX0695, PX0783, PX0793, PX0714
Colours:	Black (blank), Grey (/GY), White (/WH)	Black (blank), Grey (/GY), White (/WH)
Variants:	For other lengths please contact the sales office	
RoHS	Compliant	Compliant

BS1363/A Non-Rewirable

UK 3 PIN PLUG

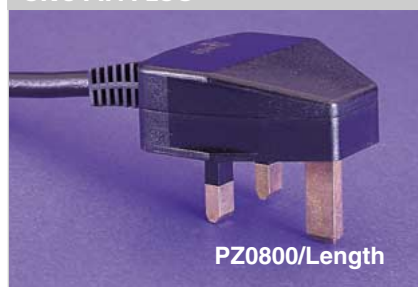

- Non Rewirable
- Various Cable Lengths
- Choice of Colours
- 3A, 5A or 10A Rating
- 250V a.c.

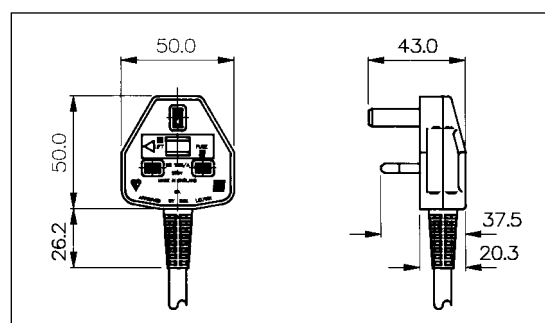

Ordering Data

Length	3A Fuse Rating	5A Fuse Rating	10A Fuse Rating
2 Metres	PZ0800/2M00BK03	PZ0800/2M00BK05	PZ0800/2M00BK10
2.5 Metres	PZ0800/2M50BK03	PZ0800/2M50BK05	PZ0800/2M50BK10
3 Metres	PZ0800/3M00BK03	PZ0800/3M00BK05	PZ0800/3M00BK10

For grey or white versions change colour suffix to GY or WH
e.g. PZ0800/2M50WH05 = 2.5 metre length, colour white, 5A fuse

Specification	PZ0800/LengthColourFuse		
Cable Lengths (standard):	2m (2M00), 2.5m (2M50), 3m (3M00)		
Cable type:			
Fused 3A and 5A:			
all lengths	0.75mm ²		
Fused 10A:			
2m and under	0.75mm ²		
over 2m	1.00mm ²		
Terminations:	Bared ends		
Fuse Ratings:	3A (03), 5A (05) or 10A (10) 250V a.c.		
Operating Temp. Range:	0°C to +70°C		
Mouldings:	Polycarbonate Flammability Rating UL 94V-0		
Contacts:	Pins: Brass		
Approvals:			
Colours:	Black (BK), Grey (GY), White (WH)		
Variants:	For other lengths please contact the sales office		
RoHS	Compliant		

