

1.

1.27

Safety switches with separate actuator / Class 2
ST 14 range

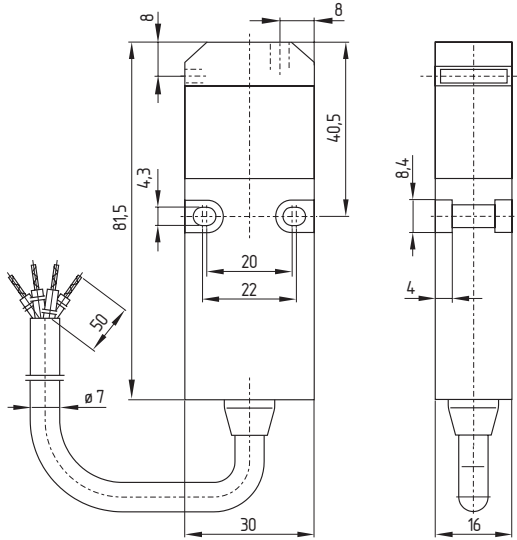

- Features
- Thermoplastic enclosure
 - Slim design
 - Multiple coding
 - Long life
 - Double insulated
 - High level of contact reliability with low voltages and currents
 - Pre-wired with 1 m cable
 - Actuator with rubber mountings
 - EEx version see chapter 14.1.1.2

Contacts/
Switch travel

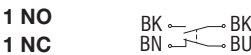

Standard version

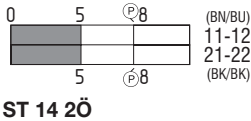
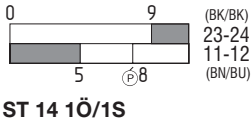

Notes

Inserted position of actuator = 0 in switch travel diagrams.
Actuators must be ordered separately.
A selection of suitable actuators can be found in 1.28.

1.

1.27

Safety switches with separate actuator / Class 2
ST 14 range



Cable
lengths

- 2 metres long, Ordering suffix -2m
 - 5 metres long, Ordering suffix -5m
 - 10 metres long, Ordering suffix -10m
- Other cable lengths possible on enquiry.

Ordering
details

To order, select the part number of the desired switch from the table “Contacts/Switch travel”, e.g. safety switch with two NC contacts, 2 m long cable: ST 14 2Ö-2m

Actuators and accessories must be ordered separately, e.g. angled actuator: ST 14-B5

The applicable ordering suffix is added at the end of the part number of the safety switch.
Further variants not shown here are available on enquiry.

Info

- Alternative version with side cable entry, ordering suffix -s, e.g. ST14 1Ö/1S-s

Approvals





Straight actuator ST 14-B1

- On hinged guards, minimum actuating radius 140 mm
- Damps vibration on guards



- The axis of the hinge should be 30 mm above the top edge of the safety switch and in the same plane

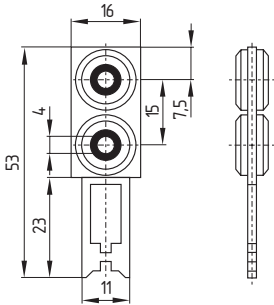

Adjustable actuator ST 14-B3

- Particularly suitable for hinged guards
- For very small actuating radii at 90° to the plane of the actuator
- Minimum actuating radius 50 mm on hinged guards

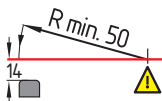

- The axis of the hinge should be 14 mm above the top edge of the safety switch and in the same plane

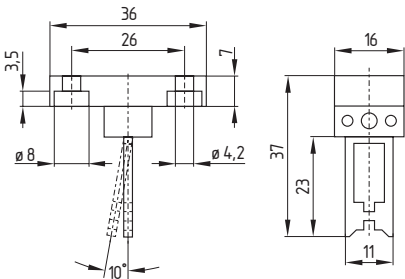

Angled actuator ST 14-B5

- Particularly suitable for hinged guards
- Minimum actuating radius 140 mm on hinged guards



- The axis of the hinge should be 15 mm above the top edge of the safety switch and in the same plane

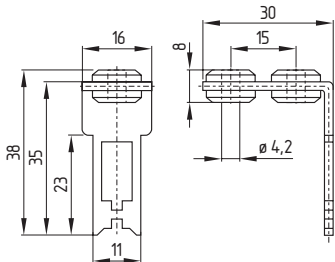



ST 14	
Standards:	IEC/EN 60947-5-1/DIN VDE 0660-200; EN 1088; BG-GS-ET-15
Enclosure material:	Glass-fibre reinforced thermoplastic, self-extinguishing
Actuator:	Stainless steel 1.4301
Protection class:	IP 67 to IEC/EN 60529/DIN VDE 0470-1
Contact material:	Silver
Contact type:	Changeover with double break Zb
	or 2 NC contacts
Switching system:	⊖ IEC 60947-5-1; ⊕ BG-GS-ET-15; slow action, NC contact with positive break
Termination:	Pre-wired cable H05/VV-F4 x 0.75 mm ²
	1 m, 2 m, 5 m or 10 m long
Rated impulse	
withstand voltage U _{imp} :	4 kV
Rated insulation	
voltage U _i :	250 V
Thermal test current I _{th} :	10 A
Utilisation category:	AC-15
Rated operating	
current/voltage I _ø /U _ø :	4 A/230 V
Max. fuse rating:	6 A (slow blow)
Positive break travel:	5 mm
Positive break force:	Min. 15 N
Ambient temperature:	– 20 °C ... + 80 °C
Mechanical life:	> 1 million operations

