



A

Pushbutton

PHA Series

Short Stroke Pushbutton Switches

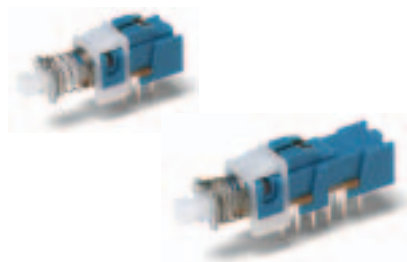

Features/Benefits

- **Momentary or latching action**
- **Low cost, reliable contact design**
- **2 & 4 pole configurations**
- **Sealed contacts**
- **Optional buttons**
- **RoHS compliant**

Typical Applications

- **Computers and peripherals**
- **Instrumentation and measurement equipment**
- **Non-power, on-off switch applications**

Specifications

SWITCHING POWER MAX.: 3 W DC
SWITCHING VOLTAGE MAX.: 30 V DC
SWITCHING CURRENT MAX.: 100 mA DC
DIELECTRIC STRENGTH (50 Hz/1 min.): 500 V between open contacts. 1500 V between chassis and contacts.
OPERATING LIFE: 10,000 cycles at rated load
CONTACT RESISTANCE: 20 m ohms initial Ω
INSULATION RESISTANCE: 100 M ohms Ω
TOTAL TRAVEL/LATCHING TRAVEL: 2.5mm/1.5mm (.098 inch/.059 inch)
OPERATING FORCE:
170 grams \pm 50 grams (1.67 \pm 0.98N)
230 grams \pm 50 grams (2.26 \pm 0.98N)
SEALING: Sealed contacts.

Materials

FIXED TERMINAL: Brass, silver plated.
MOVABLE CONTACT: Phosphor bronze, silver plated.
SWITCH BODY: PPE
ACTUATOR: POM
STANDOFF CLIP: POM
RETURN SPRING: Music wire.
RETURN SPRING RETAINER: Carbon steel, tin plated.
DETENT SPRING PLATE: Phosphor bronze.
DETENT SPRING: Stainless steel.
BASE: Laminated phenolic.
TERMINAL SEAL: Epoxy.

NOTE: Specifications and materials listed above are for switches with standard options. For information on specific and custom switches, consult Customer Service Center.

Build-A-Switch

To order, simply select desired option from each category and place in the appropriate box. Available options are shown and described on pages A-85 thru A-87. For additional options not shown in catalog, consult Customer Service Center.

Switch		Button					
<div>P</div>	<div>H</div>	<div>A</div>					
Contact Arrangement		Mechanical Function		Indexed		Round	
2U 2 Changeovers		OA Momentary		G001A Black		G003A Black	
4U 4 Changeovers		EE Push-push		G001G Gray		G003G Gray	
				G001I Ivory		G003I Ivory	
				G001R Red		G003R Red	
				Rectangular		Square	
				G002A Black		G004A Black	
				G002G Gray		G004G Gray	
				G002I Ivory		G004I Ivory	
				G002R Red		G004R Red	

BUTTON REMOVAL

A button of a push-push switch should only be removed in the "OFF" non-latching position.



Dimensions are shown: Inches (mm)
Specifications and dimensions subject to change

PHA Series Short Stroke Pushbutton Switches



A

Pushbutton

2U 2 CHANGEOVERS

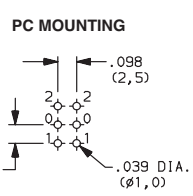
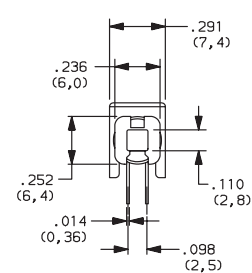
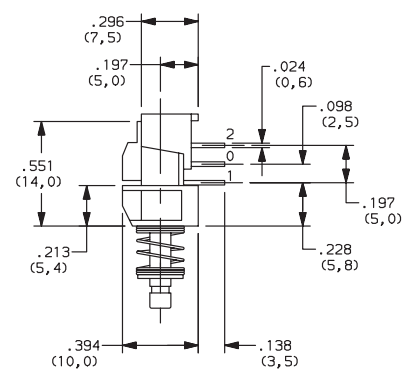
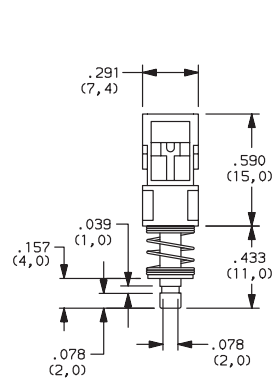

4U 4 CHANGEOVERS

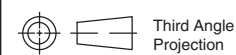
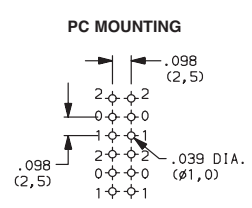
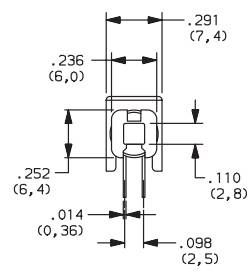
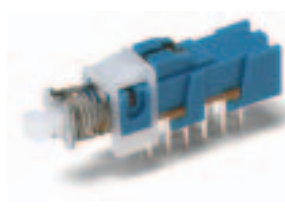
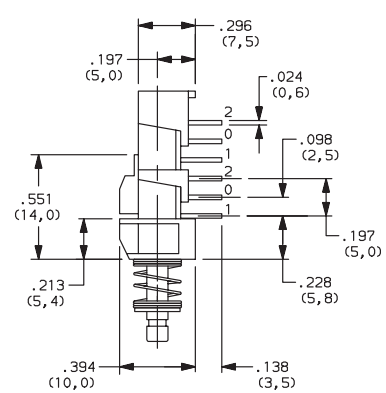
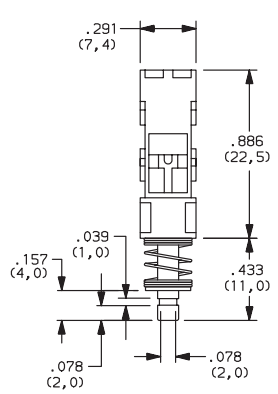

Dimensions are shown: Inches (mm)
Specifications and dimensions subject to change

www.ck-components.com



A

Pushbutton

PHA Series

Short Stroke Pushbutton Switches

CONTACT ARRANGEMENT



OPTION CODE	NO. OF POLES *	SCHEMATIC
2U	2PDT	
4U	4PDT	2X

*Non-shorting contacts.

MECHANICAL FUNCTION



OPTION CODE	FUNCTION
OA	Momentary
EE	Push-push



Dimensions are shown: Inches (mm)
Specifications and dimensions subject to change

www.ck-components.com

PHA Series Short Stroke Pushbutton Switches



A

Pushbutton

BUTTONS



Indexed

- G001A** Black
- G001G** Gray
- G001I** Ivory
- G001R** Red

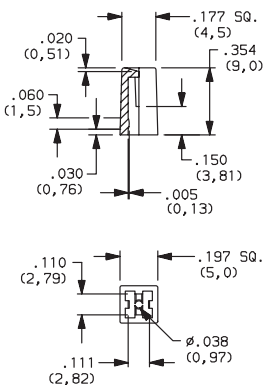
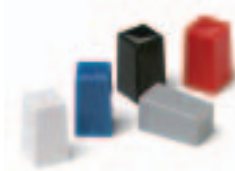

Rectangular

- G002A** Black
- G002G** Gray
- G002I** Ivory
- G002R** Red

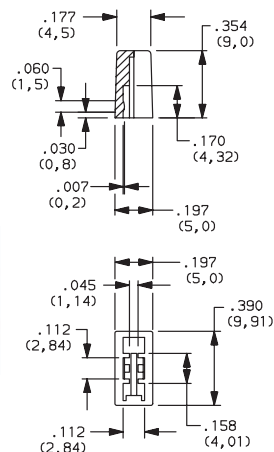

Round

- G003A** Black
- G003G** Gray
- G003I** Ivory
- G003R** Red

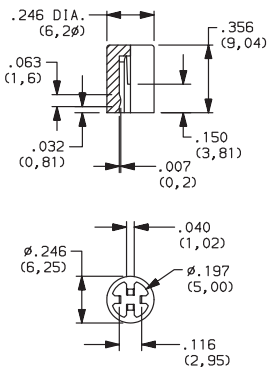

Square

- G004A** Black
- G004G** Gray
- G004I** Ivory
- G004R** Red

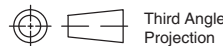
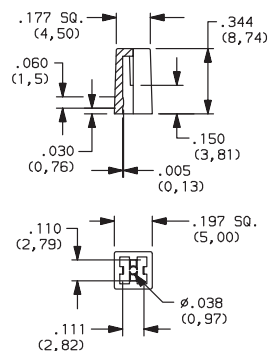
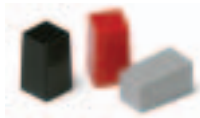

Dimensions are shown: Inches (mm)
Specifications and dimensions subject to change

www.ck-components.com