

## Dimensions: mm (In.)

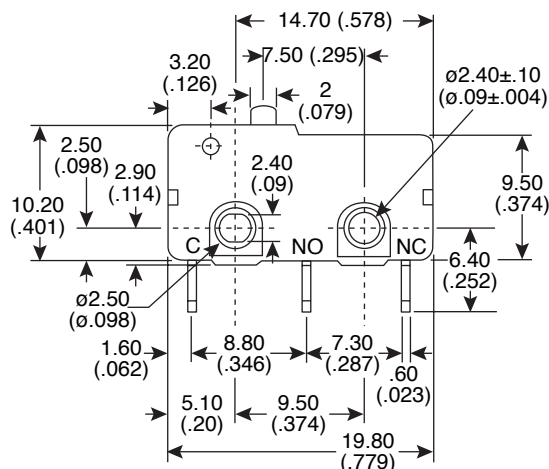

Contact Configuration

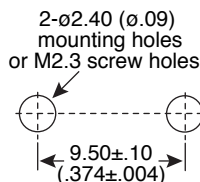
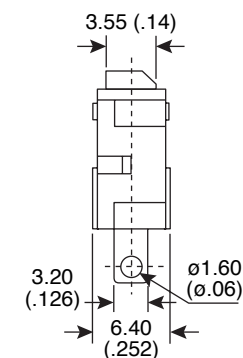

Mounting Holes

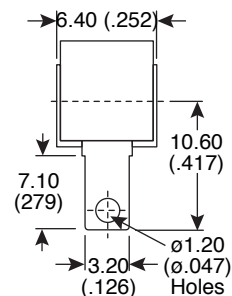
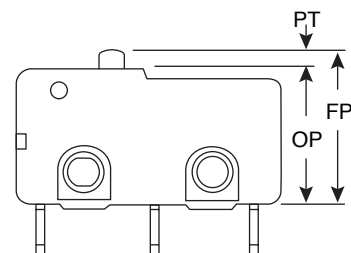

Quick Connect Terminal

**Mechanical Specifications:**

- Operating Frequency: 120 operations/min
- Life: 10,000,000 operation min.

**Note:**

- RoHS compliant and process compatible with 260° solder.

**Electrical Specifications:**

- Operating Frequency: 10~30 operations/min
- Life: 6,000~100,000 operations
- Rating: 10.1A/125VAC/250VAC
- Contact Resistance: 30mΩ max.
- Insulation Resistance: 100mΩ min. @ 500VDC
- Dielectric Strength: 1,000VAC RMS (50-60HZ)

**Operating Characteristics:**

- OF Max. (g): 249
- Op (mm): 11.4 ± 0.3
- PT Max. (mm): 1.1
- OT Min. (mm): 0.4
- MD Max. (mm): 0.2
- FP Max. (mm): 12.2
- RF Min. (g): 50

**Sub-Miniature Snap Switch**  
101-61-10-249XX-Q-EV

**Mountain**  
**Switch**

# Mouser Electronics

Authorized Distributor

Click to View Pricing, Inventory, Delivery & Lifecycle Information:

Mountain Switch:

[101-61-10-249XX-Q-EV](#)