

QLK45 Series AC Crossflow Blowers

- ▶ 45 mm Impeller Diameter
- ▶ Low Profile Housing
- ▶ Double Vortex Provides Speed and Noise Control
- ▶ UL/CSA Approvals
- ▶ Max. Temperature: 60°C (140°F)
- ▶ Long Life, Permanently Lubricated, Maintenance-Free Sleeve Bearings
- ▶ Very Low Noise Levels
- ▶ Class H Insulation; Class B Available
- ▶ Connection: 0.250" (6.3 mm) Spade Terminals

Dimensions — In. (mm)

Mfr.'s Type	A	B	C	D	E	F
55442.40890	10.43 (265)	2.36 (60)	7.09 (180)	6.06 (154)	2.72 (69)	0.55 (14)
55442.70170	15.83 (402)	2.99 (76)	11.81 (300)	10.71 (272)	5.04 (128)	0.59 (15)

QLK45 Series AC Crossflow Blowers

Stock No.	Mfr.'s Type	Part No.	CFM @ 0"	Volts	Hertz	Watts	dBA	Insulation Class	Motor Position	Bobbin Position	Connect	EACH
600-3500	55442.40890	QLK45/1800A138-2518LH-26LU	75	115	60	29	50	H	Right	Up	Terminals	37.15
600-3501	55442.70170	QLK45/3000A31-3030LH-115AEP	125	115	60	40	53	H	Right	Up	Terminals	44.12

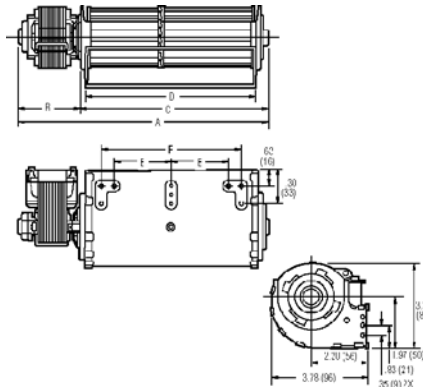

QLZ06 Series AC Crossflow Blowers

- ▶ 60 mm Impeller Diameter
- ▶ UL/CSA Approvals
- ▶ Max. Temperature: 60°C (140°F)
- ▶ 230 Volt Models Available
- ▶ Long Life, Permanently Lubricated, Maintenance-Free Sleeve Bearings
- ▶ Class B and Class H Insulation
- ▶ Connection: 0.250" (6.3 mm) Spade Terminals

Dimensions — In. (mm)

Mfr.'s Type	A	B	C	D	E	F
55410.81390	10.24 (260)	2.17 (55)	7.68 (195)	6.06 (154)	2.52 (64)	6.06 (154)
55412.70210	15.55 (395)	2.83 (72)	12.32 (313)	10.70 (272)	4.84 (123)	10.70 (272)

QLZ06 Series AC Crossflow Blowers

Stock No.	Mfr.'s Type	Part No.	CFM @ 0"	Volts	Hertz	Watts	dBA	Insulation Class	Motor Position	Bobbin Position	Connect	EACH
600-3502	55410.81390	QLZ06/1800A249-2524L-61LG	72	120	60	35	49	B	Right	Front	Terminals	44.76
600-3504	55412.70210	QLZ06/0030A46-3030LH-117ACW	138	115	60	56	50	H	Left	Front	Terminals	49.98

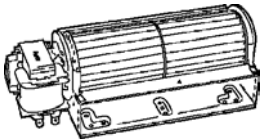

QLN65 Series AC Crossflow Blowers

- ▶ 65 mm Impeller Diameter
- ▶ UL/CSA Approvals
- ▶ Max. Temperature: 60°C (140°F)
- ▶ 230 Volt Models Available
- ▶ Class B Insulation; Class H Available
- ▶ Long Life, Permanently Lubricated, Maintenance-Free Sleeve Bearings
- ▶ Connection: 0.250" (6.3 mm) Spade Terminals

Dimensions — In. (mm)

Mfr.'s Type	A	B	C	D	E	F
55416.27070	10.67 (271)	2.88 (73)	7.09 (180)	6.06 (154)	2.72 (69)	0.87 (22)
55416.35031	15.98 (406)	3.47 (88)	11.81 (300)	10.71 (272)	5.04 (128)	0.91 (23)

QLN65 Series AC Crossflow Blowers

Stock No.	Mfr.'s Type	Part No.	CFM @ 0"	Volts	Hertz	Watts	dBA	Insulation Class	Motor Position	Bobbin Position*	Connect	EACH
600-3505	55416.27070	QLN65/0018A20-3030L-167ZR	110	115	60	46	49	B	Left	Front	Terminals	44.20
600-3506	55416.35031	QLN65/3000A3-3045L-48DL	150	115	60	66	49	B	Right	Front	Terminals	60.10

*Bobbin position cannot rotate to up position.

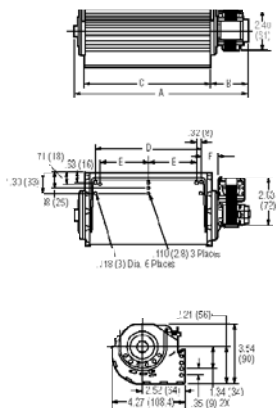
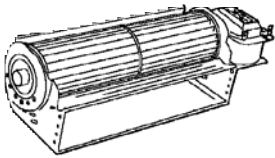

Brushless DC Miniature Crossflow Blowers

- ▶ Ball Bearing Motor, Aluminum Impeller, Extruded Aluminum Housing, Dynamically Balanced to Minimize Noise and Vibration
- ▶ Excellent for Paper Transfer, PC Board Cooling, Plotters, Desktop Electronics, Copiers, Scanners, Etc.
- ▶ Use One Crossflow Instead of Multiple Tubeaxial Fans
- ▶ Speed Controlled by Varying the Voltage
- ▶ Reverse Polarity and Locked Rotor Protection
- ▶ Long, Narrow Air Flow Path For Very Efficient Cooling

Mounting: 8 holes provided, 0.08" (2 mm) diameter. Air Flow: Across full discharge width; motor is to right of discharge opening and rotates in a clockwise direction. Connection: 11.8" (300 mm) leads color coded, red (+), blue (-).

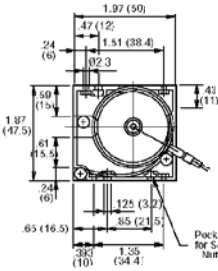
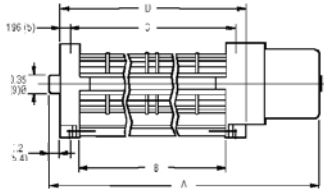
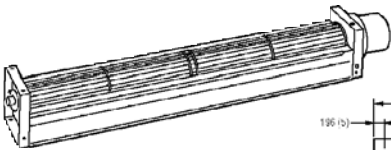

Stock No.	Mfr.'s Type	Type of Bearing	DC Volts	Watts	CFM @ 0"	dBA	Temp. Max °C	Weight (Oz.)	Dimensions — In. (mm)				EACH
									A	B	C	D	
600-3507	Q2G030-EA21-01	Ball	12	6.1	40	48	60	9	8.0 (203)	5.8 (148)	6.2 (158)	6.6 (168)	74.89