



Full metal top and side entry hoods with different screw options

Identification      No. of contacts      Part No.      Drawing      Dimensions in mm

## 40° side entry hood

**with** internal grounding block

9	61 03 001	013
15	61 03 001	014
25	61 03 001	015

**without** internal grounding block

9	61 03 001	013 010
---	-----------	---------

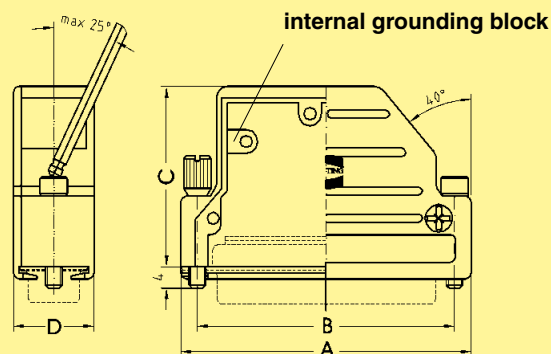

No. of contacts	A	B	C	D
9	31.0	25.0	35.0	15.0
15	39.3	33.3	35.0	15.0
25	53.0	47.0	35.0	15.0

## Top/side entry hood

**with** internal grounding block

9	61 03 001	010
15	61 03 001	016
25	61 03 001	017 <sup>1)</sup>
37	61 03 001	018 <sup>1)</sup>
50	61 03 001	019 <sup>1)</sup>

**without** internal grounding block

9	61 03 001	010 010
---	-----------	---------

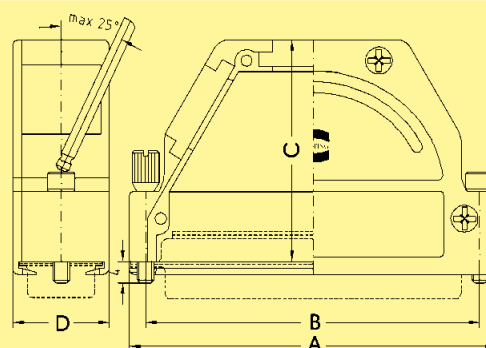

No. of contacts	No. of cable entries	A	B	C	D
9	1 (top)	31.0	25.0	38.0	15.0
15	1 (top)	39.5	33.3	35.0	15.0
25	3	53.0	47.0	43.0	15.0
37	3	69.5	63.5	43.0	15.0
50	3	67.2	61.6	43.0	17.8

Please insert digit for screw option

Knurled screw, thread 4-40 UNC	0
Hexagonal screw, thread M3 with captive washer	1
Hexagonal screw, thread 4-40 UNC with captive washer	2
Knurled screw, thread M3	3

## Top entry hood for InduCom 9

Hexagonal screw, thread 4-40 UNC

9	66 67 009 0346
---	----------------

Hexagonal screw, thread M3

9	66 67 009 0347
---	----------------

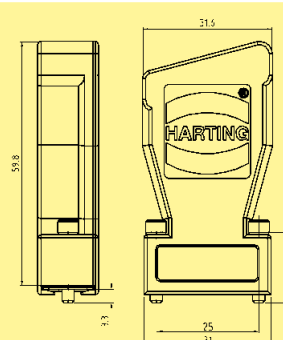

2 cable entries

<sup>1)</sup> Part No. contains two blanking pieces  
Operating temperature for all hoods on this page: -20 °C ... +90 °C