

3 mm Square Low-Profile SMT Trimmer Potentiometers (Cermet, Open Frame Type)



Type: **EVM3W**

■ Features

- Low-profile 0.95 mm (1.1 mm max.)
- High reliability realized by cermet element
- Excellent mountability
- Conforms to JIS C5260-1:1999

■ Recommended Applications

- Audio/visual, office, and communication equipment
- General electronic equipment

■ Explanation of Part Numbers

1	2	3	4	5	6	7	8	9	10	11	12
E	V	M	3	W	S	X	8	0	B	5	2
Product Code			Type/Structure		Packaging			Taper & Resistance			
Example : B52=500 Ω											

■ Specifications

Total Resistance Value	100 Ω to 1 MΩ
Resistance Tolerance	±25 %
Power Rating	0.15 W
Maximum Operating Voltage	50 V
Rotation Torque	2 to 20 mN·m
Temperature Coefficient of Resistance	±250 × 10 ⁻⁶ /°C

■ Minimum Quantity/Packing Unit

Part Number	Taping		
	Quantity per reel	Packaging quantity	Dia. of reel (mm)
EVM3W	3000	15000	φ178

The standard packaging methods for a reel is φ178.

Please contact us, if you would like different packaging methods. (Bulk, Reel of φ330, Reel of φ380)

■ Dimensions in mm (not to scale)

- 3-terminal/Low-profile

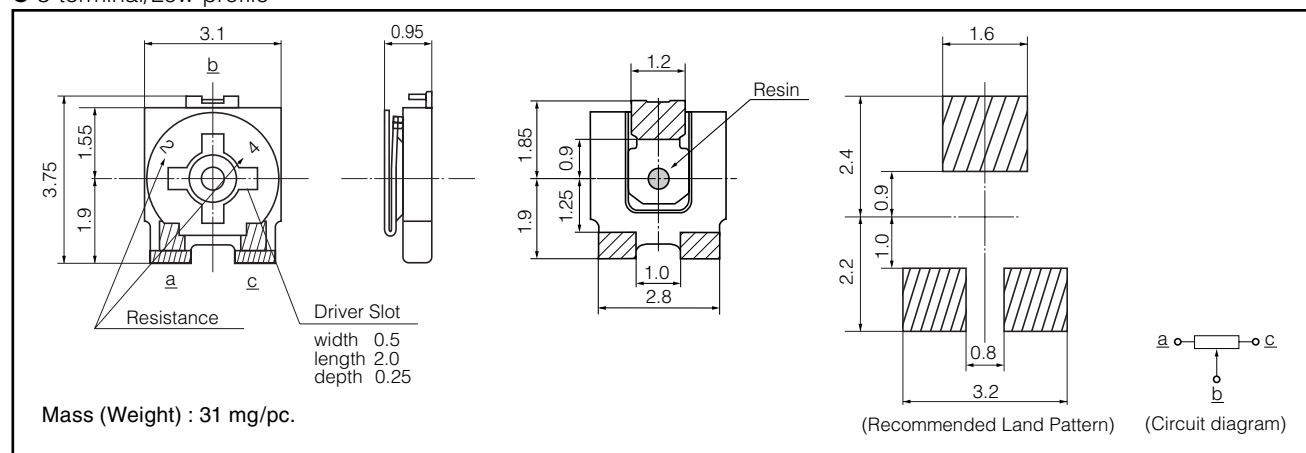

■ Explanation of Part Numbers

1

E

2

V

3

4

5

6

S

7

8

9

0

10

B

11

12

Product Code

Type/Structure

Packaging

Taper

Resistance

6th

7th

Packaging

S

X

Carrier tape
(7th: Direction of insertion.
Refer to Packaging Specifications)

W

* The standard of direction of insertion is a direction X.
EVM2T/2N type be only direction X.

8th

Quantity

Type

3

1000

EVM1D,EVM1E,EVM1U

5

2000

EVM3Y,EVM3S,EVM3R,
EVM3V,EVN5E,EVN5C

8

3000

EVM2T,EVM2N,EVM2W,
EVM3W

Classification	Type	Symbol(1th to 5th)
Cermet	2 mm Open	EVM2T, EVM2N, EVM2W (low-profile)
	3 mm Open	EVM3Y, EVM3S EVM3R, EVM3W(low-profile) EVM3V(with rotation stopper)
	4 mm Open	EVM1D, EVM1E EVM1U
Carbon	3 mm Dustproof	EVN5E(with rotation stopper) EVN5C

Symbol	Resistance	EVM2T EVM2N EVM2W EVM3Y EVM3S EVM3W EVM3V EVM1D EVM1E EVM1U	EVM3R	EVN5E EVN5C
12	100 Ω	○	—	—
C2	150 Ω	○	—	—
22	200 Ω	○	—	○
E2	220 Ω	○	—	○
32	300 Ω	○	—	○
Y2	330 Ω	○	—	○
Q2	470 Ω	○	—	○
52	500 Ω	○	○	○
S2	680 Ω	○	○	○
13	1 kΩ	○	○	○
C3	1.5 kΩ	○	○	○
23	2 kΩ	○	○	○
E3	2.2 kΩ	○	○	○
33	3 kΩ	○	○	○
Y3	3.3 kΩ	○	○	○
Q3	4.7 kΩ	○	○	○
53	5 kΩ	○	○	○
S3	6.8 kΩ	○	○	○
14	10 kΩ	○	○	○
C4	15 kΩ	○	○	○
24	20 kΩ	○	○	○
E4	22 kΩ	○	○	○
34	30 kΩ	○	○	○
Y4	33 kΩ	○	○	○
Q4	47 kΩ	○	○	○
54	50 kΩ	○	○	○
S4	68 kΩ	○	○	○
15	100 kΩ	○	○	○
C5	150 kΩ	○	○	○
25	200 kΩ	○	○	○
E5	220 kΩ	○	○	○
35	300 kΩ	○	○	○
Y5	330 kΩ	○	○	○
Q5	470 kΩ	○	○	○
55	500 kΩ	○	○	○
S5	680 kΩ	○	○	○
16	1 MΩ	○	○	○

11th

Significant Number of resistance

12th

Number of zero

11th	Significant number
C	1.5
E	2.2
Y	3.3
Q	4.7
S	6.8

When significant number is odd, letters are assigned as shown above.

Mouser Electronics

Authorized Distributor

Click to View Pricing, Inventory, Delivery & Lifecycle Information:

Panasonic:

[EVM-2TSX80B12](#) [EVM-2TSX80B13](#) [EVM-2TSX80B14](#) [EVM-2TSX80B15](#) [EVM-2TSX80B16](#) [EVM-2TSX80B22](#)
[EVM-2TSX80B23](#) [EVM-2TSX80B24](#) [EVM-2TSX80B25](#) [EVM-2TSX80B52](#) [EVM-2TSX80B53](#) [EVM-2TSX80B54](#) [EVM-](#)
[2TSX80B55](#) [EVM-2WSX80B32](#) [EVM-3VSX50B55](#) [EVM-3WSX80B25](#) [EVM-3WSX80B55](#)