

THE INFORMATION CONTAINED IN THIS DRAWING IS THE SOLE PROPERTY OF ANDERSON POWER PRODUCTS. ANY REPRODUCTION IN PART OR WHOLE WITHOUT THE WRITTEN PERMISSION OF ANDERSON POWER PRODUCTS IS PROHIBITED.

Copyright 2012

ANDERSON POWER PRODUCTS RESERVES THE RIGHT TO ALTER PRODUCT TYPES, THEIR TECHNICAL DATA, DIMENSION, STYLE AND ACCESSORIES WITHOUT PRIOR NOTIFICATION.

# COMPONENTS INCLUDED

ITEM	QTY	DESCRIPTION
1	1	PLUG HOUSING WITH LATCHES
2	1	PLUG HOLDER FOR PP75
3	2	M3.5 SELF-TAPPING SCREWS

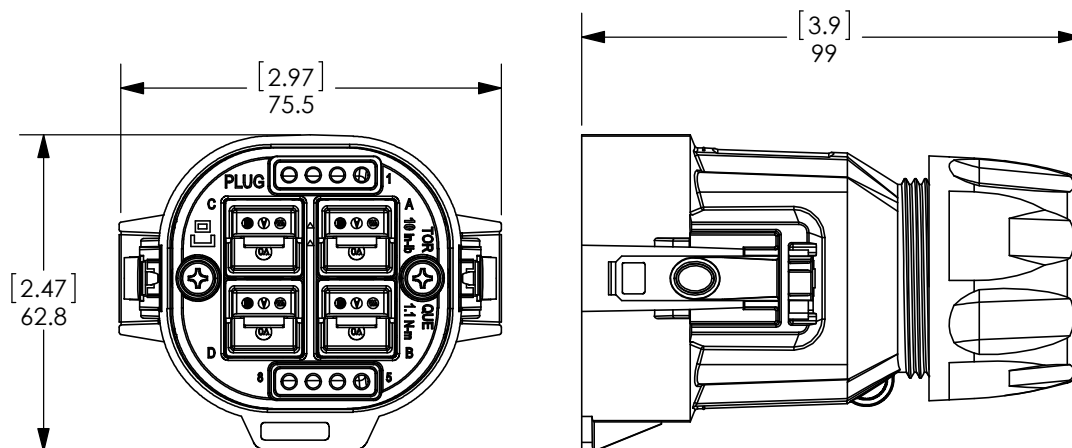
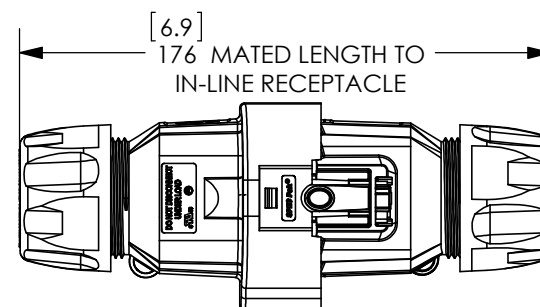
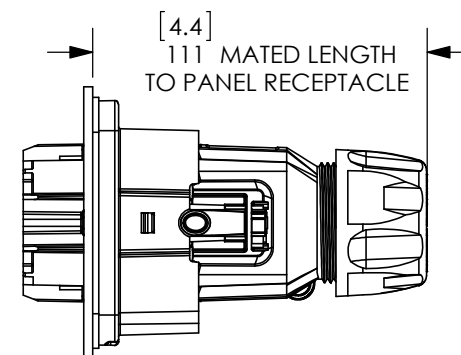
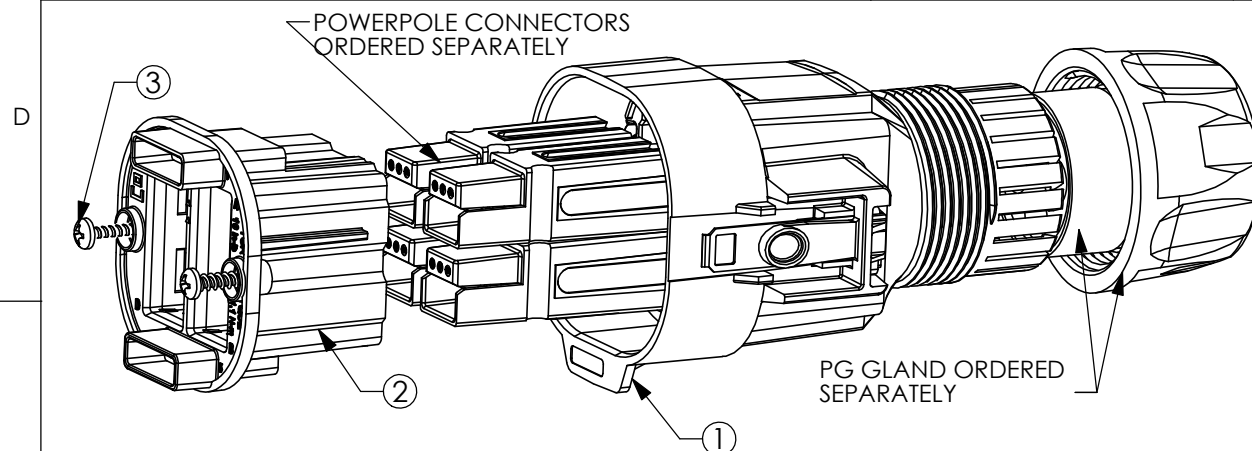

## KIT PART NO. SK6-076C04

### NOTES:

- MATERIALS:
  - PLUG HOUSING AND HOLDER- PBT BLACK
  - LATCHES- STAINLESS STEEL
- FOR USE WITH PP75 CONTACTS AND HOUSINGS (ORDERED SEPARATELY)
- HOLDER ACCEPTS UP TO EIGHT POWERMOD® PIN CONTACTS (ORDERED SEPARATELY)
- REFER TO ASSEMBLY INSTRUCTIONS (1S6577)

DIMENSIONS ARE IN:	MM [INCH]	APPROVALS		ANDERSON POWER PRODUCTS		
UNLESS OTHERWISE STATED		DRAWN		TITLE MID POWER SPEC PAK PLUG KIT		
TOLERANCES:		CMS	5/23/2012			
DECIMALS (INCH)	DECIMALS (MM)	CHECKED				
.XX ± .02	.X ± .5	LLD	5/24/2012			
SURFACE FINISH:		MFG APPRV		SIZE A		
MACHINED	3.2µ [128µin]	CHB	5/24/2012			
MOLDED	1.6µ [64µin]	QC APPRV				
MATERIAL: SEE DATA SHT.		UFN	5/24/2012	DWG NO. 115161S1		
FINISH:		ENG APPRV				
		BD	5/24/2012	REV. 0		
3rd ANGLE PROJECTION		-CAD GENERATED DRAWING- DO NOT MANUALLY UPDATE DO NOT SCALE		SCALE NONE	CADFILE 03713	SHEET 1 OF 1

REV.	DESCRIPTION	APPRV	DATE
REVISIONS			