

TT41NGPC9T1/4 Product Details

[Share](#) [Print](#) [Email](#)

TT41NGPC9T1/4

TE Internal Number: 6-1437562-8

 **Active**

Toggle Switches

 Always EU RoHS/ELV Compliant (Statement of Compliance)

Product Highlights:

- TT (Tiny) Series
- Four Pole - Double Throw Configuration (Pole-Throw)
- Current Rating = 0.4 VA A
- Mount Style = Through-Hole
- Termination Type = Printed Circuit, Vertical

[View all Features](#)

Quick Links

- ▶ [Pricing & Availability](#)
- ▶ [Search for Tooling](#)
- ▶ [Product Feature Selector](#)
- ▶ [Contact Us About This Product](#)

[Add to My Part List](#)

[Request Sample](#)

[Find Similar Products](#)

[Buy Product](#)

Documentation & Additional Information

Product Drawings:

- None Available

Catalog Pages/Data Sheets:

- None Available

Product Specifications:

- None Available

Application Specifications:

- None Available

Instruction Sheets:

- None Available

CAD Files:

- None Available

Additional Information:

- [Product Line Information](#)

Additional Product Images:

- [Product Photo](#)
- [Dimensional Drawing](#)

Related Products:

- [Tooling](#)

Product Features (Please use the Product Drawing for all design activity)

Product Type Features:

- Series = TT (Tiny)
- Termination Type = Printed Circuit, Vertical
- Color = Black

Electrical Characteristics:

- Current Rating (A) = 0.4 VA

Termination Features:

- Seal Type = Terminal Seal (epoxy)

Body Features:

- Mount Style = Through-Hole
- Bushing Style = Threaded
- Bushing Type = 1/4-40

Contact Features:

- Contact Plating = Gold over Nickel
- Contact Base Material = Copper Alloy

Housing Features:

- Toggle Style = Baton Long
- Toggle Length (mm [in]) = 10.40 [0.410]
- Process Sealed = No
- UL Flammability Rating = UL 94V-0

Configuration Features:

- Configuration (Pole-Throw) = Four Pole - Double Throw
- [Operating Function](#) = On None On

Industry Standards:

- [RoHS/ELV Compliance](#) = RoHS compliant, ELV compliant
- [Lead Free Solder Processes](#) = Wave solder capable to 260°C, Wave solder capable to 240°C, Wave solder capable to 265°C
- RoHS/ELV Compliance History = Always was RoHS compliant

Other:

- Brand = Alcoswitch

Corporate Information

[About TE](#)
[Investors](#)
[News Room](#)
[Supplier Portal](#)
[Careers](#)
[Terms & Conditions](#)
[Privacy Policy](#)

Quick Links

[Distributor Inventory](#)
[Product Cross Reference](#)
[Documents & Drawings](#)
[Product Compliance Support Center](#)
[Site Map](#)

Customer Support

[Email or Chat With Us](#)
[Find a Phone Number](#)
[Knowledge Base](#)
[Manage Your Account](#)

Keep Me Informed



A technical drawing of a mechanical assembly, likely a valve or a pump component, shown in a cross-sectional view. The drawing includes 14 numbered callouts pointing to various parts:

- 1: A small circular component at the bottom right.
- 2: A vertical rod or pin passing through the assembly.
- 3: A horizontal rod or pin passing through the assembly.
- 4: A vertical rod or pin passing through the assembly.
- 5: A horizontal rod or pin passing through the assembly.
- 6: A vertical rod or pin passing through the assembly.
- 7: A horizontal rod or pin passing through the assembly.
- 8: A vertical rod or pin passing through the assembly.
- 9: A horizontal rod or pin passing through the assembly.
- 10: A vertical rod or pin passing through the assembly.
- 11: A horizontal rod or pin passing through the assembly.
- 12: A vertical rod or pin passing through the assembly.
- 13: A horizontal rod or pin passing through the assembly.
- 14: A vertical rod or pin passing through the assembly.

Specifications—see note 3				
Current rating UL & CSA	6A @ 125 VAC (resistive)			
	3A @ 250 VAC (resistive)			
	4A @ 28 VDC (resistive)			
Termination resistance	20 milliohms max @ 2–4 VDC, 1A			
Insulation resistance	1,000 megohms min.			
Withstanding voltage	1,000 VAC			
Travel	24 +/–6 degrees			
Actuation force	.05 to 1.5 kgf			
Operating temperature	–20C to +85C			
Storage temperature	–40C to +85C			
Contact timing	break before make			
Terminal seal	epoxy or insert molded			
Durability	Parameter	2 Position	3 Position	Momentary
	mechanical (no load)	150,000	100,000	80,000
	250 VAC (3A resistive)	80,000	60,000	60,000
	125 VAC (6A resistive)	80,000	60,000	60,000
	28 VDC (4A resistive)	60,000	50,000	40,000

RECOMMENDED HOLE LAYOUT TO PREVENT ROTATION	TO PREVENT ROTATION

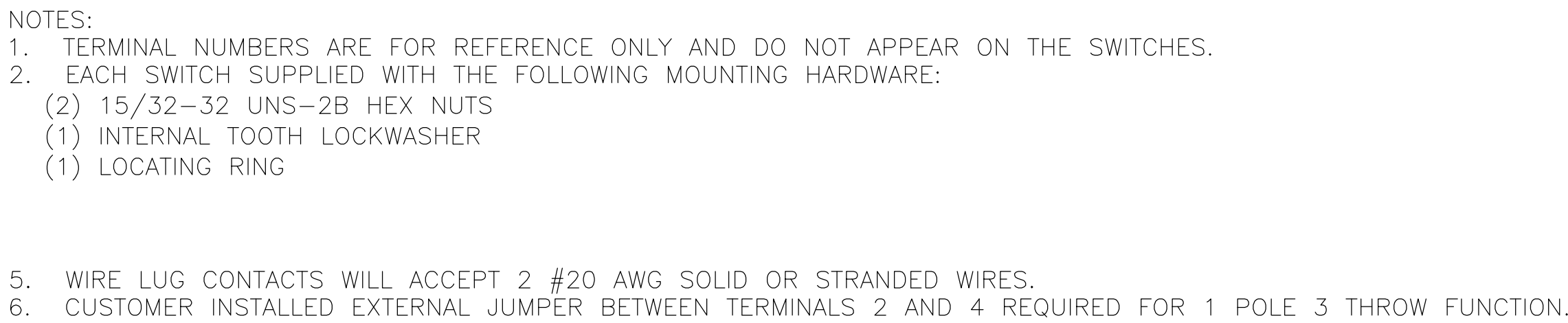

LOC	DIST	REVISIONS				
		REV	LTR	DESCRIPTION	DATE	APP'D
AD	00	—	—	SEE SHEET 1	—	—

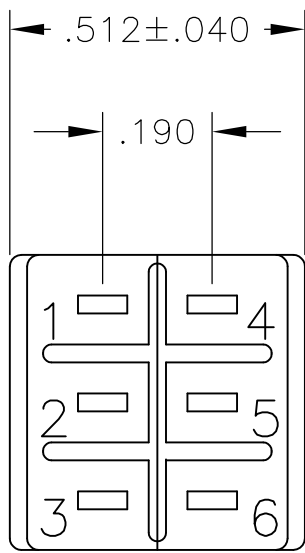
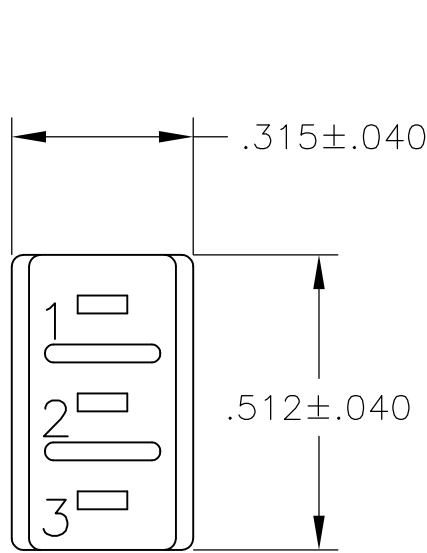
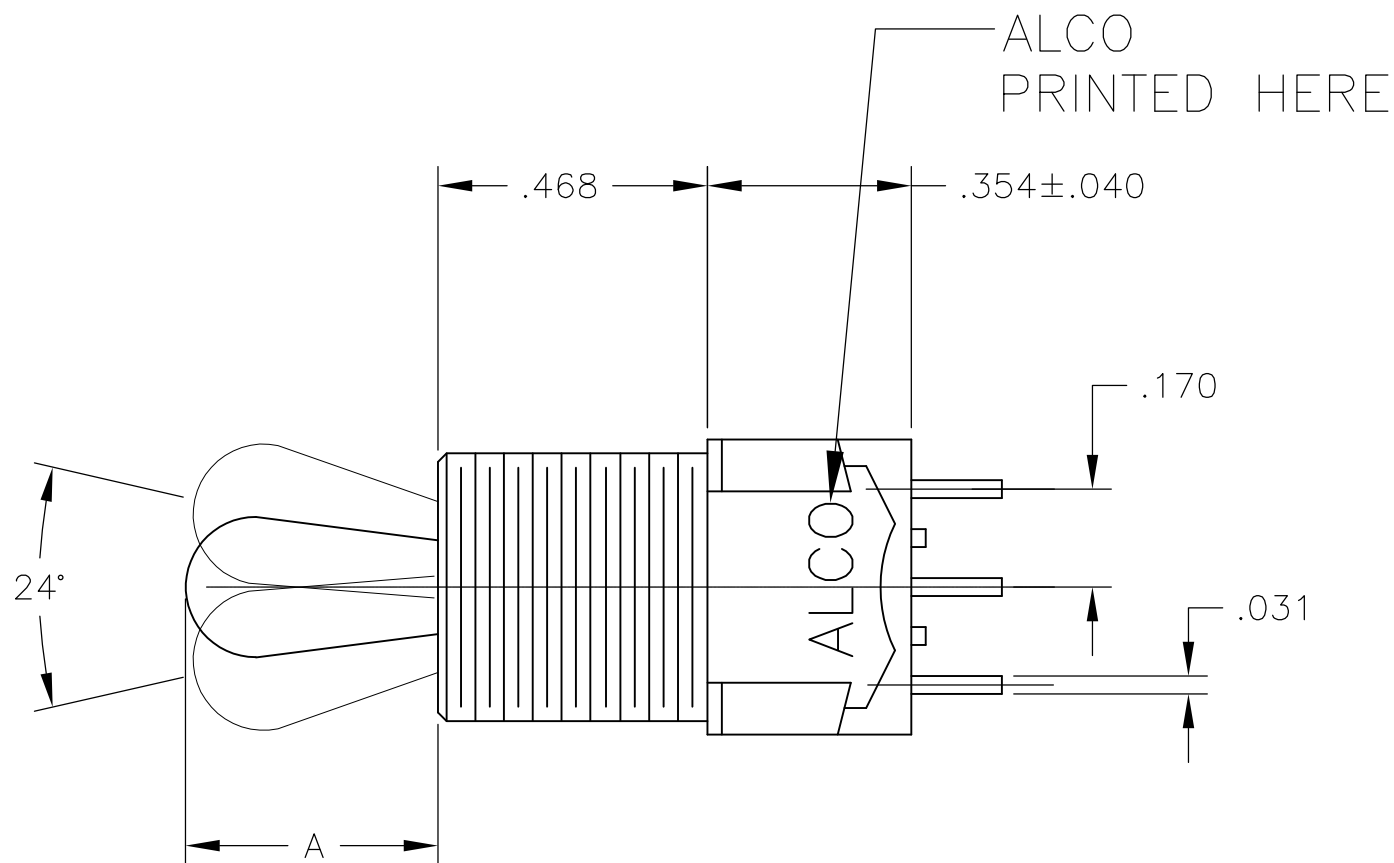

MTG-106

MTG-206

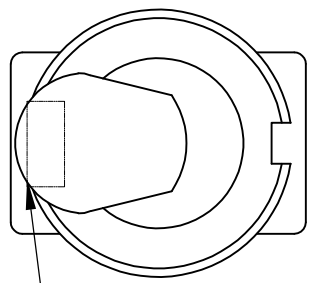

COUNTRY OF ORIGIN
STAMPED HERE
EXISTING
SWITCHES ONLY

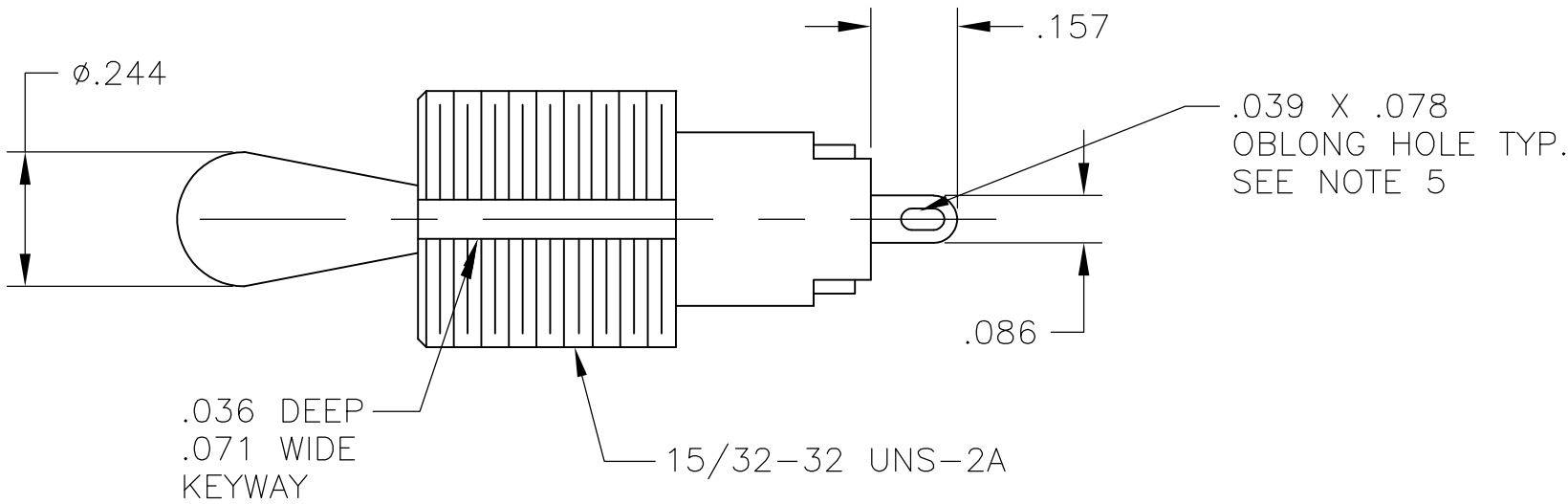

WIRE LUG TERMINAL

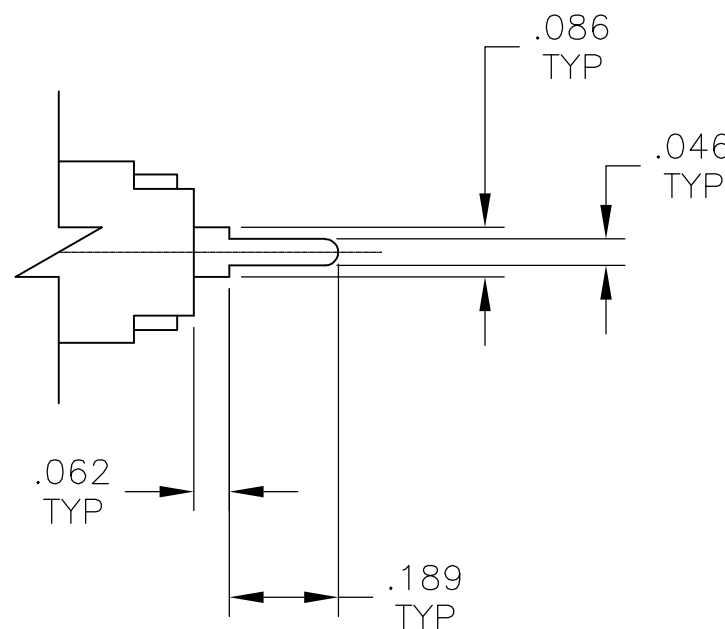

PC TERMINAL

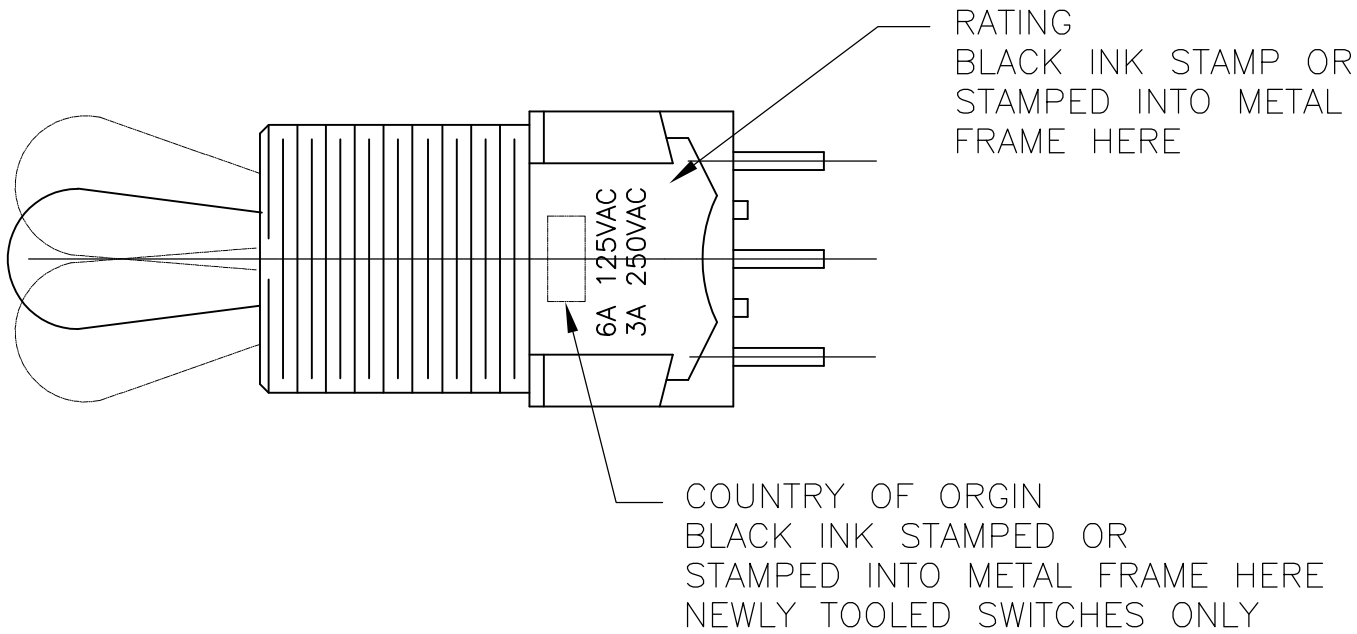

THIS DRAWING IS A CONTROLLED DOCUMENT.		DWN M. BINNER	29DEC03	TE Connectivity	
		CHK M. ZITTO	29DEC03		
DIMENSIONS: INCHES	TOLERANCES UNLESS OTHERWISE SPECIFIED:	AP'D M. ZITTO	29DEC03	NAME	
		PRODUCT SPEC		TOGGLE SWITCH, MTG SERIES VERTICAL MOUNT	
	0. PLC ± . 1. PLC ± . 2. PLC ± . 3. PLC ± .005 4. PLC ± . ANGLES ± .	APPLICATION SPEC		SIZE	
				CAGE CODE	
MATERIAL	FINISH	WEIGHT		DRAWING NO	
—	—	—		RESTRICTED TO	
CUSTOMER DRAWING			SCALE	3:1	SHEET 2 OF 3
			REV D4		

LOC	DIST	REVISIONS				
AD	00	REV	LTR	DESCRIPTION	DATE	DWN
				SEE SHEET 1		

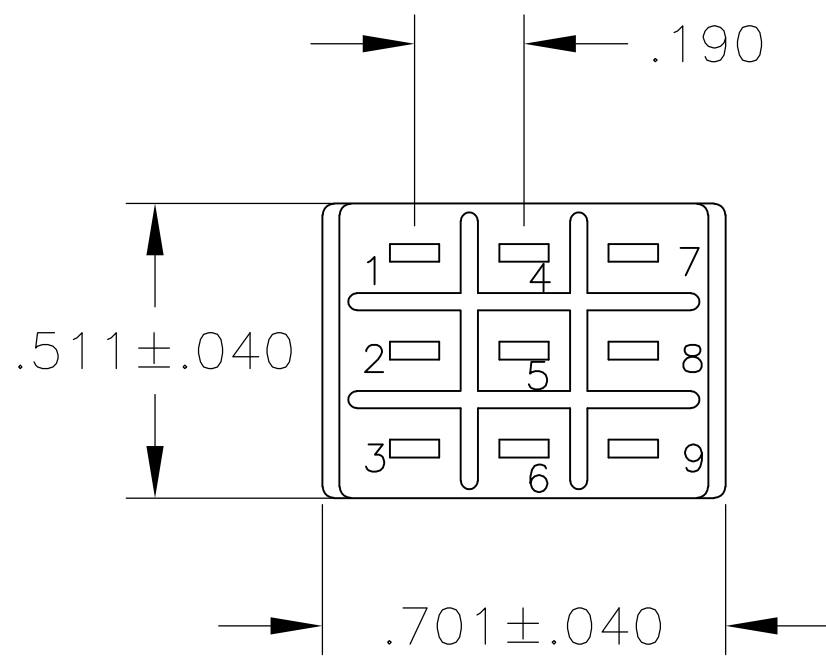
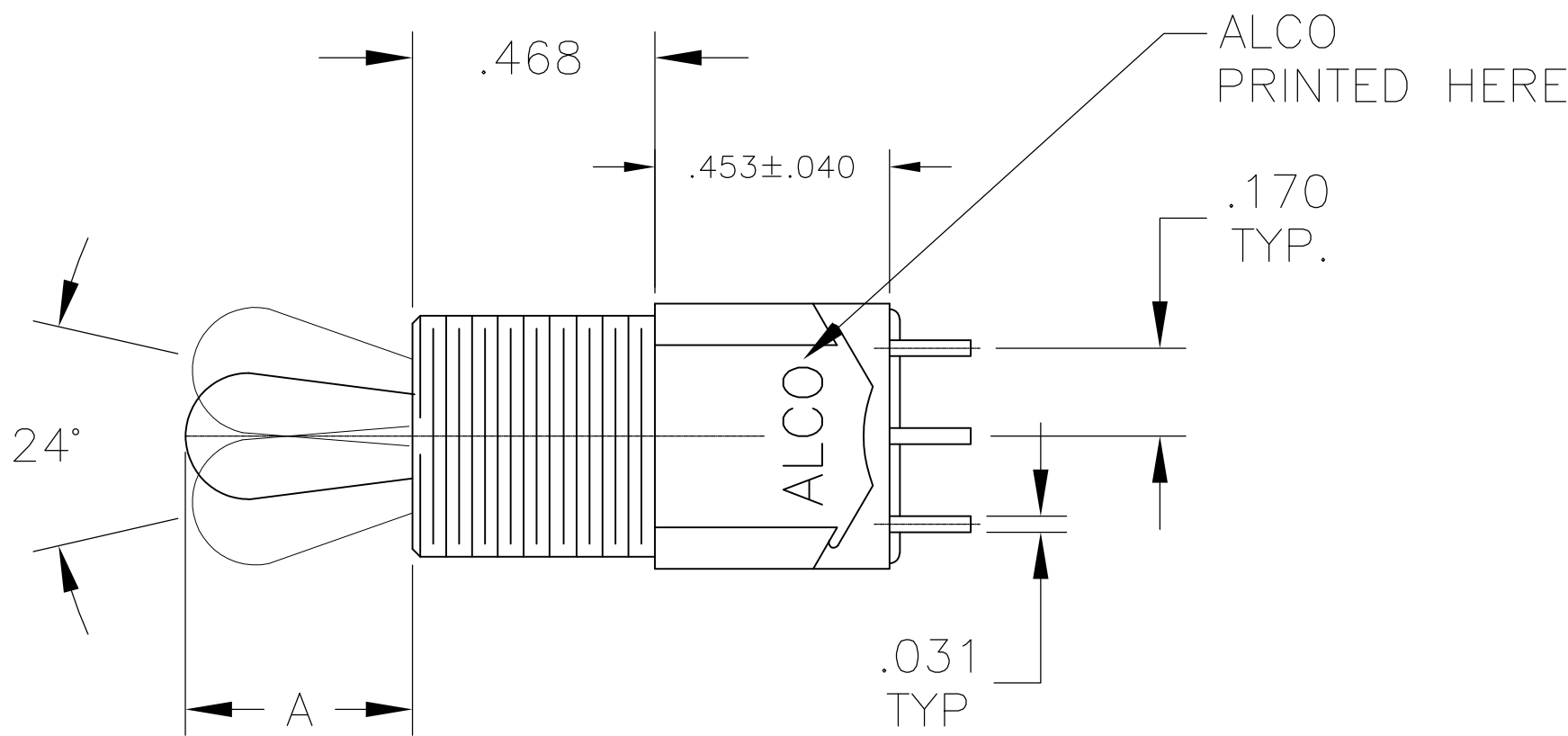

MTG-306

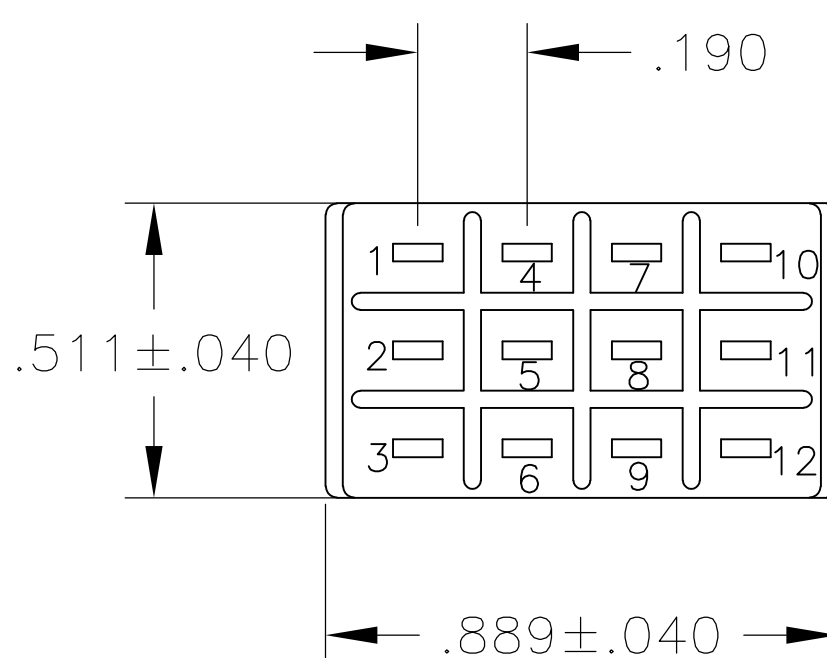

MTG-406

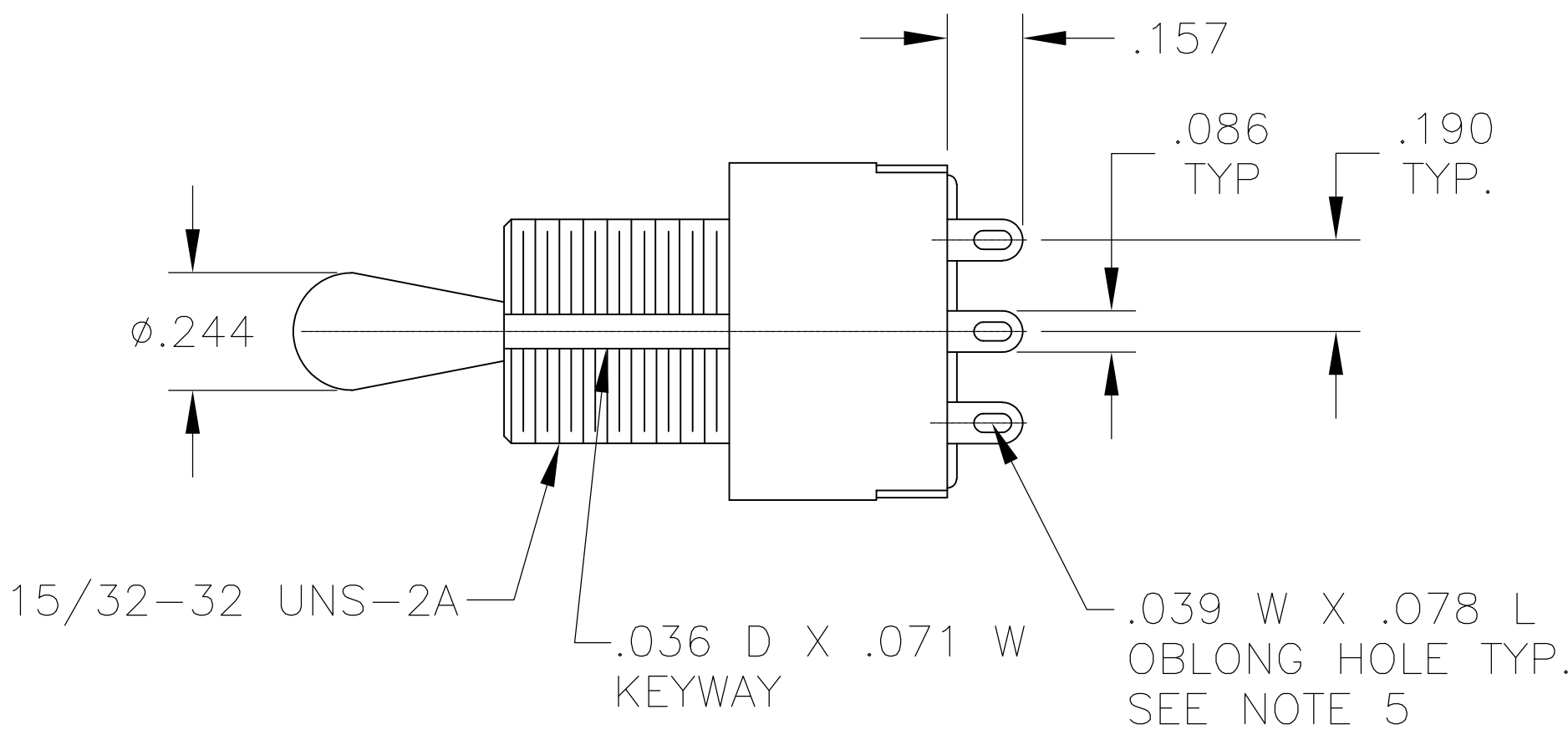
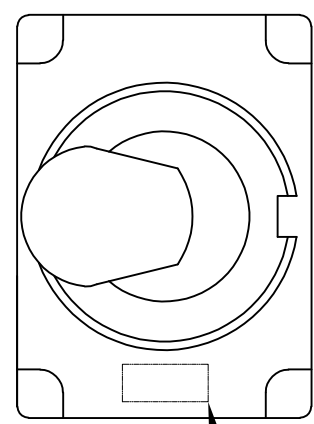

WIRE LUG TERMINAL

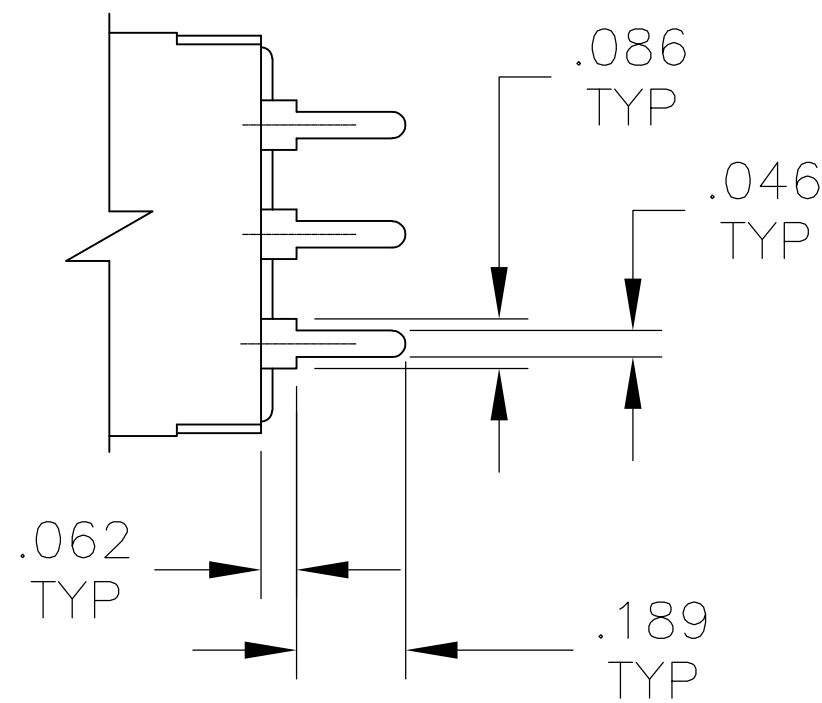

PC TERMINAL

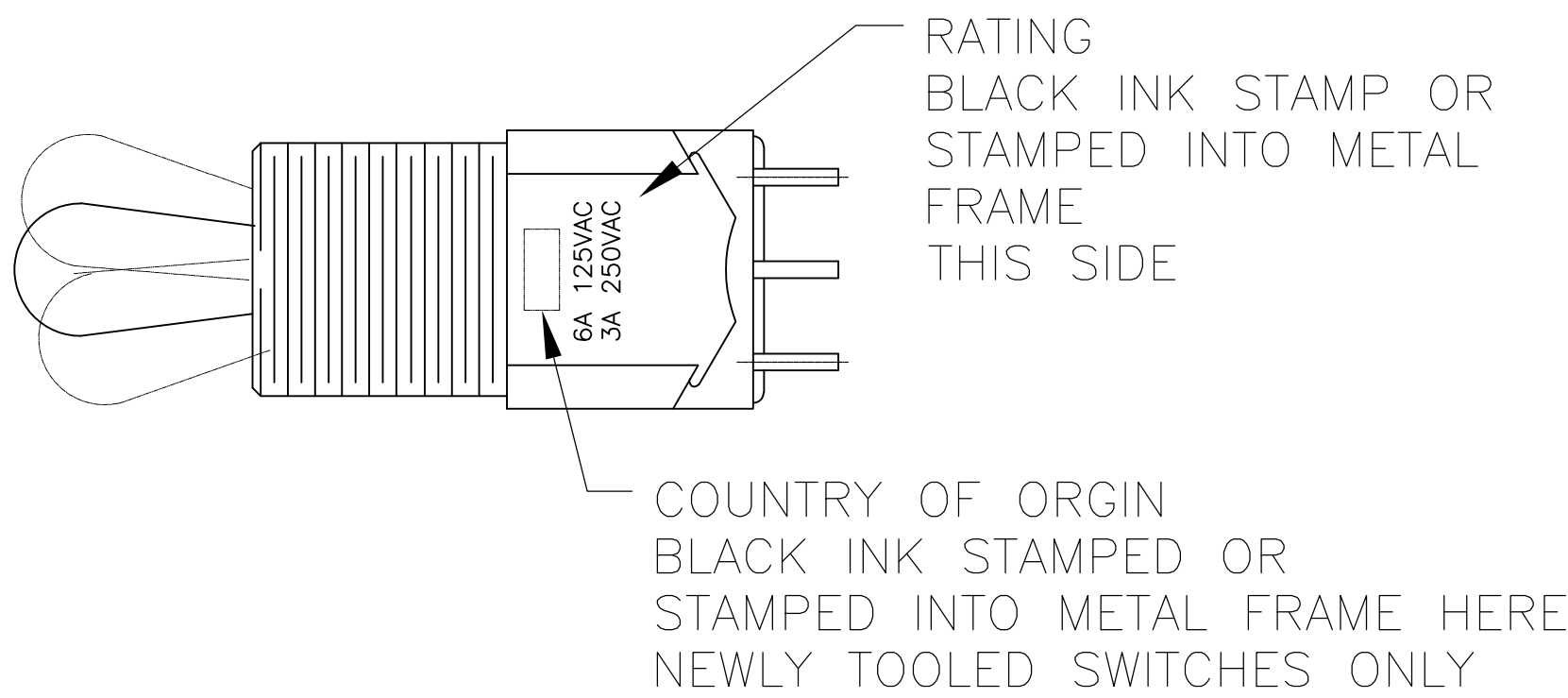

THIS DRAWING IS A CONTROLLED DOCUMENT.		DWN M. BINNER 29DEC03	TE Connectivity	
DIMENSIONS: INCHES		CHK M. ZITTO 29DEC03		
TOLERANCES UNLESS OTHERWISE SPECIFIED:		APPROD M. ZITTO 29DEC03	NAME TOGGLE SWITCH, MTG SERIES VERTICAL MOUNT	
0. PLC ± .005 1. PLC ± .005 2. PLC ± .005 3. PLC ± .005 4. PLC ± .005 ANGLES ± .005		PRODUCT SPEC APPLICATION SPEC WEIGHT	SIZE CAGE CODE DRAWING NO RESTRICTED TO	
MATERIAL		FINISH	A1 00779 1-1437559-1	
CUSTOMER DRAWING		SCALE 3:1	SHEET 3 OF 3	
			REV D4	