

SERIES:

MGDH2

COEV
MAGNETICS

tyco Electronics

3003 9th Avenue SW
PO Box 50
Watertown, SD 57201
Toll free: 888-978-2638
Ph: 605-886-3326
Fax: 605-886-8995



Shielded, Low Profile, Power Inductors

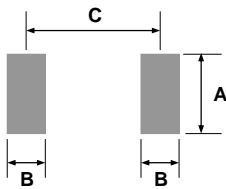

Suggested Land Pattern

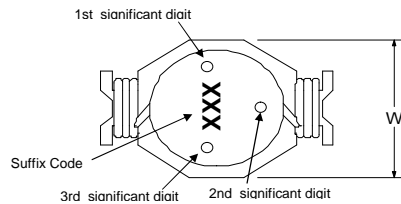

Parts will be marked with Significant Digit Dots OR Suffix code

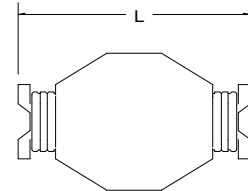
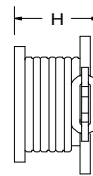

Series Number	Maximum Dimensions			Reference Dimensions		
	Units	L	W	H	A	B
MGDH2	inches	0.522"	0.392"	0.250"	0.160"	0.060"
	mm	[13.26]	[9.96]	[6.35]	[4.06]	[1.52]

Features:

- High energy storage and low resistance
- Reliable surface mounting, flat top for pick and place.
- Smaller real estate than other common inductors.
- Robust temperature deflection to prevent damage during solder reflow.
- Tape and Reel mechanical specifications available upon request.
- Operating Temperature -40°C to +85°C.
- Highly resistive core for EMI suppression applications.

Notes:

- Inductance measured at 100kHz and 100mVrms.
- Isat is a maximum applied AC + DC current.
- Isat current is applied to produce a typical 10% drop in nominal inductance.
- Irms current is applied to produce a typical 40°C temperature rise.
- Tolerance suffix of M = ±20%.
- DCR is a maximum at 20°C.



Terminal Plating is Hot-dipped SnAgCu
260°C Maximum reflow temperature per J-STD020

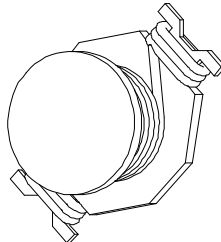
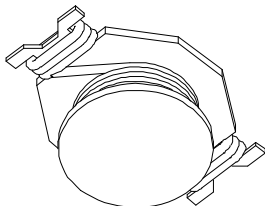
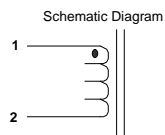

Contact CoEv for additional inductance values

Lead-free Part Number	L μH	MGDH2			
		DCR W	Isat A	Irms	Tolerance Suffix
MGDH2-00001	0.33	0.002	20.0	16.0	M
	0.56				
MGDH2-00002	0.68	0.005	13.0	12.0	M
	0.78				
MGDH2-00003	1.0	0.006	11.0	10.0	M
	1.2				
MGDH2-00004	1.5	0.008	9.0	9.0	M
MGDH2-00005	2.2	0.011	7.8	7.4	M
MGDH2-00006	2.7	0.012	7.0	6.6	M
MGDH2-00007	3.3	0.014	6.4	5.9	M
	3.9				
MGDH2-00008	4.7	0.018	5.4	4.8	M
	6.0				
MGDH2-00009	6.8	0.035	3.6	4.5	M
	7.8				
MGDH2-00010	10	0.040	3.30	4.50	M
MGDH2-00011	15	0.060	2.40	3.50	M
MGDH2-00012	22	0.080	2.00	2.80	M
MGDH2-00013	33	0.150	1.70	2.10	M
MGDH2-00014	47	0.280	1.40	1.70	M
MGDH2-00015	68	0.300	1.20	1.50	M
MGDH2-00016	100	0.400	0.95	1.20	M

Specifications subject to change

Call Toll Free: 888-978-2638 Website: www.tycopowercomponents.com

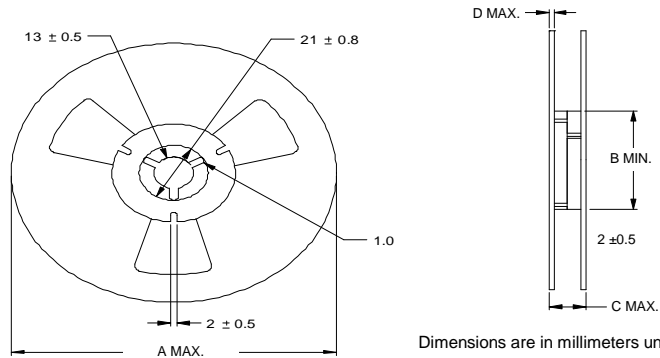

Series Number	Reel dimensions					Reel Qty	Carton (Box) Qty.	Packaging Specification
	Units	A	B	C	D			
MGDH2	in.	14.17"	3.94"	1.20"	0.098"	700	3500	90-0055
	[mm]	[360]	[100.0]	[30.4]	[2.50]			

PACKAGING NOTE: Only pressure sensitive cover tape is to be used.

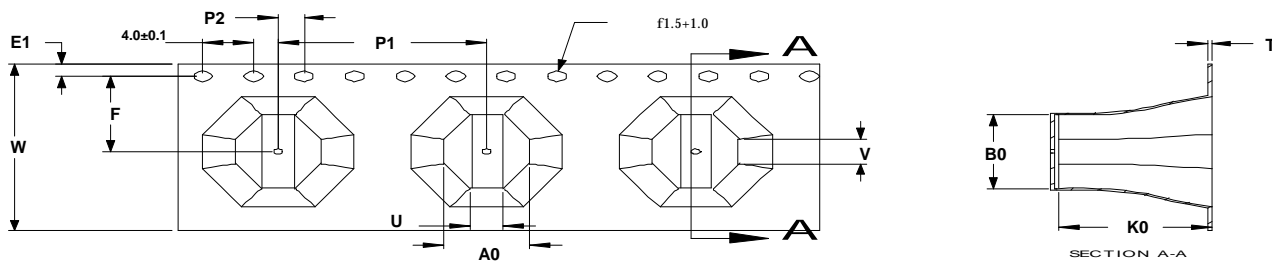
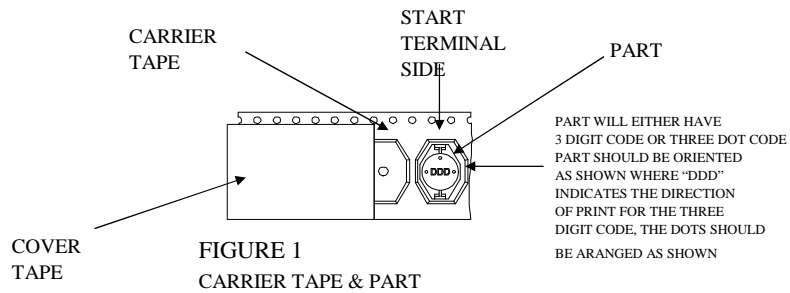

Series	A0 ± 0.1	U ± 0.1	V ± 0.1	P1 ± 0.1	P2 ± 0.1	W ± 0.3	F ± 0.1	E1 ± 0.1	B0 ± 0.1	K0 ± 0.05	T ± 0.05
MGDH2	10.30	5.80	4.00	16.00	2.00	24.00	11.50	1.75	13.50	5.70	0.35



Customer Packaging Specifications
For Print Distribution to Customers

Series	Revision
MGDH2	A0
Sheet 2 of 7	

Item	Specification	Test Method/Condition				
Environmental						
Static Humidity	After exposure part remains within specified electrical parameters for L, Q and DCR.	Precondition at 25°C for 60 minutes. Expose parts to an environment of +40°C with 90 to 95% R.H. for 240 hours.				
Storage Life	After exposure part remains within specified electrical parameters for L, Q and DCR.	Subject parts to an environment of 85°C 85% R.H. for 168 hours. After exposure allow parts to dry for 4 hours before measurements are taken.				
Temperature Cycle	After exposure part remains within specified electrical parameters for L, Q and DCR.	10 cycles (Air to Air) 1 cycle shall consist of: 30 minutes exposure to +85°C 30 minutes exposure to -40°C Allow 20 minutes transition between extremes.				
Temperature Shock	After exposure part remains within specified electrical parameters for L, Q and DCR.	10 cycles (Air to Air) 1 cycle shall consist of: 30 minutes exposure to -55°C 30 minutes exposure to +125°C 15 seconds maximum transition between temperatures				
General						
Storage Temperature Range	-40°C to +85°C					
Operating Temperature Range	-40°C to +85°C					
Flammability	IEC 695-2-2	Withstands needle-flame test				
Other						
Vibration	After exposure part remains within specified electrical parameters for L, Q and DCR.	1 cycle of 30 minutes of the following: 5 - 7 Hz constant displacement of 0.75 inches, 5 minutes 7 - 30 Hz constant acceleration of 1.5 Gs, 10 minutes 31 - 50 Hz constant displacement of 0.33 inches, 5 minutes 50 - 500 Hz constant acceleration of 1.2 Gs, 10 minutes				
Mechanical Shock	After exposure part remains within specified electrical parameters for L, Q and DCR.	MGDH1 Series - 2000 Gs per axis, 2 directions MGDH2 Series - 2000 Gs per axis, 2 directions MGDH3 Series - 2000 Gs per axis, 2 directions				
Solderability		Dip pads in RMA flux, 63/37 solder (Sn/Pb) at 232°C for 5 seconds ±2 seconds.				
	Wetting shall cover 90% minimum of each termination					
Component Adhesion (Push Test)	Component shall withstand 6 lb. push force minimum without delaminating from mounting surface.	Apply and measure force with a digital force gauge set.				
Resistance to Solvent		Withstands 6 minutes of alcohol.				
		Withstands 3 minutes forced spray Freon TMS				
Chemical						
Ionic Contamination	Conductivity: pH: Chlorides: Sodium: Potassium:	11 µOhms/cm maximum 5.5 to 9 65 ppm maximum 20 ppm maximum 10 ppm maximum				
For Print Distribution to Customers		<div><div><div><div></div><div>Pb</div></div><div>RoHS Compliant</div></div></div>				
		<table><tr><th>Series</th><th>Revision</th></tr><tr><td>MGDH2</td><td>A0</td></tr></table>	Series	Revision	MGDH2	A0
		Series	Revision			
MGDH2	A0					
Sheet 3 of 7						