

Safety Interlock Switches

T5007



Compact Universal Tongue-Operated Safety Interlock Switch

- Strong and versatile—the compact size of the strong, glass-filled polyester housing can be used in many applications
- NEMA 6 enclosure enables these switches to withstand water washdown cleaning
- Rotatable head gives four possible actuator entry points for versatile installation. A blanking plug is supplied for the unused entry.
- Small swing radius allows use on doors with a swing radius as small as 64 mm (2.5 in.) when using the optional flexible 1 actuator with alignment guide
- Vibration resistant—optional catch and retainer keeps vibrating guard doors shut, preventing unwanted opening of guard doors on vibrating machines
- Long life—these switches, with their stainless steel actuators, are designed for a minimum of one million actuations
- Optional connector makes installation quick and easy
- An optional stainless steel head is available



G



Conforms to EN1088, EN292,
EN60947-5-1, EN60204-1
UL and C-UL listed

Specifications

Electrical	All Models
Contact Configurations:	2 N/C or 1 N/C + 1 N/O
Safety Contacts:	2 N/C or 1 N/C positive break
Switching Ability	AC: 500 V – 1 A, 250 V – 2 A, 100 V – 5 A DC: 250 V – 0.5 A, 24 V – 2 A
Safety Contact Gap:	> 2 mm (0.079 in.)
Auxiliary Contacts:	1 N/O (only with 1 N/C safety version)
Max Switching Current/Volt/Amp:	500 V/500 VA
Minimum Current:	5 V 5 mA DC
Electrical Life:	1 x 10 ⁶ minimum
Mechanical	
Mounting:	Any position
Mounting Hardware:	2 x M5 screws
Actuator Travel for Positive Opening:	6 mm (0.236 in.)
Min Operating Radius:	60 mm (2.5 in.) with Flex 1 actuator; 175 mm (6.89 in.) with standard actuator
Break Contact Min Force:	30 N (6.7 lb.)
Max Actuation Speed:	160 mm/sec (6.30 in./sec)
Max Actuation Frequency:	2 cycles/sec
Case Material:	UL listed, glass-filled polybutylene terephthalate (PBT), optional stainless steel head
Actuator Material:	Stainless steel
Wiring Entry:	3 x M20 conduit with 0.5 in. NPT adapter, or Brad Harrison connector type BG 16881-008, 4 pole male, M12
Weight:	120 g (4 oz.)
Color:	Red
Mechanical Life:	1 x 10 ⁶ minimum
Environmental	
Protection:	IP67 (NEMA 6)
Operating Temperature:	-20 to 80°C (-4 to 176°F)
Cleaning:	Water washdown
Compliance	
Standards:	EN1088, EN292, EN60947-5-1, EN60204-1
Approvals/Listings:	CE marked for all applicable directives, UL and C-UL

Specifications are subject to change without notice.

Note: The safety contacts of the Omron STI switches are described as normally closed (N/C)—i.e., with the guard closed, actuator in place, and the machine able to be started.

Operation

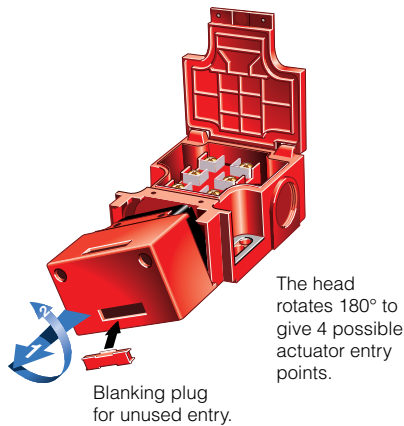

Optional Catch & Retainer

The catch and retainer is used to keep guards on vibrating machinery closed. Holding force = 50 N (11.2 lbs.).

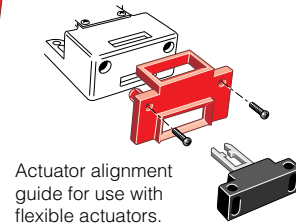
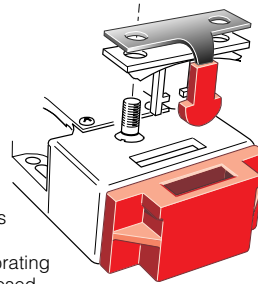

Optional Alignment Guide & Flexible Actuators

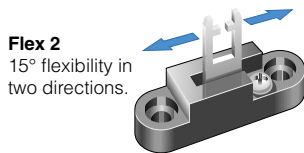
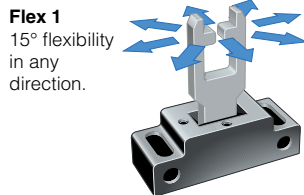

Optional SLD Series

Optional switch locking devices are available. See accessories section for details.



Optional Connector

4-Pin Male, Micro DC, M12
Safety Circuit 1 (N/C)

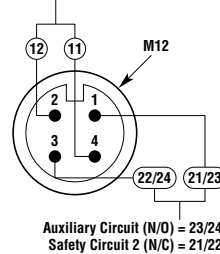

Contact Arrangements

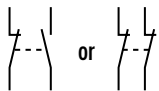

Actuator withdrawal distance from full insertion

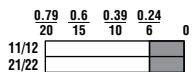

□ Contact Open ■ Contact Closed

Actuator withdrawal distance from full insertion: type BBM (Break Before Make Contact)

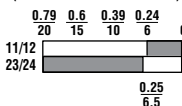

□ Contact Open ■ Contact Closed

Minimum Operating Radius Front-Entry (Std Actuator)

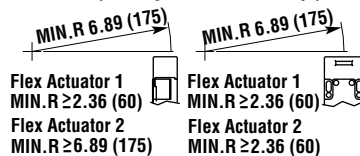

Minimum Operating Radius End-Entry (Std Actuator)

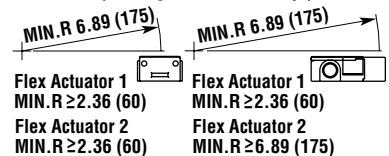

Applications

Typical applications are on sliding guard doors or swinging guard doors.

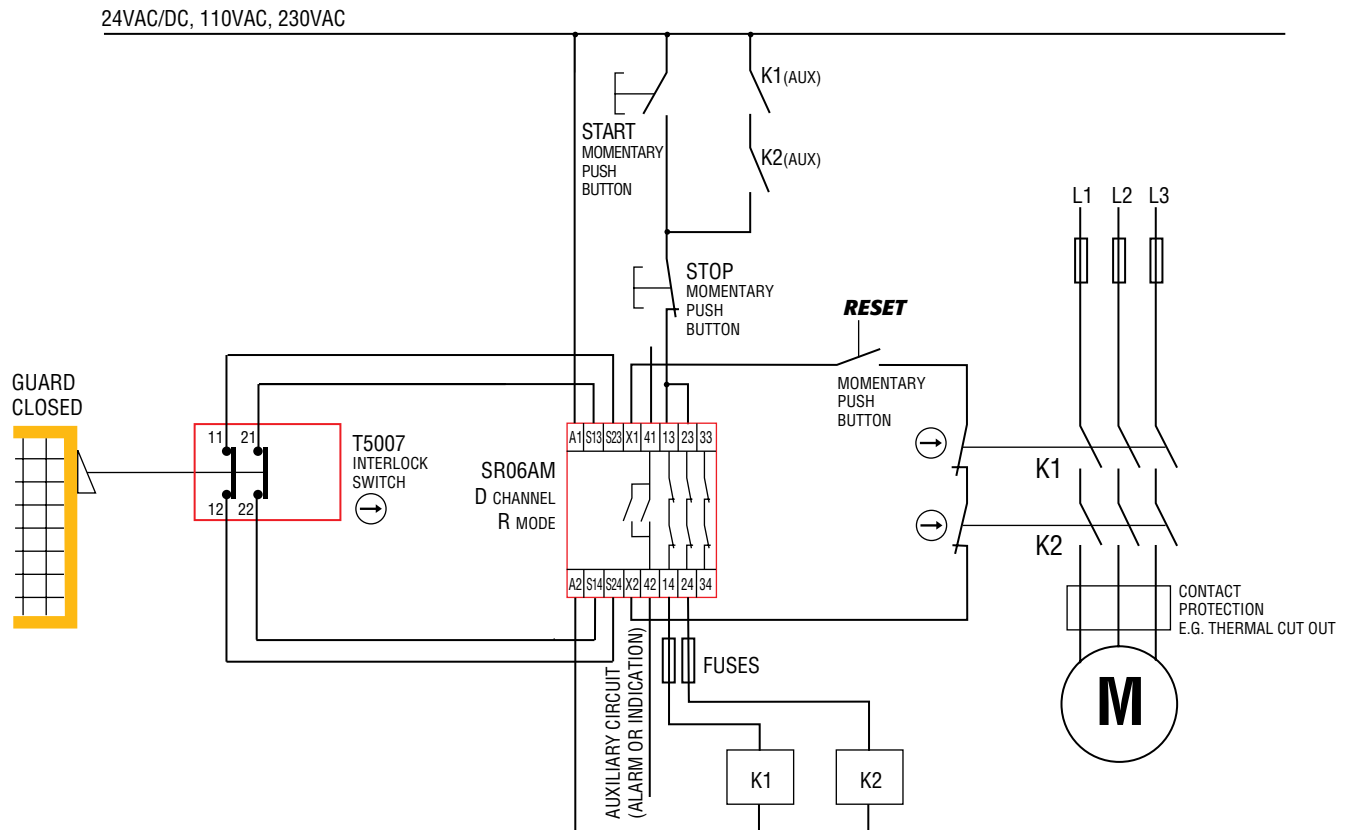
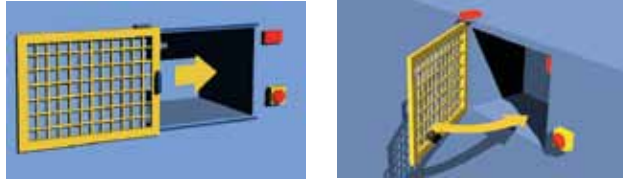

 For a full explanation of the circuit operating principle and fault detection, see “Common Circuit Examples” in The Safety Library Section of this catalog on page A62

Dimensions

(mm/in.)

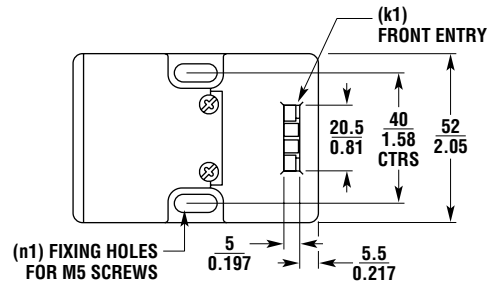
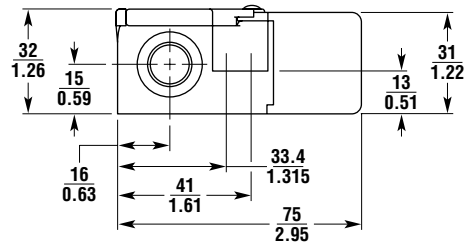
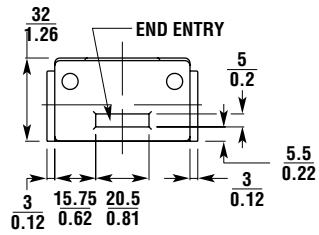

CATCH CASE

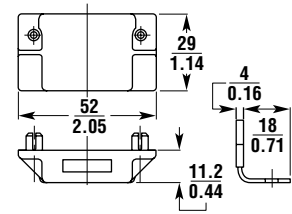

CATCH RETAINER

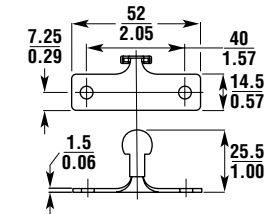

STANDARD ACTUATOR

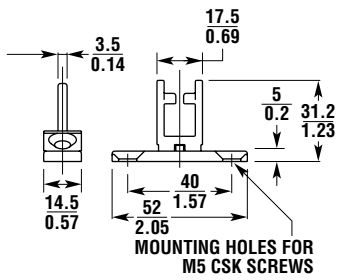

FLEX 1 ACTUATOR

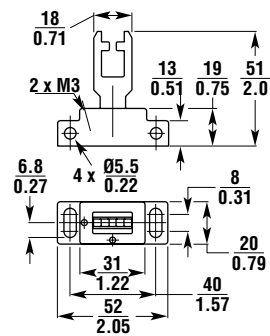

FLEX 2 ACTUATOR

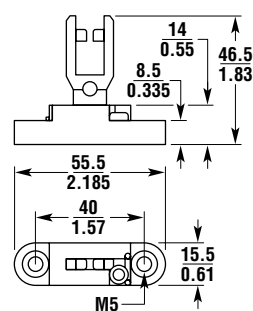

ALIGNMENT GUIDE FOR FLEX ACTUATORS

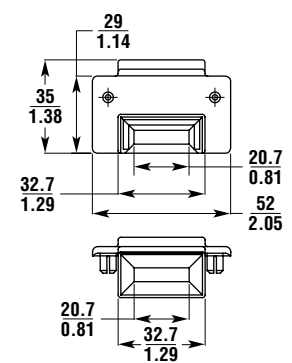

Ordering

Model	Contacts	Wiring Entry	Part No.
T5007 Standard Actuator			
T5007-11SM	1N/C + 1N/O	3 x M20 with NPT adapter	44526-0010
T5007-11SCC	1N/C + 1N/O	cable connector	44526-0012
T5007-02SM	2N/C	3 x M20 with NPT adapter	44526-0020
T5007-02SCC	2N/C	cable connector	44526-0022
T5007-11FSSM (Stainless head, front entry)	1N/C + 1N/O	3 x M20 with NPT adapter	44526-1010
T5007-11RSSM (Stainless head, rear entry)	1N/C + 1N/O	3 x M20 with NPT adapter	44526-1011
T5007-11FSSCC (Stainless head, front entry)	1N/C + 1N/O	cable connector	44526-1012
T5007-11RSSCC (Stainless head, rear entry)	1N/C + 1N/O	cable connector	44526-1013
T5007-02FSSM (Stainless head, front entry)	2N/C	3 x M20 with NPT adapter	44526-1020
T5007-02RSSM (Stainless head, rear entry)	2N/C	3 x M20 with NPT adapter	44526-1021
T5007-02FSSCC (Stainless head, front entry)	2N/C	cable connector	44526-1022
T5007-02RSSCC (Stainless head, rear entry)	2N/C	cable connector	44526-1023
T5007 Flex Actuator (Flex 1)			
T5007-11F1M	1N/C + 1N/O	3 x M20 with NPT adapter	44526-0110
T5007-11F1CC	1N/C + 1N/O	cable connector	44526-0112
T5007-02F1M	2N/C	3 x M20 with NPT adapter	44526-0120
T5007-02F1CC	2N/C	cable connector	44526-0122
T5007-11FF1SM (Stainless head, front entry)	1N/C + 1N/O	3 x M20 with NPT adapter	44526-1110
T5007-11RF1SM (Stainless head, rear entry)	1N/C + 1N/O	3 x M20 with NPT adapter	44526-1111
T5007-11FF1SCC (Stainless head, front entry)	1N/C + 1N/O	cable connector	44526-1112
T5007-11RF1SCC (Stainless head, rear entry)	1N/C + 1N/O	cable connector	44526-1113
T5007-02FF1SM (Stainless head, front entry)	2N/C	3 x M20 with NPT adapter	44526-1120
T5007-02RF1SM (Stainless head, rear entry)	2N/C	3 x M20 with NPT adapter	44526-1121
T5007-02FF1SCC (Stainless head, front entry)	2N/C	cable connector	44526-1122
T5007-02RF1SCC (Stainless head, rear entry)	2N/C	cable connector	44526-1123
T5007 Semi-Flex Actuator (Flex 2)			
T5007-11F2M	1N/C + 1N/O	3 x M20 with NPT adapter	44526-0210
T5007-11F2CC	1N/C + 1N/O	cable connector	44526-0212
T5007-02F2M	2N/C	3 x M20 with NPT adapter	44526-0220
T5007-02F2CC	2N/C	cable connector	44526-0222
T5007-11FF2SM (Stainless head, front entry)	1N/C + 1N/O	3 x M20 with NPT adapter	44526-1210
T5007-11RF2SM (Stainless head, rear entry)	1N/C + 1N/O	3 x M20 with NPT adapter	44526-1211
T5007-11FF2SCC (Stainless head, front entry)	1N/C + 1N/O	cable connector	44526-1212
T5007-11RF2SCC (Stainless head, rear entry)	1N/C + 1N/O	cable connector	44526-1213
T5007-02FF2SM (Stainless head, front entry)	2N/C	3 x M20 with NPT adapter	44526-1220
T5007-02RF2SM (Stainless head, rear entry)	2N/C	3 x M20 with NPT adapter	44526-1221
T5007-02FF2SCC (Stainless head, front entry)	2N/C	cable connector	44526-1222
T5007-02RF2SCC (Stainless head, rear entry)	2N/C	cable connector	44526-1223
Accessories			
Spare Standard Actuator for T5007			44526-0700
Spare Standard Actuator for Stainless Head			44519-0700
Spare Flex 1 Actuator with plastic guide			44519-0710
Spare Flex 2 Actuator with plastic guide			44501-0780
Spare Alignment Guide (Plastic)			44501-0770
Mechanical Catch Kit (use with standard actuator only and with plastic head only)			44501-0740
Lockoff Actuator for T5007			44512-0700
Spare M20 to 0.5 in. NPT adapter			44512-0110
M20 Cord Grip			44512-0090

 = Highlighted **Rapid Delivery** products are available for shipment today or within **FIVE** days.