

NOTES

DESIGNED FOR POWER DISTRIBUTION FOR EQUIPMENT RACKS - ALSO
HANDY FOR WORK STATIONS.
RUGGED EXTRUDED ALUMINUM CASE.
HEAVY-DUTY CORD - 14/3 SJTW WIRE FOR EXTREME TEMPERATURE
RANGES.
INTEGRAL MOLDED PLUG AVAILABLE IN STRAIGHT-BLADE (NEMA 5-15P) OR
TWIST-LOCK (NEMA L5-15P) CONFIGURATIONS.
COMES WITH RED PILOT LIGHT TO INDICATE POWER ON.
INCLUDES 15A, OR 20A 125VAC CIRCUIT BREAKER TO PREVENT ACCIDENTAL
LINE OVERLOAD.
INCLUDES HARDWARE FOR RACK MOUNTING TO AMHAL STRUTS.
CSA CERTIFIED, UL LISTED.

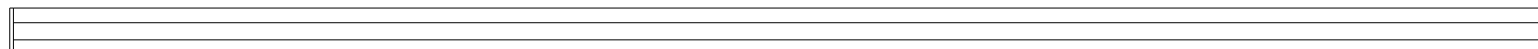

SIDE VIEW

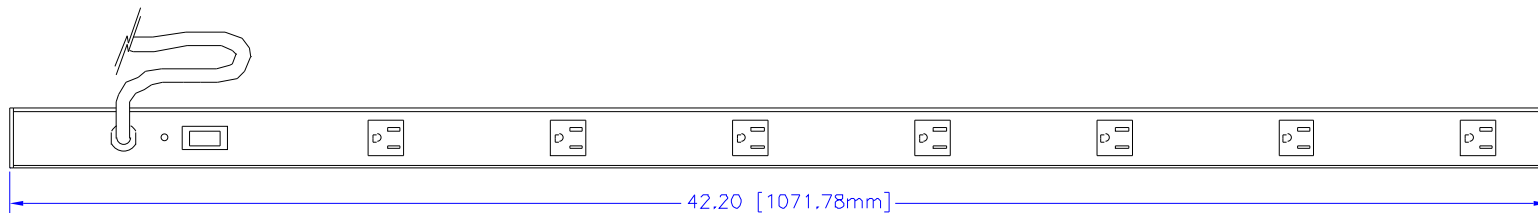

TOP VIEW

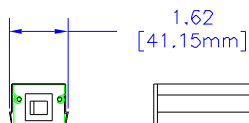

L. END VIEW

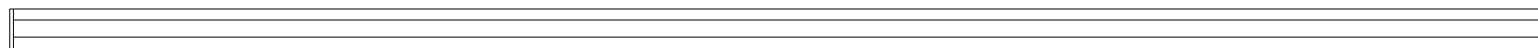

SIDE VIEW

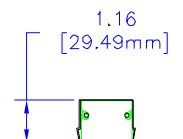

R. END VIEW



BOTTOM VIEW

*SEE CATALOG FOR THE COMPLETE PART
NUMBER BASED ON THE OPTIONS LISTED
IN THE NOTE SECTION

UNLESS OTHERWISE SPECIFIED
DIMENSIONS ARE IN INCHES
X +/- .1
XX +/- .02
XXX +/- .015
ANGLES +/- .005
ANGLES +/- 5 DEG.
NOTES
HARRISON CLAIMS PROPRIETARY RIGHTS TO
THE MATERIAL ON THIS DRAWING. IT IS
INTENDED TO BE USED AS A REFERENCE FOR
ENGINEERING INFORMATION ONLY. THIS
INFORMATION MAY NOT BE USED TO
MANUFACTURE PRODUCT WITHOUT WRITER
PERMISSION FROM HARRISON MANUFACTURING.



HAMMOND
MANUFACTURING

WEB: WWW.HAMMONDMFG.COM

TITLE
HAMMOND INDUSTRIAL
GRADE POWER STRIPS
DRAWN BY MJM DATE 02/09/01
SCALE PAGE 1 OF 1
PART NUMBER
15854T7****

Mouser Electronics

Authorized Distributor

Click to View Pricing, Inventory, Delivery & Lifecycle Information:

Hammond:

[15854T7B1](#) [15854T7C1](#) [15854T7D1](#) [15854T7A1](#)