

VT CONNECTOR

Disconnectable Crimp style connector

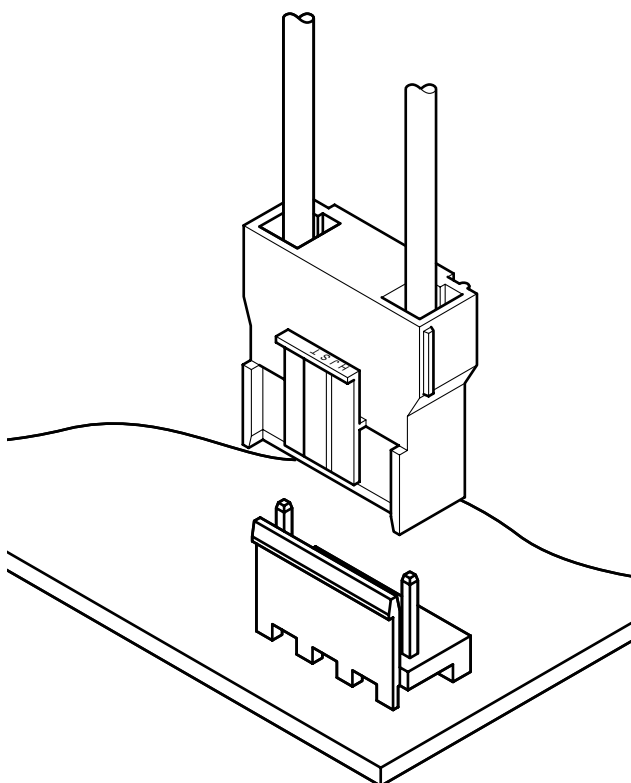

The VT connector is a 11.88mm (.468") pitch disconnectable crimp style connector with current rating of 12A. It has features such as the PC board locking device, misinsertion preventive construction and arm-lock mechanism. Its header is applicable to reinforced PC boards with eyelets.



Features

- **11.88mm (.468") pitch**
11.88mm (.468") pitch with current rating of 12A.
- **Connectable to vinyl insulated flat cables**
Can be connected to vinyl insulated flat cables (such as SPT, HVFF) ranging from AWG #20 to 16 which are used for primary sides of power circuits.
- **Use of PC board locking device**
PC board locking device makes temporary mounting and correct positioning onto the board easy.
- **Correct and secure mating**
Correct and secure mating thanks to the misinsertion preventive construction and arm-lock mechanism.
- **Applicable to reinforced PC boards with eyelets**
Header is designed to be applicable to reinforced PC boards with eyelets.

Specifications

- Current rating: 12A AC, DC (AWG #16)
 - Voltage rating: 250V AC, DC
 - Temperature range: -25°C to +85°C
(including temperature rise in applying electrical current)
 - Relative humidity: 0 to 80%
 - Contact resistance: Initial value/10m max.
After environmental testing/20m max.
 - Insulation resistance: 1,000M min.
 - Withstanding voltage: 1,500V AC/minute
 - Applicable wire: AWG #20 to #16
 - Applicable PC board thickness: 1.6mm(.063")
- * Contact JST for details.

Standards

Recognized E60389

Certified LR20812

R9151561

Contact

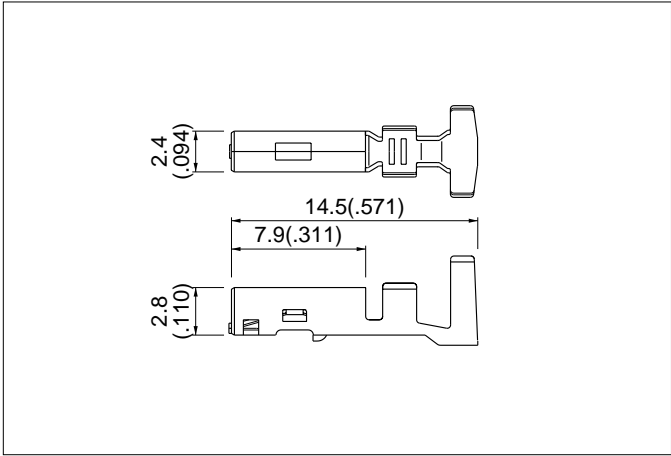

Model No.	Applicable wire		Q'ty / reel
	AWG #	Insulation O.D. mm(in.)	
SVT-41T-P1.1	20 to 16	2.7 to 3.9(.106 to .153)	2,500
Material and Finish			
Phosphor bronze, tin/lead-plated			

Housing

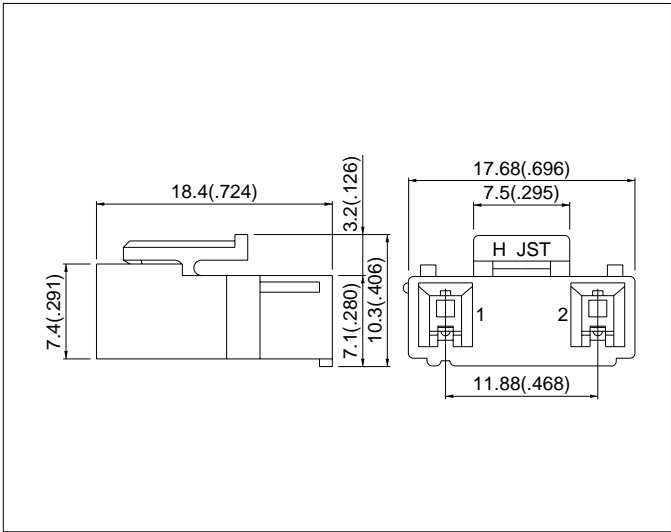

Circuits	Model No.	Q'ty / bag
2	VTR-02	500
Material		
Nylon 66, UL94V-0, natural (white)		

<For reference> As the color identification, the following alphabet shall be put in the underlined part. For availability, delivery and minimum order quantity, contact JST.

ex. VTR-02-00
(blank)...natural (white)
Z...ivory

VT CONNECTOR

Locking header

Top entry type

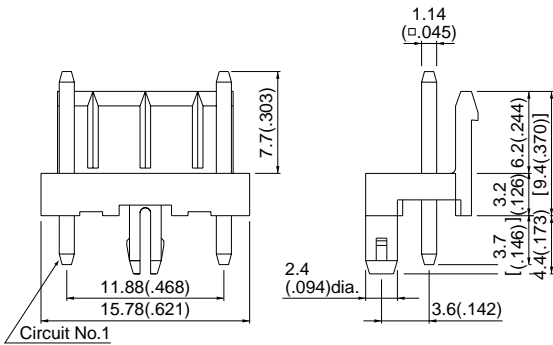

Side entry type

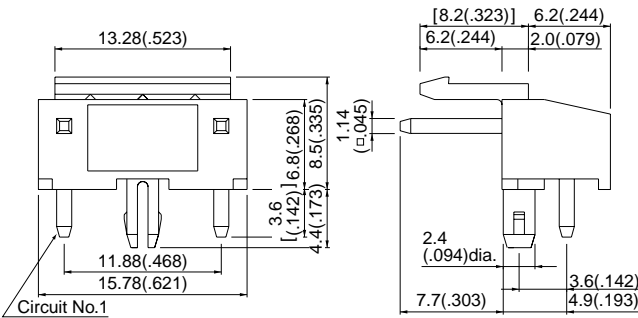

Circuits	Model No.		Q'ty / box	
	Top entry type	Side entry type	Top entry type	Side entry type
2	B02B-VT	S02B-VT	500	250
Material and Finish				
Post: Copper, tin/lead-plated				
Wafer: Glass-filled nylon 66, UL94V-0, natural (ivory)				

PC board layout (viewed from component side) and Assembly layout

Top entry type

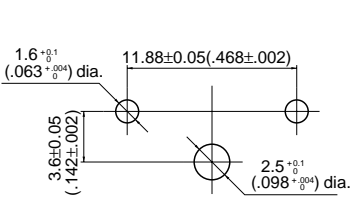

Side entry type

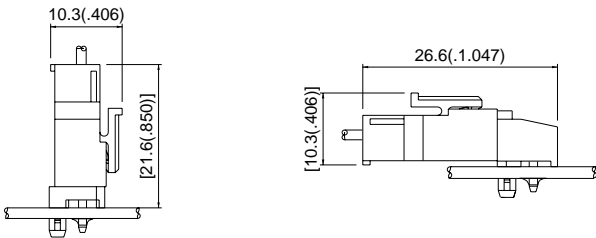

Applicator for the semi-automatic press AP-K2N

Contact	Crimp applicator MKS-L		Compact crimp applicator MKS-LS		Strip-crimp applicator MKS-SC
	with safety cover	without safety cover	with safety cover	without safety cover	with safety cover
SVT-41T-P1.1	APLMK SVT41-11	APLNC SVT41-11	—	—	APLSC SVT41-11