

ALL RIGHTS RESERVED. NO PORTION OF THIS PUBLICATION, WHETHER IN WHOLE OR IN PART CAN BE REPRODUCED WITHOUT THE EXPRESS WRITTEN CONSENT OF SPC TECHNOLOGY.

REVISIONS			DOC. NO. SPC-F005 * Effective: 12/21/98 * DCP No: 860					
DCP #	REV	DESCRIPTION	DRAWN	DATE	CHECKD	DATE	APPRVD	DATE
	A	Redrawn in AutoCad	JAP	11/26/91				
1199	B	Renamed: was CBS-T0-****HT	JWM	01/03/02	JC	1/4/02	JC	1/4/02

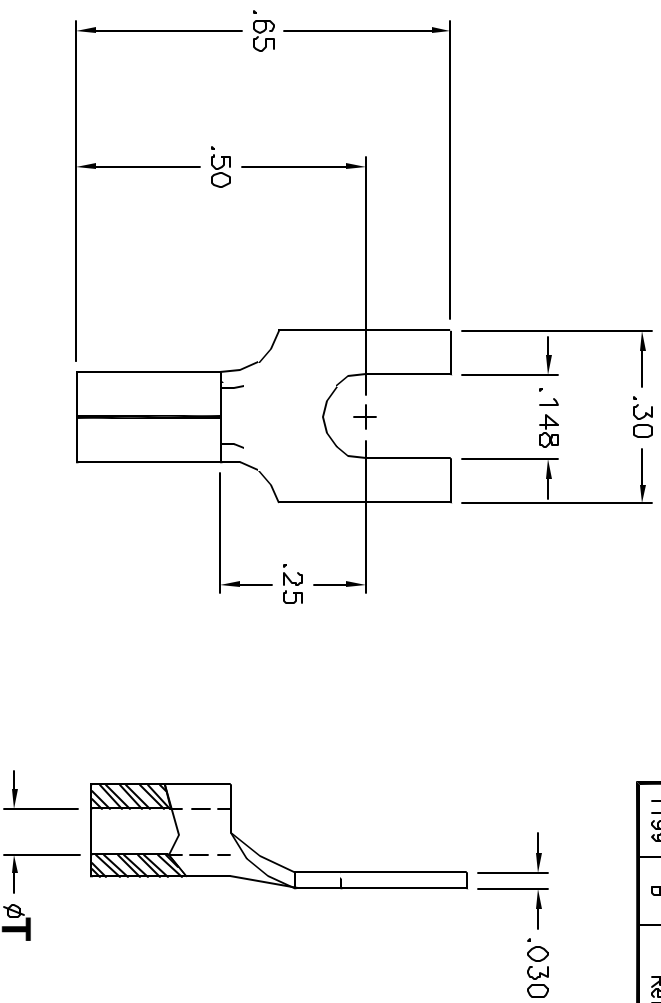

- NOTES:
- 1. MATERIAL: NICKEL-PLATED ALLOY STEEL
 - 2. CONTINUOUS OPERATING TEMPERATURE: 900°F (482°C)
 - 3. VOLTAGE RATING: 600 V

PART NUMBER	WIRE RANGE (AWG)	STUD SIZE	T
CBS-T0-1406-HT	16 - 14	#6	.138
CBS-T0-1806-HT	22 - 18	#6	.138
			.070



DISCLAIMER
ALL STATEMENTS AND TECHNICAL INFORMATION CONTAINED HEREIN ARE BASED UPON INFORMATION AND/OR TESTS WE BELIEVE TO BE ACCURATE AND RELIABLE. SINCE CONDITIONS OF USE ARE BEYOND OUR CONTROL, THE USER SHALL DETERMINE THE SUITABILITY OF THE PRODUCT FOR THE INTENDED USE AND ASSUME ALL RISK AND LIABILITY WHATSOEVER IN CONNECTION THEREWITH.

Tolerances: Unless Otherwise Specified: X = ±.015 .XX = ±.010 .XXX = ±.005		DRAWING TITLE: High Temperature Spade Terminals	
DRAWN BY:	DATE:	SIZE DWG. NO.	
JC	3/7/91	A	
CHECKED BY:	DATE:	ELECTRONIC FILE	
JOHN COLE	11/27/91	TA-479	
APPROVED BY:	DATE:	TA-479	
JL	11/27/91	REV B	
SCALE: NTS	U.O.M.: INCHES [mm]	SHEET: 1 OF 1	