

## SPECIFICATIONS

### Mechanical

**Contact Mating Force:** 3.1kg (6.8Lb) max.

**Contact unmating Force:** 0.2kg (0.4Lb) min.

**Contact Retention Force:** 1.82kg (4.0Lb) min.

### Electrical

**Current Rating:** 2.0A

**Contact Resistance:** 35mΩ max.

**Dielectric Withstanding Voltage:** 1000V AC/1min min.

**Insulation Resistance:** 5000MΩ

### Physical

**Housing:** Thermoplastic, UL 94V-0 rated in Teal 322C Color

**Contact:** Copper alloy

**Plating:** See "ORDERING INFORMATION"

**Solder Pad:** Copper alloy

**Operating Temperature:** -55°C to +105°C

## D-SUB Connector

### DT Series

**Right Angle, T/H Type**

**2.77mm [.109"] Pitch**

**9 Pos.**

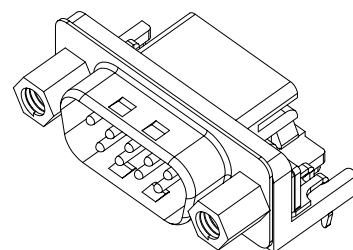

## DRAWING

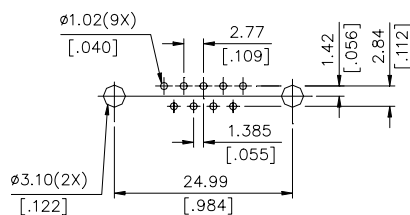
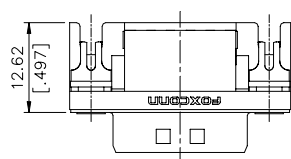

RECOMMENDED P.C.B. LAYOUT

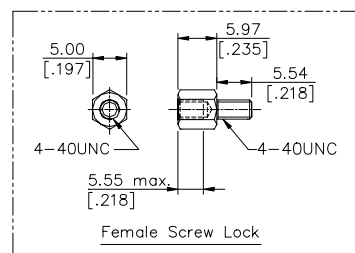
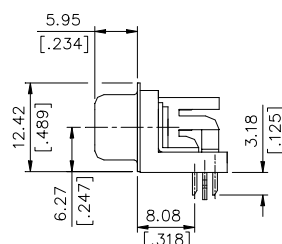
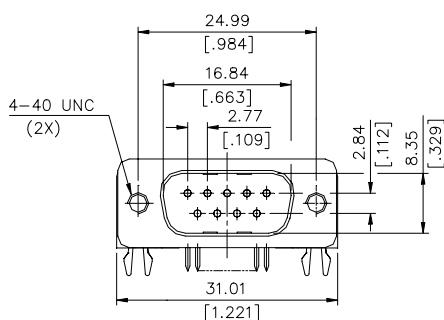

## ORDERING INFORMATION

PRODUCT NO.: DT 1 0 1 2 \*- P\*T

Dsub Series

Body Type

1=Right Angle PCB Mount

Termination Type

0=Male

No. of Pos.

1=9 Pos.

Body Length

2=8.08 mm

Extension Code

P3T=W/O Female Screw Lock

P5T=W/ Female Screw Lock

Mating Area Plating

1=Gold Flash

3=30u" Gold