

Taptite 2000® 02EP

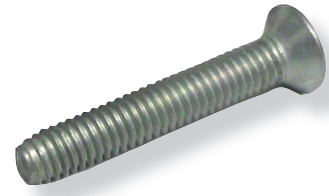

English	Français	Deutsch	Italiano	Español
Oval countersunk Torx®	Tête fraisée bombée Torx®	Linsen-Senkkopf Torx®	Testa Svasata con calotta Torx®	Avellanada gota de sebo Torx®
Steel case hardened* Hardness: Surface: > 450 HV0,3 Core: 290 to 370 HV10	Acier cémenté* Dureté: Superficielle: > 450 HV0,3 À coeur: 290 à 370 HV10	Stahl einsatzgehärtet* Härte: Oberfläche: > 450 HV0,3 Kern: 290 bis 370 HV10	Acciaio cementato* Durezza: Superficiale: > 450 HV0,3 A cuore: 290 a 370 HV10	Acero cementado* Dureza: Superficial: > 450 HV0,3 Núcleo: 290 a 370 HV10
Zinc alkaline clear ¹⁾ or Zinc -nickel alkaline clear ²⁾	Zinc alcalin claire ¹⁾ ou Zinc-nickel alcalin claire ²⁾	Zink alkalisch transparent ¹⁾ oder Zink-Nickel alkalisch transparent ²⁾	Zinco alcalino chiaro ¹⁾ o Zinco-Nichel alcalino chiaro ²⁾	Zincado y pasivado claro ¹⁾ o Niquelado ²⁾

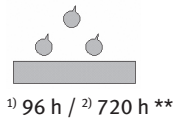

≡ EN ISO 14584

*: EN ISO 7085

** : to red rust / à la rouille rouge / bis Rotrost / alla ruggine rossa / al óxido rojo (ASTM B117)

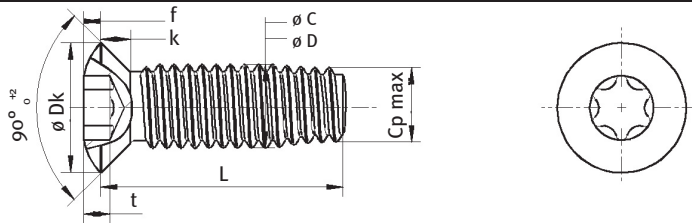

ø	ø C	ø D	Pitch / Pas/ Steigung/ Passo / Paso	Cp max.	ø Dk	K max.	f	Torx®	t	L	Part No/ref
M2.0	1.93 - 2.01	1.88 - 1.97	0.40	1.77	3.50 - 3.80	1.20	0.50	T6	0.63 - 0.77	4 ±0.24	02EP2000401
										6 ±0.24	02EP2000601
										8 ±0.29	02EP2000801
										10 ±0.29	02EP2001001
										12 ±0.35	02EP2001201
										16 ±0.35	02EP2001601
M2.5	2.43 - 2.52	2.37 - 2.48	0.45	2.25	4.40 - 4.70	1.50	0.60	T8	0.91 - 1.04	6 ±0.24	02EP2500601
										8 ±0.29	02EP2500801
										10 ±0.29	02EP2501001
										12 ±0.35	02EP2501201
										16 ±0.35	02EP2501601
M3.0	2.93 - 3.02	2.87 - 2.97	0.50	2.72	5.20 - 5.50	1.65	0.70	T10	0.88 - 1.15	6 ±0.24	02EP3000601
										8 ±0.29	02EP3000801
										10 ±0.29	02EP3001001
										12 ±0.35	02EP3001201
										16 ±0.35	02EP3001601
										20 ±0.42	02EP3002001
										25 ±0.42	02EP3002501
30 ±0.42	02EP3003001										

all dimensions in mm / en millimètres / alle Maße in mm / in millimetri / en milímetros



Taptite 2000® 02EP

∅	∅ C	∅ D	Pitch / Pas/ Steigung/ Passo / Paso	Cp max.	∅ Dk max.	K max.	f	Torx®	t	L	Part No/ref
M4.0	3.92 - 4.02	3.83 - 3.95	0.70	3.61	8.04 - 8.40	2.70	1.00	T20	1.42 - 1.80	8 ±0.29	02EP4000801
										10 ±0.29	02EP4001001
										12 ±0.35	02EP4001201
										16 ±0.35	02EP4001601
										20 ±0.42	02EP4002001
										25 ±0.42	02EP4002501
										30 ±0.42	02EP4003001
										35 ±0.50	02EP4003501
M5.0	4.91 - 5.02	4.81 - 4.94	0.80	4.55	8.94 - 9.30	2.70	1.20	T25	1.65 - 2.03	8 ±0.29	02EP5000801
										10 ±0.29	02EP5001001
										12 ±0.35	02EP5001201
										16 ±0.35	02EP5001601
										20 ±0.42	02EP5002001
										25 ±0.42	02EP5002501
										30 ±0.42	02EP5003001
										35 ±0.50	02EP5003501
M6.0	5.90 - 6.03	5.78 - 5.93	1.00	5.38	10.87 - 11.30	3.30	1.40	T30	2.02 - 2.42	10 ±0.29	02EP6001001
										12 ±0.35	02EP6001201
										16 ±0.35	02EP6001601
										20 ±0.42	02EP6002001
										25 ±0.42	02EP6002501
										30 ±0.42	02EP6003001
										35 ±0.50	02EP6003501
										40 ±0.50	02EP6004001
M8.0	7.87 - 8.03	7.71 - 7.91	1.25	7.23	15.37 - 15.80	4.65	2.00	T45 opt. T40	2.92 - 3.31	16 ±0.35	02EP8001601
										20 ±0.42	02EP8002001
										25 ±0.42	02EP8002501
										30 ±0.42	02EP8003001
										35 ±0.50	02EP8003501
										40 ±0.50	02EP8004001
										45 ±0.50	02EP8004501
										50 ±0.50	02EP8005001
60 ±0.60	02EP8006001										
70 ±0.60	02EP8007001										
										80 ±0.60	02EP8008001

all dimensions in mm / en millimètres / alle Maße in mm / in millimetri / en milímetros

Quality level / Niveau qualité / Qualitätsniveau / Livello qualità / Nivel de calidad: 150 ppm

Optional heat treatment : Class 10-9

Traitement thermique optionnel: Classe 10-9

Optionale Wärmebehandlung: Klasse 10-9

Trattamento termico opzionale: Classe 10-9

Tratamiento térmico opcional: Clase 10-9



Taptite 2000[®] 02EP

Highlighted part numbers are non standard, non in stock - Références surlignées non standard et non tenues en stock -
 Markierte Artikel-Nummern sind kein Standard, keine Lagerware - I codici evidenziati non sono standard, non sono a stock -
 Referencias no estándar, generalmente no en stock

Finishes / finition / Oberflächen / superficie / superficie

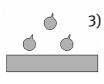
Type	Description / description / Beschreibung / descrizione / descripción	Cr6	 3)	Code ⁴⁾
Standard	Zinc alkaline 8 µm mini clear, friction 0.08 - 0.14 / Zinc alcalin 8µm mini passivation claire, coefficient de frottement 0.08 - 0.14 / Zink alkalisch 8µm min. transparent, Reibkoeffizient 0.08 - 0.14 / Zlnc alcalino 8µm min. passivazione chiara, coefficiente d'attrito 0.08 - 0.14 / Zincado y pasivado claro min. 8 µm coeficiente de fricción 0.08 - 0.14	✓	96 h	AG
Optional	Zinc alkaline 8 µm mini clear, friction 0.08 - 0.14 / Zinc alcalin 8µm mini passivation claire, coefficient de frottement 0.08 - 0.14 / Zink alkalisch 8µm min. transparent, Reibkoeffizient 0.08 - 0.14 / Zlnc alcalino 8µm min. passivazione chiara, coefficiente d'attrito 0.08 - 0.14 / Zincado y pasivado claro min. 8 µm coeficiente de fricción 0.08 - 0.14	✓	400 h	AJ
Optional	Zinc-nickel alkaline clear, friction 0.08 - 0.14 / Zinc-nickel alcalin 8µm mini passivation claire, coefficient de frottement 0.08 - 0.14 / Zink-Nickel alkalisch transparent, Reibkoeffizient 0.08 - 0.14 / Zlnc Nickel alcalino 8µm min. passivazione chiara, coefficiente d'attrito 0.08 - 0.14 / Niquelado claro min. 8 µm coeficiente de fricción 0.08 - 0.14	✓	720 h	BE
Optional	Zinc-nickel alkaline black, friction 0.08 - 0.14 / Zinc-nickel alcalin 8µm mini passivation noir, coefficient de frottement 0.08 - 0.14 / Zink-Nickel alkalisch schwarz, Reibkoeffizient 0.08 - 0.14 / Zlnc Nickel alcalino 8µm min. passivazione nera, coefficiente d'attrito 0.08 - 0.14 / Niquelado negro min. 8 µm coeficiente de fricción 0.08 - 0.14	✓	720 h	BF

3) to red rust / à la rouille rouge / bis Rotrost / alla ruggine rossa / al óxido rojo

4) add code to the part number / ajoutez le code à la référence / fügen Sie den Code zur Artikel-Nummer hinzu / aggiungere il codice alla referenza / añadir numeración a la referencia