

### Applications

- Accommodates wiring devices and provides opening to splice, tap, or pull conductors
- Provide access to conductors for maintenance and future system changes

### Features

- Tapered threads (NPT with integral bushings)
- Internal grounding screw
- Optional mounting feet available on FS, FD, FSC, and FDC
- Available single and two-gang styles
- Suitable for use in wet locations when used with gasket covers
- Cast iron is suitable for concrete use
- For use with FS-style covers see pages C22-23

### Material/Finish

#### Copper-free Aluminum

(less than 4/10 of 1%)

- Electrostatically applied powder coating
- Tri-coat finish of electrozinc, chromate sealant, and electrostatically applied powder coating

### Compliances

- UL Standard: 514A
- CSA Standard: C22.2 No. 18
- Fed Spec: W-C-586D
- NEMA: FB-1
-  - Listed File No. E3397
-  - Certified File No. LR11852



**FS TYPE**



**FD TYPE**



**FSC TYPE**

### ORDERING INFORMATION - DIMENSIONS

FS TYPE CAST DEVICE BOX - SHALLOW - DEAD END										
CATALOG NUMBER		HUB SIZE	DIMENSIONS							VOLUME CU. IN.
KILLARK ALUM.	DURALOY IRON		A	B	C	D	E	F	G	
FS-1	FS-1M	1/2"	7/8" (22)	2" (51)	11/16" (17)	4-5/8" (117)	2-7/8" (73)	—	—	18.0
FS-2	FS-2M	3/4"	7/8" (22)	2" (51)	11/16" (17)	4-5/8" (117)	2-7/8" (73)	—	—	18.0
FS-3	FS-3M	1"	7/8" (22)	2" (51)	11/16" (17)	4-5/8" (117)	2-7/8" (73)	—	—	18.0

FD TYPE CAST DEVICE BOX - DEEP - DEAD END										
CATALOG NUMBER		HUB SIZE	DIMENSIONS							VOLUME CU. IN.
KILLARK ALUM.	DURALOY IRON		A	B	C	D	E	F	G	
FD-1	FD-1M	1/2"	7/8" (22)	2-7/8" (73)	11/16" (17)	4-5/8" (117)	2-7/8" (73)	—	—	28.0
FD-2	FD-2M	3/4"	7/8" (22)	2-7/8" (73)	11/16" (17)	4-5/8" (117)	2-7/8" (73)	—	—	28.0
FD-3	FD-3M	1"	7/8" (22)	2-7/8" (73)	11/16" (17)	4-5/8" (117)	2-7/8" (73)	—	—	28.0

FSC TYPE CAST DEVICE BOX - SHALLOW - FEED THRU										
CATALOG NUMBER		HUB SIZE	DIMENSIONS							VOLUME CU. IN.
KILLARK ALUM.	DURALOY IRON		A	B	C	D	E	F	G	
FSC-1	FSC-1M	1/2"	7/8" (22)	2" (51)	11/16" (17)	4-5/8" (117)	2-7/8" (73)	—	—	18.0
FSC-2	FSC-2M	3/4"	7/8" (22)	2" (51)	11/16" (17)	4-5/8" (117)	2-7/8" (73)	—	—	18.0
FSC-3	FSC-3M	1"	7/8" (22)	2" (51)	11/16" (17)	4-5/8" (117)	2-7/8" (73)	—	—	18.0

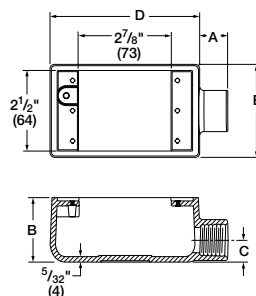

**FS**

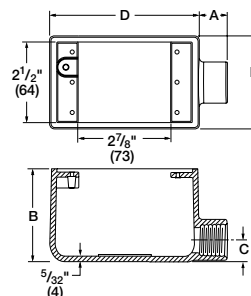

**FD**

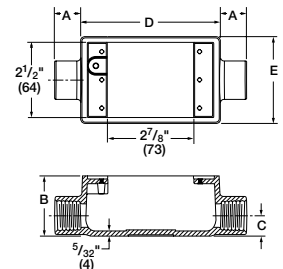

**FSC**



**KILLARK®**