

Size H11

Mating-and mounting-conditions according to DIN 41612/IEC 60603-2

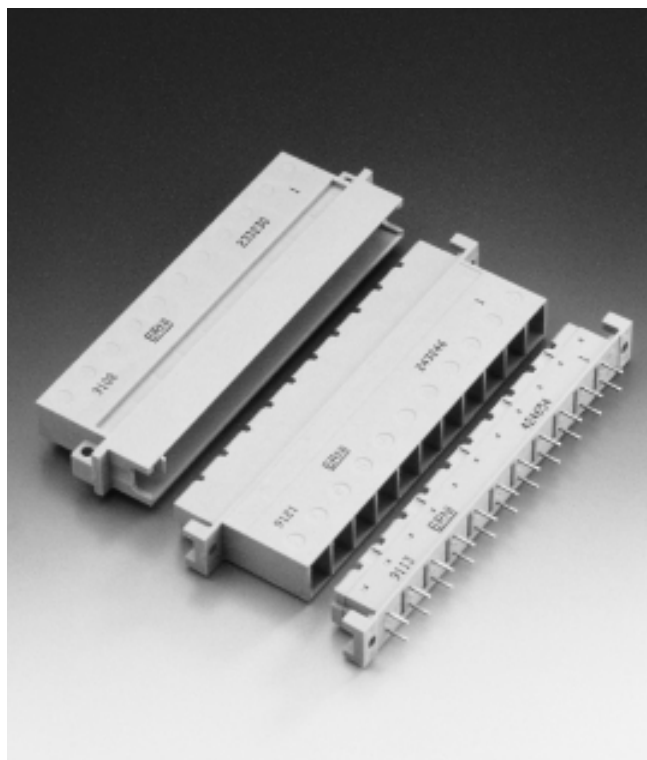

Dimensional drawings

Male connector

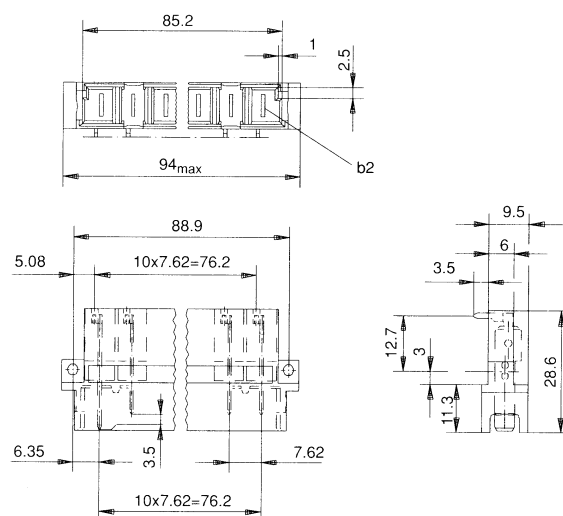

Female connector
with quick disconnect terminations

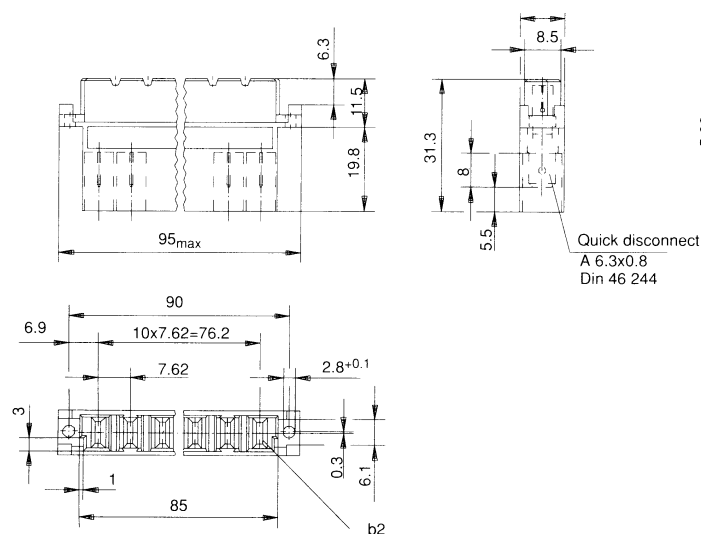

Female connector
with dip solder terminations

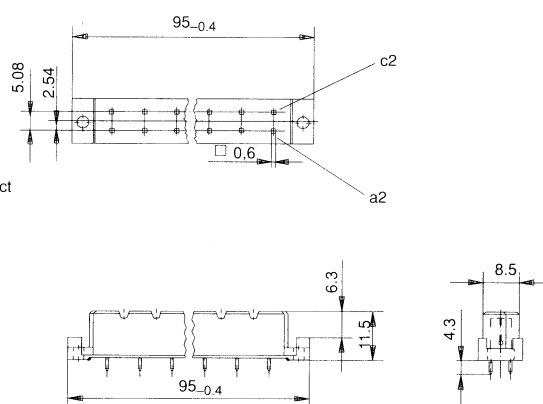

please refer to the pcb pattern on page 41



Orderings details

Male connector size H11

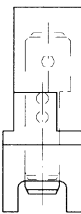
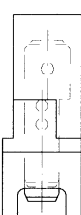
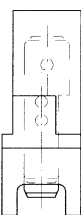
Mating-and mounting-conditions according to DIN 41612/IEC 60603-2, one row loaded, maximum 11 contacts

	<p>STV-H 11-M VE 2^① Termination 6.3x0.8mm for quick disconnect connectors</p> <table border="1"> <tr> <td>PC</td><td>1</td></tr> <tr> <td></td><td>233 233</td></tr> </table>	PC	1		233 233
PC	1				
	233 233				
	<p>STV-H 11-M VE 32^① Termination 6.3x0.8mm for quick disconnect connectors</p> <table border="1"> <tr> <td>PC</td><td>1</td></tr> <tr> <td></td><td>233 226</td></tr> </table>	PC	1		233 226
PC	1				
	233 226				
	<p>STV-H 11-M VE 2+32^① Termination 6.3x0.8mm for quick disconnect connectors</p> <table border="1"> <tr> <td>PC</td><td>1</td></tr> <tr> <td></td><td>233 234</td></tr> </table>	PC	1		233 234
PC	1				
	233 234				

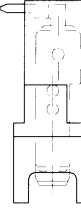
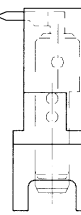
① VE...early make/last break contacts on position...
Male connectors with early make/last break contacts can be loaded in any position.

	<p>STV-H 11-M VE 2^① solder terminations can be broken off ^②</p> <table border="1"> <tr> <td>PC</td><td>1</td></tr> <tr> <td></td><td>233 232</td></tr> </table>	PC	1		233 232
PC	1				
	233 232				
	<p>STV-H 11-M VE 32^① solder terminations can be broken off ^②</p> <table border="1"> <tr> <td>PC</td><td>1</td></tr> <tr> <td></td><td>233 230</td></tr> </table>	PC	1		233 230
PC	1				
	233 230				
	<p>STV-H 11-M VE 2+32^① solder terminations can be broken off ^②</p> <table border="1"> <tr> <td>PC</td><td>1</td></tr> <tr> <td></td><td>233 235</td></tr> </table>	PC	1		233 235
PC	1				
	233 235				

② Solder terminations can be broken off at a score point.
6,3 x 0,8 mm tab that remains can be used for quick disconnect connections.

Further versions on request.

Female connector size H11

Mating-and mounting-conditions according to DIN 41612/IEC 60603-2, one row loaded, maximum 11 contacts

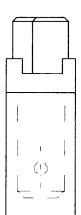
	<p>STV-H 11-F Termination 6.3x0.8mm for quick disconnect connectors</p> <table border="1"> <tr> <td>PC</td><td>1</td></tr> <tr> <td></td><td>243 246</td></tr> </table>	PC	1		243 246
PC	1				
	243 246				

	<p>STV-H 11-F Termination cross section 0.6x0.6mm for dip soldering Grip dimension 5.08mm</p> <table border="1"> <tr> <td>PBT</td><td>1</td></tr> <tr> <td></td><td>424 654</td></tr> </table>	PBT	1		424 654
PBT	1				
	424 654				

The contacts of the size H11 are hard silver plated and correspond to the electrical and mechanical life span of the performance level 1.

Further versions on request.