

SPECIFICATION CONTROL DRAWING

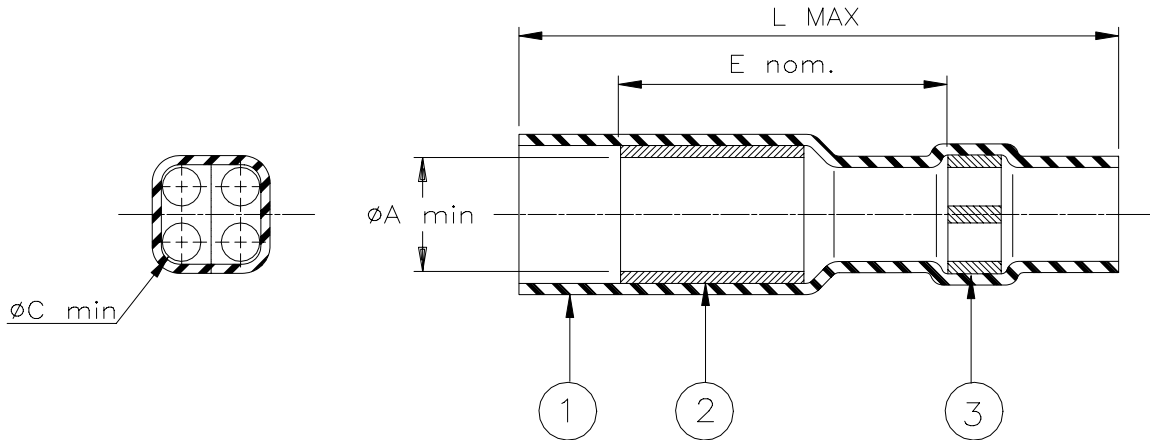

Product Revision		Product Dimensions				Cable Dimension
Product Name		L max	E nom	øA min	øC min	øD max
D-436-48	I	45.9 (1.805)	25.4 (1.0)	10.15 (0.400)	3.8 (0.150)	3.8 (0.150)

MATERIALS

1. INSULATION SLEEVE: Heat-shrinkable, transparent blue, radiation cross-linked modified polyvinylidene fluoride.
2. SEALING INSERT: Fluorocarbon-based thermoplastic. Color:clear.
3. SEALING INSERT: Fluorocarbon-based thermoplastic. Color:yellow.

APPLICATION

1. This part is designed to provide an environment -resistant seal on stub or parallel splices with wires rated for at least +135°C.
2. Sealing will not be achieved when more than two wires exit from any hole.
3. Temperature range: -55°C to +150°C.

Cable dimension:

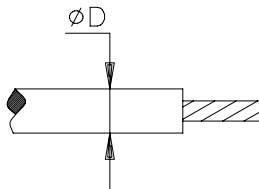

* A trademark of Raychem Corporation.

Raychem		THERMOFIT DEVICES		Raychem Corporation 300 Constitution Drive Menlo Park, CA 94025 USA		TITLE: SEALING SLEEVE							
UNLESS OTHERWISE SPECIFIED DIMENSIONS ARE IN MILLIMETERS. INCHES DIMENSIONS ARE BETWEEN BRACKETS.						DOCUMENT NO.: D-436-48							
TOLERANCES: 0.00 N/A 0.0 N/A 0 N/A		ANGLES: N/A ROUGHNESS IN MICRON		Raychem reserves the right to amend this drawing at any time. Users should evaluate the suitability of the product for their application.		DCR NUMBER: D981037		REPLACES: D43648					
DRAWN BY: M. FORONDA		DATE: 06/29/98		PROD. REV. SEE TABLE		DOC ISSUE: 1		SCALE: None		SIZE: A		SHEET: 1 of 1	

If this document is printed it becomes uncontrolled. Check for the latest revision

Mouser Electronics

Authorized Distributor

Click to View Pricing, Inventory, Delivery & Lifecycle Information:

[TE Connectivity:](#)

[D-436-48](#)