

## Flush-type connector - SACC-DSI-MS-4CON-L180/SH YE - 1457872

Please be informed that the data shown in this PDF Document is generated from our Online Catalog. Please find the complete data in the user's documentation. Our General Terms of Use for Downloads are valid (<http://phoenixcontact.com/download>)



Bus system flush-type plug, with yellow contact carrier, 4-pos., M12 SPEEDCON, shielded, A-coded, rear/screw mounting with M16 thread, with straight solder connection

### Why buy this product

- ✓ Easy PCB assembly: one-piece connectors for wave soldering
- ✓ All standard pin assignments and codings for signal, data, and power transmission with a uniform design-in design
- ✓ For high transmission reliability: optional shield connection to the housing by means of shield contact



### Key Commercial Data

|              |  |
|--------------|--|
| Packing unit | 20 STK   |
| GTIN         |  |
| GTIN         | 4046356617086  |

### Technical data

#### Dimensions

|                          |      |
|--------------------------|------|
| Length of the solder pin | 6 mm |
|--------------------------|------|

#### Ambient conditions

|                                 |                                  |
|---------------------------------|----------------------------------|
| Ambient temperature (operation) | -25 °C ... 85 °C (Plug / socket) |
| Degree of protection            | IP67                             |

#### General

|                       |                               |
|-----------------------|-------------------------------|
| Rated current at 40°C | 4 A                           |
| Rated voltage         | 250 V                         |
| Number of positions   | 4                             |
| Insulation resistance | ≥ 100 MΩ                      |
| Coding                | A - standard                  |
| Standards/regulations | M12 connector IEC 61076-2-101 |
| Status display        | No                            |

# Flush-type connector - SACC-DSI-MS-4CON-L180/SH YE - 1457872

## Technical data

### General

|                      |                                 |
|----------------------|---------------------------------|
| Overvoltage category | II                              |
| Degree of pollution  | 3                               |
| Connection method    | Solder pins                     |
| Mounting type        | Rear mounting Pg9 With flat nut |

### Material

|  |                              |
|--|------------------------------|
| Flammability rating according to UL 94 | V0                           |
| Contact material                       | CuZn                         |
| Contact surface material               | Au                           |
| Contact carrier material               | PA 6.6                       |
| Material, knurls                       | Zinc die-cast, nickel-plated |
| Sealing material                       | NBR                          |

### Cable

|                          |                               |
|--------------------------|-------------------------------|
| Standards/specifications | M12 connector IEC 61076-2-101 |
|--------------------------|-------------------------------|

### Standards and Regulations

|  |                 |
|--|-----------------|
| Standard designation                   | M12 connector   |
| Standards/regulations                  | IEC 61076-2-101 |
| Flammability rating according to UL 94 | V0              |

### Environmental Product Compliance

|            |   |
|------------|---|
| China RoHS | Environmentally Friendly Use Period = 50  |
|            | For details about hazardous substances go to tab "Downloads", Category "Manufacturer's declaration" |

## Drawings

Dimensional drawing

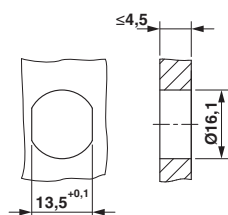

Schematic diagram

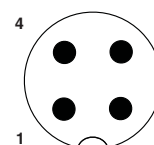

Pin assignment of M12 male connector, 4-pos., A-coded, view of connector side

Housing cutout for M16 fastening thread, mounting panel with feed-through hole (alternatively with area as anti-rotation protection for panel thicknesses > 2 mm up to max. 4.5 mm)

Flush-type connector - SACC-DSI-MS-4CON-L180/SH YE - 1457872

Drilling diagram

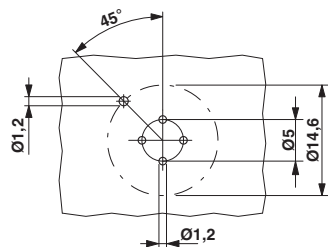

Dimensional drawing

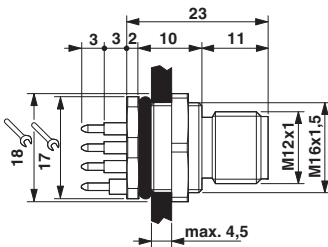

M12 flush-type connector

Dimensional drawing

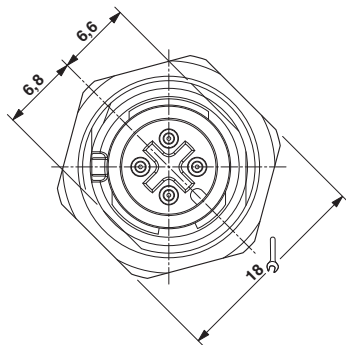

M12 front view

Approvals

Approvals

Approvals

UL Recognized / cULus Recognized / EAC

Ex Approvals

Approval details

|                                |   |   |               |
|--------------------------------|---|---|---------------|
| UL Recognized                  |  | <a href="http://database.ul.com/cgi-bin/XYV/template/LISEXT/1FRAME/index.htm">http://database.ul.com/cgi-bin/XYV/template/LISEXT/1FRAME/index.htm</a> | FILE E 118976 |
| mm²/AWG/kcmil                  | 22  |   |               |
| Nominal current I <sub>N</sub> | 4 A   |   |               |
| Nominal voltage U <sub>N</sub> | 250 V   |   |               |

## Flush-type connector - SACC-DSI-MS-4CON-L180/SH YE - 1457872

### Approvals

|   |       |
|---|-------|
| cULus Recognized  <a href="http://database.ul.com/cgi-bin/XYV/template/LISEXT/1FRAME/index.htm">http://database.ul.com/cgi-bin/XYV/template/LISEXT/1FRAME/index.htm</a> E221474-20140616 |       |
| mm²/AWG/kcmil   | 22-20 |
| Nominal current I <sub>N</sub>  | 4 A   |
| Nominal voltage U <sub>N</sub>  | 250 V |

|   |
|---|
| EAC  B.01742 |
|---|

Phoenix Contact 2018 © - all rights reserved  
<http://www.phoenixcontact.com>

PHOENIX CONTACT GmbH & Co. KG  
Flachsmarktstr. 8  
32825 Blomberg  
Germany  
Tel. +49 5235 300  
Fax +49 5235 3 41200  
<http://www.phoenixcontact.com>