

# YM Series 4 Tumbler Miniature Switchlocks

## Features/Benefits

- Snap-together assembly allows for pre-wiring of switch
- Wire lead terminations available
- 4 Tumbler lock with positive detent

## Typical Applications

- Cable TV connectors
- Automotive accessories
- Computers



Models Available

## Specifications

CONTACT RATING: Q contact material: 4 AMPS @ 125 V AC or 28 V DC; 2 AMPS @ 250 V AC (UL/CSA). 4 AMPS @ 125 V AC, 2 AMPS @ 250 V AC, T65, class 1 (VDE). See page L-17 for additional ratings.

ELECTRICAL LIFE: 10,000 make-and-break cycles at full load.

CONTACT RESISTANCE: Below 10 m  $\Omega$  typ. initial @ 2-4 V DC, 100 mA.

INSULATION RESISTANCE: 10<sup>9</sup>  $\Omega$  min.

DIELECTRIC STRENGTH: 1,000 Vrms min. @ sea level.

INDEXING: 90°:2 positions.

## Materials

LOCK: Zinc alloy with stainless steel facing. 4 tumbler single bitted lock with integral detent mechanism.

KEYS: Two nickel plated brass keys with code number.

SWITCH HOUSING: 6/6 Nylon (UL 94V-2).

CONTACTS & TERMINALS: Q contact material: Copper, silver plated. See page L-17 for additional contact materials.

MOUNTING NUT: Brass, bright zinc plated.

**NOTE:** Any models supplied with Q or B contact material are RoHS compliant.

**NOTE:** Specifications and materials listed above are for switchlocks with standard options. For information on specific and custom switchlocks, consult Customer Service Center.

## Build-A-Switch

To order, simply select desired option from each category and place in the appropriate box. Available options are shown and described on pages L-16 and L-17. For additional options not shown in catalog, consult Customer Service Center.

<p><b>Switch and Lock Function</b></p> <p><b>YM0613</b> SPST, 90° Index, keypull pos. 1</p> <p><b>YM061U</b> SPST, 90° Index, keypull pos. 1 &amp; 2</p> <p><b>Keying</b></p> <p><b>2</b> Two nickel plated brass keys</p> <p><b>Lock Type</b></p> <p><b>C</b> 4 Tumbler, single bitted lock with detent</p> <p><b>Lock Finish</b></p> <p><b>2</b> Stainless steel facing</p> <p><b>8</b> Gloss black facing</p> <p><b>Terminations</b></p> <p><b>05</b> Quick connect</p> <p><b>WC</b> Wire lead</p>	<p><b>Mounting Style</b></p> <p><b>N</b> With nut</p> <p><b>Contact Material</b></p> <p><b>Q</b> Silver</p> <p><b>B</b> Gold</p>
---	--



Dimensions are shown: Inch (mm)  
Specifications and dimensions subject to change



Switchlock

# YM Series

## 4 Tumbler Miniature Switchlocks

### SWITCH AND LOCK FUNCTION

NO. POLES	MODEL NO.	SWITCH FUNCTION		KEY PULL POSITIONS	LOCK CONFIGURATION	INDEXING	SCHEMATIC
		POS. 1	POS. 2				
SP	YM0613	OFF	ON	Position 1		90°	
	YM061U			Positions 1 & 2			
<b>SPST</b>							
<div><div><p>Top view of the switch showing POS. 1 and POS. 2 positions.</p></div><div><p>Side view of the switch with dimensions: 2.458 (62, 43), 1.336 (33, 93), .202 (5, 13), .485 (12, 32), .592 DIA (15, 04 ø), .270 TYP (6, 86).</p></div><div><p>Bottom view of the switch with dimensions: .415 (10, 54), .110 x .032 (2, 79) x (0, 79) TYP.</p></div><div><p>M12 x 1.25 6g THD. (MOUNTING NUT INCLUDED)</p></div></div> <div>Part number shown: YM0613C205NQ</div>							

All models with all options when ordered with 'Q' contact material.

#### LEGEND

- = Detent Positions (90°)
- ⊙ = Key pull possible in these positions
- ⊙ = Stop Positions

### KEYING

**2** TWO NICKEL PLATED BRASS KEYS

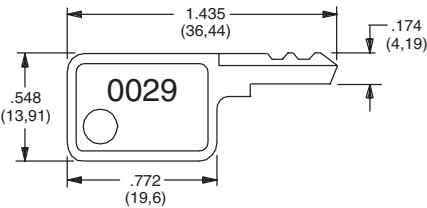

Key part number: 119091029

**NOTE:** All orders keyed alike with code number on key. For more than one key code, replacement keys, or other special features, consult Customer Service Center.

### LOCK TYPE

**C** 4 TUMBLER SINGLE BITTED LOCK WITH DETENT

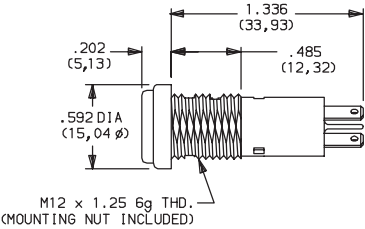

### LOCK FINISH

**2** STAINLESS STEEL FACING

**8** GLOSS BLACK FACING

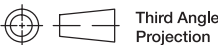

Third Angle  
Projection

Dimensions are shown: Inch (mm)  
Specifications and dimensions subject to change



# YM Series 4 Tumbler Miniature Switchlocks

## TERMINATIONS

05 QUICK CONNECT

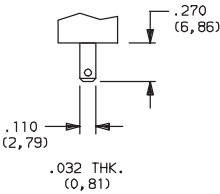

WC WIRE LEAD

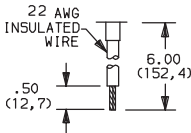

Black wire standard, other colors and lengths available, consult Customer Service Center. UL style 1015.

## MOUNTING STYLE

N WITH NUT

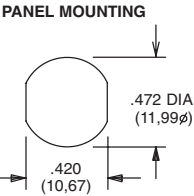
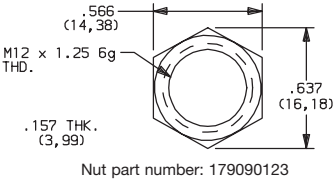

Panel thickness:  
.300 (7, 62) max.

## CONTACT MATERIAL

OPTION CODE	RoHS COMPLIANT*	RoHS COMPATIBLE*	CONTACT AND TERMINAL MATERIAL	RATING	
Q	YES	YES	SILVER <sup>2</sup>	POWER	4 AMPS @ 125 V AC or 28 V DC; 2 AMPS @ 250 AC V AC (UL/CSA).
B	YES	YES	GOLD <sup>1</sup>	LOW LEVEL/DRY CIRCUIT	0.4 VA MAX. @ 20 V AC or DC MAX.

\* Note: See Technical Data section of this catalog for RoHS compliant and compatible definitions and specifications.

- <sup>1</sup> CONTACTS & TERMINALS: Copper, with gold plate over nickel plate.  
<sup>2</sup> CONTACTS & TERMINALS: Copper, silver plated (standard with all termination options).

All models **CRL** with all options when ordered with 'Q' contact material.

## AVAILABLE HARDWARE



Key Code: 0029  
**PART NO.** (ONE KEY)  
**960B10029**

**Material:** Brass  
**Finish:** Nickel plate



Third Angle Projection

Dimensions are shown: Inch (mm)  
 Specifications and dimensions subject to change

Switchlock