

Extrusion

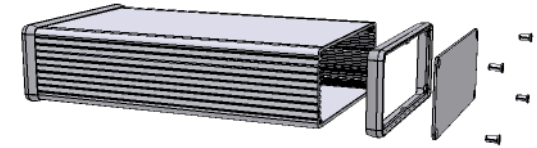

EXTRUSION DESIGNED FOR 120MM WIDE PC BOARD

Slot Details

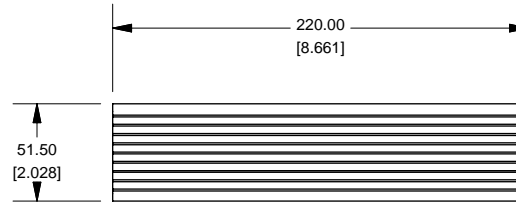
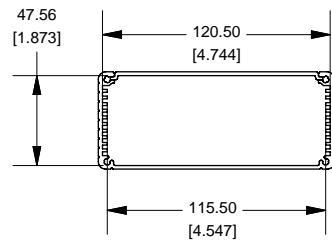
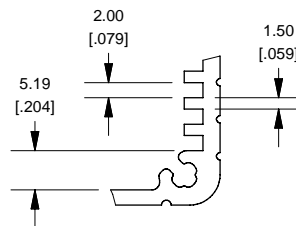

End Plate

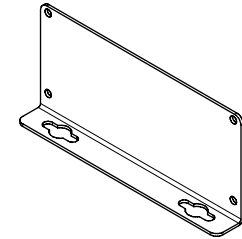
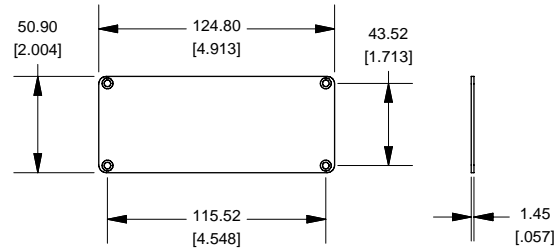

**OPTIONAL FLANGE END PANEL
1455QF**

Open Bezel

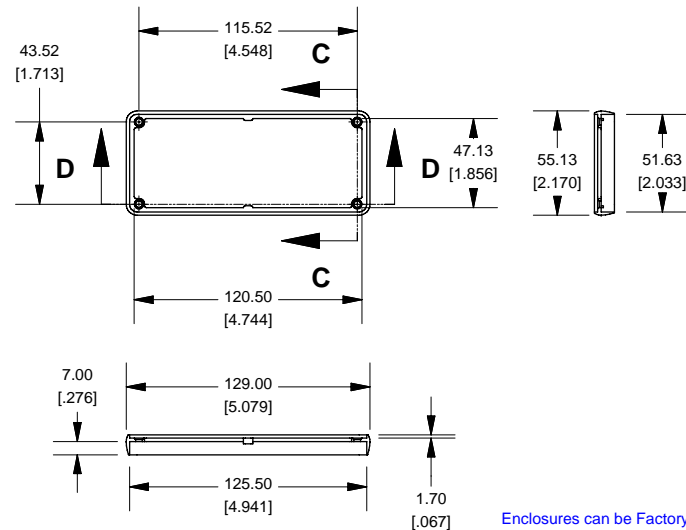

NOTE

Purchased assembly includes box, plastic bezels, end panels, #6 Taptight screws and self adhesive rubber feet.
Box made from Extruded Aluminum 6063.
Bezels made with polycarbonate.

1455Q2201

PART NUMBERS

Clear Anodized	1455Q2201
Black Anodized	1455Q2201BK

ACCESSORIES

See website for accessories.



Enclosures can be Factory Modified (Milling, Drilling, Printing etc.)
Solid models of this enclosure available in STEP or IGES.
Contact Factory mjm@hammondmfg.com

Mouser Electronics

Authorized Distributor

Click to View Pricing, Inventory, Delivery & Lifecycle Information:

[Hammond:](#)

[1455Q2201](#) [1455Q2201BK](#)