

Type: **P1-32/V/SVB**  
Article No.: **095676**



### Ordering information

|  |                      |     |  |
|--|----------------------|-----|--|
| Design   |                      |     | Rear mounting  |
| Description  |                      |     | Without auxiliary contacts   |
| Main conducting paths No. of poles   |                      | M   | 3  |
| Auxiliary contacts   |                      | N/O | 0  |
| Auxiliary contacts   |                      | B   | 0  |
| Max. three-phase motor rating (per set of 3 contacts) 50–60 Hz AC–3 400/415 V 50–60 Hz | <i>P</i>             | kW  | 15   |
| Rated uninterrupted current  | <i>I<sub>u</sub></i> | A   | 32   |
| Note for table header  |                      |     | According to IEC/EN 60204–1, VDE 0113 Part 1; with red rotary handle and yellow locking collar, lockable in 0 position |

### Contact sequence

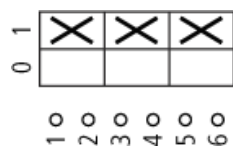

### General

|           |  |  |  |
|-----------|--|--|--|
| Standards |  |  | IEC/EN 60 947, VDE 0660, IEC/EN 60 204, CSA,UL |
|-----------|--|--|--|

|   |              |               |  |
|---|--------------|---------------|--|
|   |              |               | Switch-disconnectors to IEC/EN 60 947-3<br>NEMA3R, NEMA12                      |
| Lifespan, mechanical                                  | Operations   | $\times 10^6$ | 0,3  |
| Maximum operating frequency                           | Operations/h |               | 50   |
| Climatic proofing                                     |              |               | Damp heat, constant, to IEC 60068-2-78; Damp heat, cyclical, to IEC 60068-2-30 |
| Ambient temperature                                   |              |               |  |
| Open  |              | °C            | --25/50  |
| Enclosed  |              | °C            | --25/40  |
| Mounting position                                     |              |               | As required  |
| Documentation   |              |               | Main catalogue HPL   |
| Mechanical shock resistance<br>(shock duration 20 ms) |              | g             | > 15   |

### Contacts

|  |           |              |       |
|--|-----------|--------------|-------|
| Rated operational voltage                                  | $U_e$     | V AC         | 690   |
| Rated impulse withstand voltage                            | $U_{imp}$ | V AC         | 6000  |
| Overvoltage category/pollution degree                      |           |              | III/3 |
| Rated uninterrupted current                                |           |              |       |
| open   | $I_u$     | A            | 25    |
| Enclosed   | $I_u$     | A            | 25    |
| Load-carrying capacity in intermittent operation, Class 12 |           |              |       |
| AB 25 % DF   |           | $\times I_e$ | 2     |
| AB 40 % DF   |           | $\times I_e$ | 1,6   |
| AB 60 % DF   |           | $\times I_e$ | 1,3   |
| Short-circuit rating                                       |           |              |       |
| Fuse   |           | A gG/gL      | 25    |
| Rated short-time withstand current (1 s current)           | $I_{cw}$  | $A_{rms}$    | 640   |
| Switching angles   |           | °            | 90    |
| Current heat loss per contact at $I_e$                     |           | W            | 1,1   |

### Terminal capacities

|                                    |  |                 |                                |
|------------------------------------|--|-----------------|--------------------------------|
| Solid or stranded                  |  | mm <sup>2</sup> | 1 × (1.5 – 6)<br>2 × (1.5 – 6) |
| Flexible with ferrule to DIN 46228 |  | mm <sup>2</sup> | 1 × (1 – 4)<br>2 × (1 – 4)     |
| Terminal screw                     |  |                 | M4                             |
| Tightening torque                  |  | Nm              | 1.6                            |

| Switching capacity  |       |          |     |
|---|-------|----------|-----|
| AC  |       |          |     |
| Rated making capacity $\cos \phi = 0.35$                        |       | A        | 240 |
| Rated breaking capacity, motor load switch $\cos \phi = 0.35$   |       |          |     |
| 230 V   |       | A        | 190 |
| 400 V   |       | A        | 150 |
| 500 V   |       | A        | 170 |
| 690 V   |       | A        | 150 |
| Rated operational current 440 V load-break switch AC-21A        | $I_e$ | A        | 25  |
| AC-3 motor load switch motor rating                             |       |          |     |
| 230 V   | $P$   | kW       | 5,5 |
| 400 V   | $P$   | kW       | 7,5 |
| 500 V   | $P$   | kW       | 7,5 |
| 690 V   | $P$   | kW       | 7,5 |
| AC-23A Motor load switches (main switches maintenance switches) |       |          |     |
| 230 V   | $P$   | kW       | 7   |
| 400 V   | $P$   | kW       | 13  |
| 500 V   | $P$   | kW       | 11  |
| 690 V   | $P$   | kW       | 11  |
| DC  |       |          |     |
| DC-1, Load-break switches L/R = 1 ms                            |       |          |     |
| Rated operational current                                       | $I_e$ | A        | 25  |
| Voltage per contact pair in series                              |       | V        | 60  |
| DC-23A, Motor load switches L/R = 15 ms                         |       |          |     |
| 24 V  |       |          |     |
| Rated operational current                                       | $I_e$ | A        | 25  |
| Contacts  |       | Quantity | 1   |
| 48 V  |       |          |     |
| Rated operational current                                       | $I_e$ | A        | 25  |
| Contacts  |       | Quantity | 2   |
| 60 V  |       |          |     |
| Rated operational current                                       | $I_e$ | A        | 25  |
| Contacts  |       | Quantity | 3   |

|                           |       |          |    |
|---------------------------|-------|----------|----|
| 120 V                     |       |          |    |
| Rated operational current | $I_e$ | A        | 12 |
| Contacts                  |       | Quantity | 3  |

#### Notes

|  |  |  |  |
|--|--|--|--|
|  |  |  | <p>Main switch characteristics to IEC/EN 60204; positive opening of contacts, operator element positively located on shaft</p> <p>The rated uninterrupted current <math>I_u</math> is stated at max. connected cross-section.</p> <p>For terminal capacity solid, stranded and flexible:<br/>Max. 2 cross-section sizes difference admissible when using 2 conductors.</p> |
|--|--|--|--|

#### Dimensions

|             |  |  |  |
|-------------|--|--|--|
|             |  |  | Shaft can be extended using ZVV-... + ZAV-..., max. $F 4 \times 25 = 100 \text{ mm}$   |
|             |  |  | Diameter of drilled hole Bottom  |
|             |  |  | Diameter of drilled hole Door  |
|             |  |  | 3 Padlocks   |
| Explanation |  |  | <p>For utilisation category AC-4 (extreme load: 100 % inching, reversing or plugging)</p> <p>The blocked rotor current of the motor should not exceed the rated current of the switch for AC-21A to ensure a reasonable device lifespan.</p> |

#### Dimensions

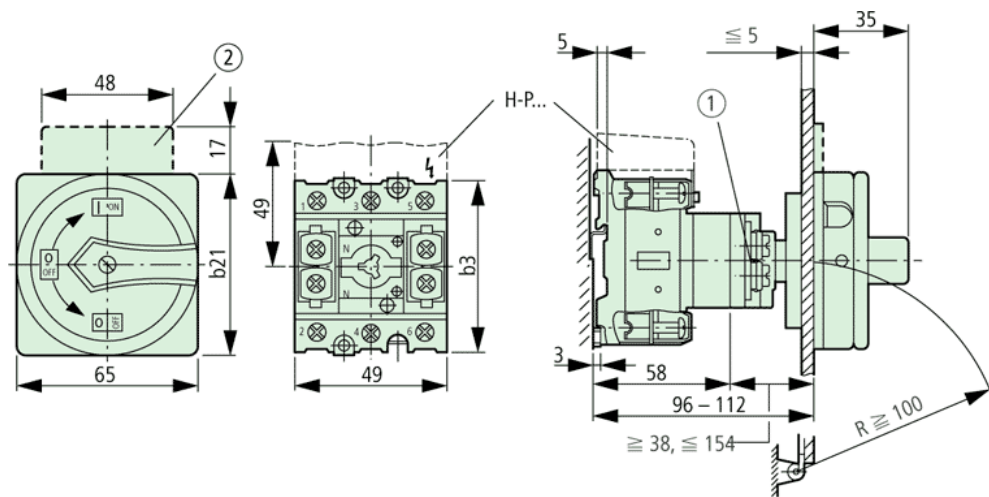

## Dimensions

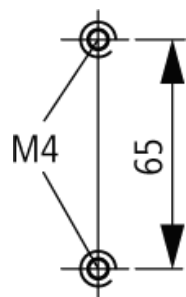

## Dimensions

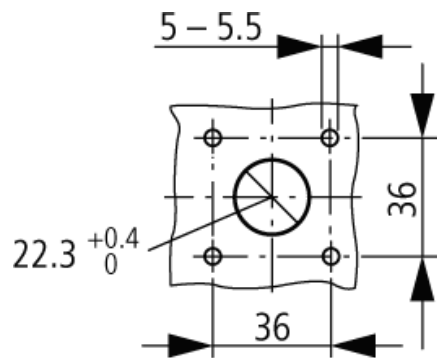

## Dimensions

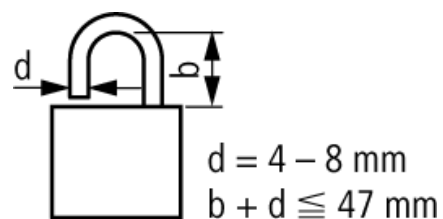

## Characteristic curve

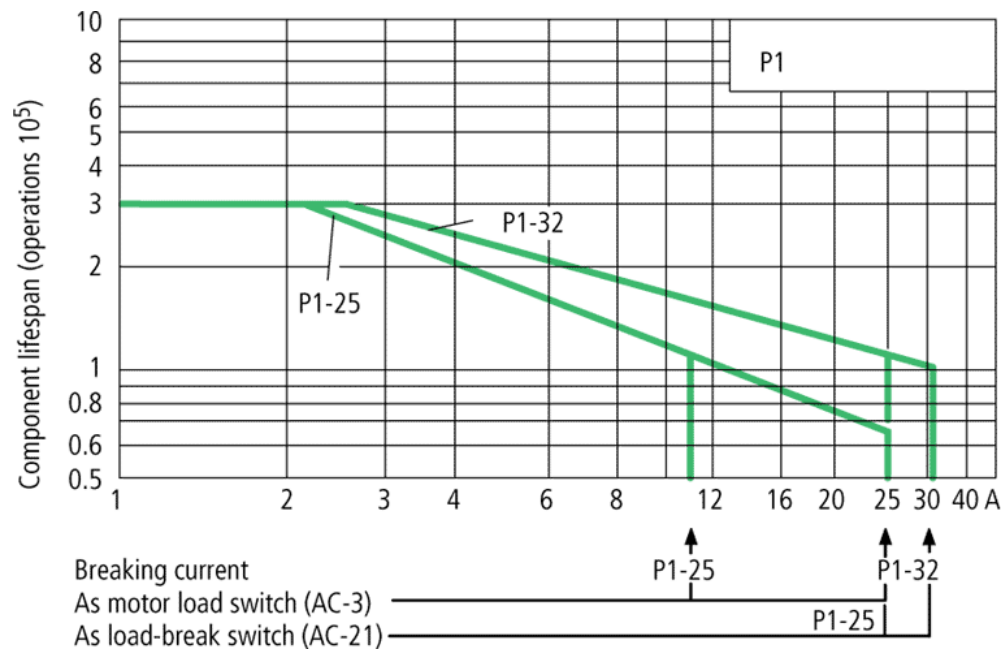

Moeller GmbH, Hein-Moeller-Str. 7-11, D-53115 Bonn  
 E-Mail: [catalog@moeller.net](mailto:catalog@moeller.net), Internet: [www.moeller.net](http://www.moeller.net), <http://catalog.moeller.net>  
 Copyright 2006 by Moeller GmbH. Subject to modifications. HPL-C2006GB-INT V2.3