

MECHANICAL PARTS

TL-65 1/4 Turn Fastener Wing Head



Characteristic

Vibration absorbing tightening fastener by its spring effect.
Butterfly nut is attached for easy operation.

Application

Measuring instruments /
Distribution panels /
Machine tools

Specification

Other than the eyelet for screw fastener TL-192, the eyelet for T-shaped sign fastener is usable. As a caulking tool, use the modified fool for T-shaped sign fastener. Refer to the T-shaped sign fastener for installation instruction.

Model No.	Name (Component)	Net Weight (g)	Code No.
TL-65	Screw Fastener with Butterfly Nut	7.0	1134
TL-261	Spring	2.0	1137
TL-65-001	TL-65, TL-261	9.0	1808

Parts List

No.	Model No.	Part Name	Material	Finish	Quantity
1	TL-65	Grip Screw	SPCC	Cr	1
2	TL-65	Screw Fastener TL-66	HSK16M		1
—	TL-261	Spring	SWP	Zn	1

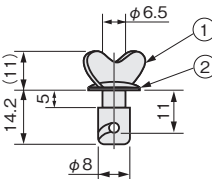
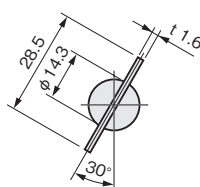

Installation Example

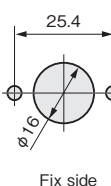
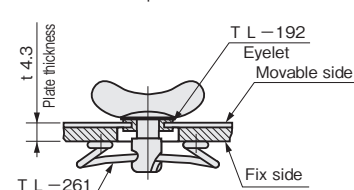

※Screw retainer, TM-137-1 (sold separately) can be used as an eyelet.

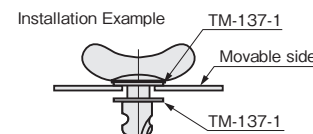

Layout of Holes for Installation

TL-66 1/4 Turn Fastener Oval slotted TL-261 1/4 Turn Fastener Spring



Characteristic

Vibration absorbing and tightening fastener by its spring effect.
Small bulge on the surface, and its tightening force is strong.

Application

Measuring instruments /
Distribution panels /
Machine tools

Specification

- Other than the eyelet for screw fastener TL-192, The eyelet for T-shaped sign fastener is usable. As a caulking tool, use the modified tool for T-shaped sign fastener.
- Refer to the T-shaped sign fastener for installation instruction.

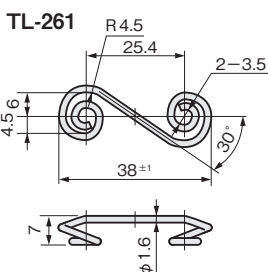
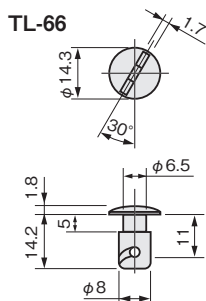

Installation Example

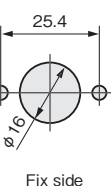
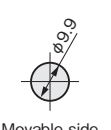
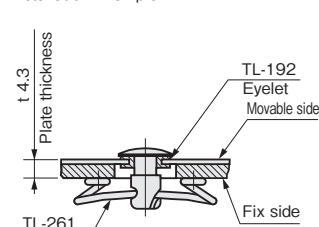

※Screw retainer, TM-137-1 (sold separately) can be used as an eyelet.

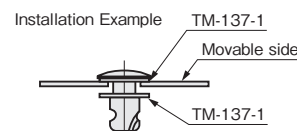

Layout of Holes for Installation