

Data sheet

Standard Thermocouple Socket with Stainless Steel mounting bracket

Types K, J, T, E, N, R/S & B
(IEC Colour Code)



- Standard size in-line Thermocouple Socket with stainless steel panel mounting bracket
- Suitable with RS range of aluminium faceplates (see accessories below)
- Intended for use in more industrial processes but can be used in all applications as desired
- Available in Thermocouple types K, J, T, E, N, R/S, B & Copper
- For Types K, J, T, E & N contacts are made from true Thermocouple alloys
- R/S type has compensating copper/copper nickel alloy contacts (for R or S Type Thermocouples)
- B type has compensating copper/copper contacts (for B Type Thermocouples)
- Colour coded in accordance with IEC specification
- Maximum continuous operating temperature 220 deg°C

T/C Type	Colour Code (IEC)	+Positive Contact (alloy type)	-Negative Contact (alloy type)	RS order Code
K	Green	+Nickel Chromium	-Nickel Alloy	456-0102
J	Black	+Iron	-Copper Nickel	456-0089
T	Brown	+Copper	-Copper Nickel	774-7305
E	Violet	+Nickel Chromium	-Copper Nickel	774-7298
N	Pink	+Nickel/Chro/Silicon	-Nickel Silicon	774-7292
R/S	Orange	+Copper	-Copper Alloy	774-7302
B	Grey	+Copper	-Copper	774-7295

Data sheet

Standard Thermocouple Socket with Stainless Steel mounting bracket

Types K, J, T, E, N, R/S & B
(IEC Colour Code)

Schematic Drawing

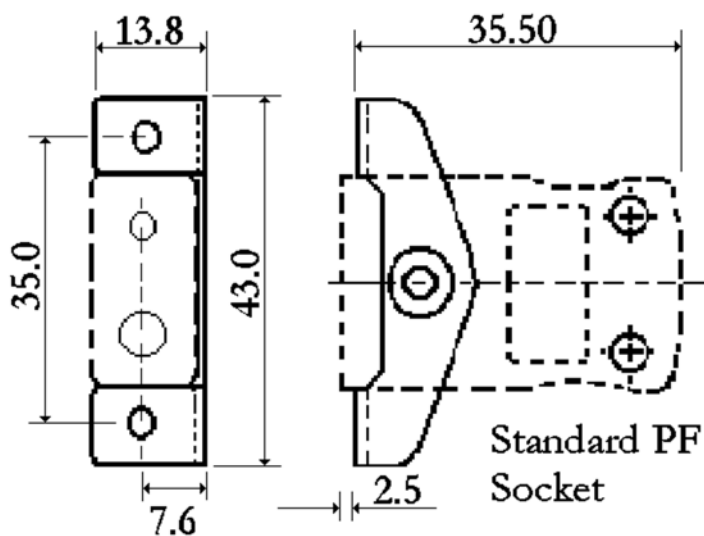

Accessories

– Aluminium Faceplates in 4 different sizes:

2 way	RS part: 611-8236
4 way	RS part: 611-8258 (shown below)
6 way	RS part: 611-8270
12 way	RS part: 611-8242

