

1.8mm Round Subminiature "Z-Bend" Lead (Square Base) LEDs

PART NO.: 95-21UYOC/S530-A2/TR10

■ Features :

- Package in 12mm tape on 7" diameter reels.
- Compatible with automatic placement equipment.
- Compatible with infrared and vapor phase reflow solder process.
- IC compatible.
- EIA std package.
- Mono-color type.

■ Descriptions :

- Besides, light weight makes them ideal for miniature application, ect.
- Furthermore by automation assembly machines the accuracy is anticipated.

■ Applications :

- Small indicator for outdoor applications.
- Flat backlight for LCD, switches and symbols.
- Indicator and backlight in office equipment.
- Indicator and backlight for battery driven equipment.
- Indicator and backlight for audio and video equipment.
- Automotive : backlighting in dashboards and switches.
- Telecommunication : indicator and backlighting in telephone and fax.
- General use.

Package Dimensions :

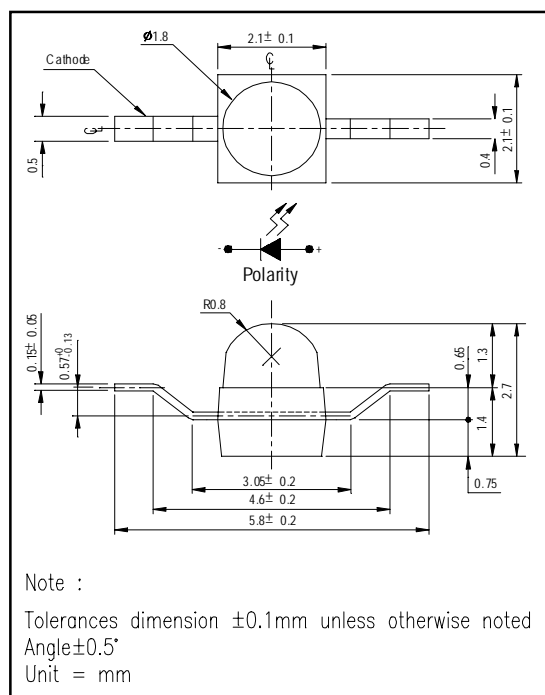

| PART NO. | Chip | | Lens Color |
|------------------------|----------|---------------------|-------------|
| | Material | Emitted Color | |
| 95-21UYOC/S530-A2/TR10 | AlGaInP | Super Yellow Orange | Water Clear |

OFFICE : NO. 25,Lane 76,Sec.3, Chung Yang Rd., Tucheng 236, Taipei, Taiwan, R.O.C.

TEL : 886-2-2267-2000,2267-9936

FAX : 886-2-2267-6244,22676189,22676306

<http://www.everlight.com>



ECN : _____ PAGE : 2/5

PART NO.: 95-21UYOC/S530-A2/TR10

Technical drawing of a circular mechanical part, showing a top view and a side view.

Top View Dimensions:

- Central hole diameter: $\varnothing 13 \pm 0.5$
- Outer diameter: $\varnothing 178.0 \pm 1$
- Spoke thickness: 2.5 ± 0.5
- Spoke width: 5.0 ± 0.5

Side View Dimensions:

- Overall thickness: 16.0 ± 0.5
- Inner flange thickness: 13.2 ± 1.5

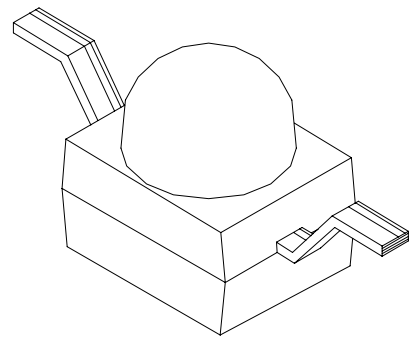

Technical drawing of a microstrip antenna array. The drawing includes three views: a top view, a side view, and a feed view.

Top View Dimensions:

- Overall width: 12.0 ± 0.3
- Overall length: 5.5 ± 0.05
- Distance between feed holes: 4.0 ± 0.1
- Distance from feed hole to antenna element: 2.0 ± 0.05
- Distance between antenna elements: 4.0 ± 0.1
- Distance from antenna element to top tape: 1.75 ± 0.1
- Distance from feed hole to top tape: 1.55 ± 0.05

Side View Dimensions:

- Overall height: 3.05 ± 0.1
- Distance from top tape to antenna element: 0.3

Feed View Dimensions:

- Distance between feed holes: 4.0 ± 0.1
- Feed direction is indicated by an arrow labeled "FEED DIRECTION".

Labels:

- ANODE LEAD
- TOP TAPE
- PUSH PIN THROUGH HOLE

1. All dimensions are in millimeters .
2. Lead spacing is measured where the leads emerge from the package.
3. Protruded resin under flange 1.5 mm (0.59") max.



1.8mm Round Subminiature "Z-Bend" Lead (Square Base) LEDs

PART NO. : 95-21UYOC/S530-A2/TR10

■ Absolute Maximum Ratings at Ta = 25°C

| Parameter | Symbol | Rating | Unit |
|---|----------|----------------------|------|
| Reverse Voltage | VR | 5 | V |
| Forward Current | IF | 25 | mA |
| Operating Temperature | Topr | -40 ~ +85 | °C |
| Storage Temperature | Tstg | -40 ~ +100 | °C |
| Soldering Temperature | Tsol | 260 ± 5 for 5 sec | °C |
| Electrostatic Discharge | ESD | 2000 | V |
| Power Dissipation | Pd | 60 | mW |
| Peak Forward Current(Duty 1/10 @ 1KHz) | IF(Peak) | 160 | mA |

■ Electronic Optical Characteristics :

| Parameter | Symbol | MIN. | TYP. | MAX. | Unit | Condition |
|---------------------------------|---------|------|------|------|------|-----------|
| Luminous Intensity | Iv | ---- | 30 | ---- | mcd | IF = 2mA |
| Luminous Intensity | Iv | 198 | 496 | ---- | mcd | IF = 20mA |
| Viewing Angle | 2 θ 1/2 | ---- | 25 | ---- | deg | |
| Peak Wavelength | λ p | ---- | 611 | ---- | nm | |
| Dominant Wavelength | λ d | ---- | 605 | ---- | nm | |
| Spectrum Radiation Bandwidth | △ λ | ---- | 17 | ---- | nm | |
| Forward Voltage | VF | ---- | 2.0 | 2.4 | V | VR=5V |
| Reverse Current | IR | ---- | ---- | 10 | μ A | |



1.8mm Round Subminiature "Z-Bend" Lead (Square Base) LEDs

PART NO. : 95-21UYOC/S530-A2/TR10

■ Typical Electro-Optical Characteristic Curves

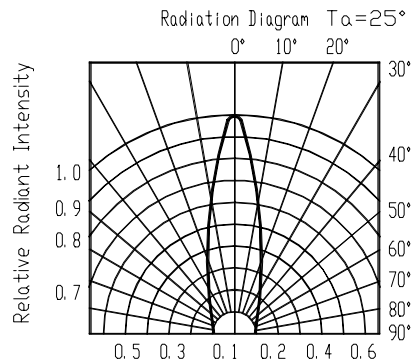
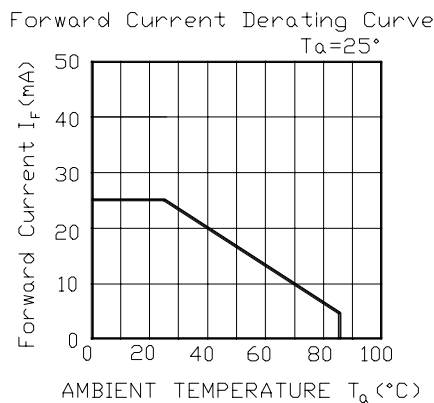
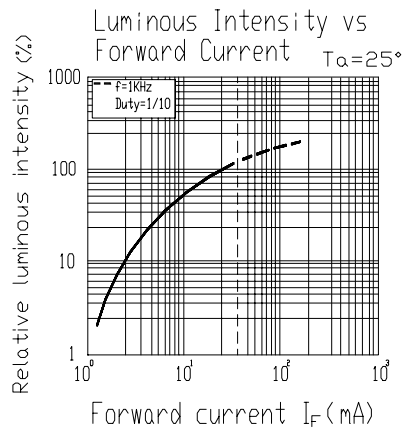
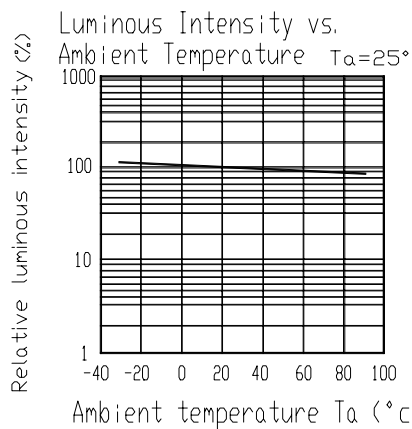
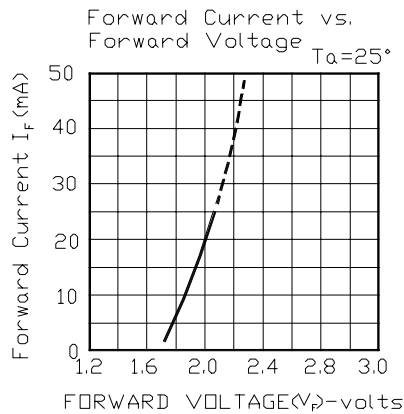
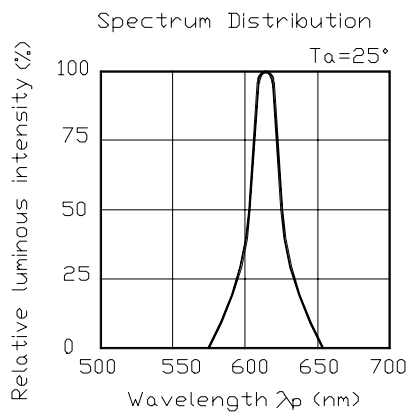



EVERLIGHT ELECTRONICS CO.,LTD.

DEVICE NUMBER : DLE-952-197 REV : 1.1

ECN : PAGE : 5/5

1.8mm Round Subminiature "Z-Bend" Lead (Square Base) LEDs

PART NO. : 95-21UYOC/S530-A2/TR10

■ Reliability Test Items And Conditions

| NO. | Item | Test Conditions | Test Hours/ Cycle | Sample Size | Ac/Re |
|-----|----------------------------------|---|----------------------|----------------|-------|
| 1 | Solder Heat | TEMP. : 260°C ± 5 °C | 5 SEC. | 76 PCS | 0/1 |
| 2 | Temperature Cycle | H : +85°C 30 min. ∫ 5 min. L : -55°C 30 min. | 50 CYCLES | 76 PCS | 0/1 |
| 3 | Thermal Shock | H : +100°C 5 min. ∫ 10 sec. L : -10°C 30 min. | 50 CYCLES | 76 PCS | 0/1 |
| 4 | High Temperature Storage | TEMP. : +100°C | 1000 HRS | 76 PCS | 0/1 |
| 5 | Low Temperature Storage | TEMP. : -55°C | 1000 HRS | 76 PCS | 0/1 |
| 6 | DC Operating Life | If = 20 mA | 1000 HRS | 76 PCS | 0/1 |
| 7 | High Temperature / High Humidity | 85°C / 85% R H | 1000 HRS | 76 PCS | 0/1 |